

COUNTY COUNCIL OF BEAUFORT COUNTY  
 ADMINISTRATION BUILDING  
 BEAUFORT COUNTY GOVERNMENT ROBERT SMALLS COMPLEX  
 100 RIBAUT ROAD  
 POST OFFICE DRAWER 1228  
 BEAUFORT, SOUTH CAROLINA 29901-1228  
 TELEPHONE: (843) 255-2000  
 FAX: (843) 255-9401  
 www.bcgov.net

D. PAUL SOMMERVILLE  
 CHAIRMAN

GERALD W. STEWART  
 VICE CHAIRMAN

COUNCIL MEMBERS

CYNTHIA M. BENSCH  
 RICK CAPORALE  
 GERALD DAWSON  
 BRIAN E. FLEWELLING  
 STEVEN G. FOBES  
 ALICE G. HOWARD  
 WILLIAM L. MCBRIDE  
 STEWART H. RODMAN  
 ROBERTS "TABOR" VAUX

GARY T. KUBIC  
 COUNTY ADMINISTRATOR

JOSHUA A. GRUBER  
 DEPUTY COUNTY ADMINISTRATOR  
 SPECIAL COUNSEL

THOMAS J. KEAVENY, II  
 COUNTY ATTORNEY

ASHLEY M. BENNETT  
 CLERK TO COUNCIL

AGENDA  
 COUNTY COUNCIL OF BEAUFORT COUNTY  
 REGULAR SESSION

Monday, November 14, 2016

6:00 p.m.

Large Meeting Room, Hilton Head Island Branch Library  
 11 Beach City Road, Hilton Head Island

Citizens may participate telephonically in the public comments and public hearings segments from the Hilton Head Island Branch Library as well as Mary Field School, Daufuskie Island.

1. CALL TO ORDER - 6:00 P.M.
2. REGULAR SESSION
3. PLEDGE OF ALLEGIANCE
4. INVOCATION – Council Member William McBride
5. INTRODUCTION
  - A. Mrs. Carizma Brown, Communications Coordinator
6. PROCLAMATION
  - A. Small Business Saturday
7. BOARD AND COMMISSION MEMBERS’ PUBLIC SERVICE RECOGNITION
  - A. Selena Brown, Rural and Critical Lands Preservation Board
  - B. Joyce Hall, Children’s Foster Care Review Board
  - C. Timothy Kilty, Lowcountry Regional Transportation Authority
  - D. Andy Miller, Southern Beaufort County Corridor Beautification Board
  - E. Ed Pappas, Rural and Critical Lands Preservation Board
  - F. W. Edward Riley, Planning Commission
  - G. Robert Rogers, Bluffton Township Fire District Board
  - H. James Tiller, Design Review Board
  - I. James Vineburgh, Zoning Board of Appeals
  - J. Doris Williams, Children’s Foster Care Review Board



8. ANNOUNCEMENTS

A. CERTIFICATE OF ACHIEVEMENT / EXCELLENCE IN E-RECORDING / REGISTER OF DEEDS

B. HILTON HEAD ISLAND GULLAH CELEBRATION

1. Ms. Courtney Young, Native Island Business and Community Affairs Association

9. ADMINISTRATIVE CONSENT AGENDA

A. Approval of Minutes

1. October 24, 2016 caucus and October 24, 2016 regular session

B. Committee Reports (next meeting)

1. Community Services (November 28 at 3:00 p.m., ECR)
  - a. Minutes – November 7, 2016
  - b. Minutes – October 24, 2016
2. Executive (December 12 at 3:00 p.m., ECR)
3. Finance (December 5 at 2:00 p.m., ECR)
  - a. Minutes – October 24, 2016
4. Governmental (December 5 at 4:00 p.m., ECR)
  - a. Minutes – November 7, 2016
5. Natural Resources (November 21 at 2:00 p.m., ECR)
  - a. Minutes – October 17, 2016
6. Public Facilities (November 21 at 4:00 p.m., ECR)

10. PUBLIC COMMENT – Speaker sign-up encouraged no later than 5:45 p.m. day of meeting.

11. CONSENT AGENDA

A. STATE (2%) ACCOMMODATIONS TAX BOARD FISCAL YEAR 2017 GRANT RECOMMENDATIONS TO TOURISM-RELATED ORGANIZATIONS IN THE CUMULATIVE AMOUNT OF \$550,000 (backup)

1. Consideration of approval to occur November 14, 2016
2. Finance Committee discussion and recommendation to award the 2017 grants occurred November 7, 2016 / Vote 7:0

B. CONTRACT AWARD / RUNWAY 21 EXTENSION AND TAXIWAY F INFIELD DRAINAGE IMPROVEMENTS (backup)

1. Contract awards: Quality Enterprises USA, Inc., Chesapeake, Virginia  
Talbert, Bright and Ellington, Charlotte, North Carolina  
(Construction Administration, Quality Control, Resident Project Representative, 18-B As-Built-Survey)
2. Contract amount: \$11,427,924 (\$10,364,389 and \$1,063,605)
3. Funding sources: 90% via FAA Grant 39, 5% SCAC Grant (pending), 5% via Hilton Head Island Airport Capital Projects Fund
4. Finance Committee discussion and recommendation to award contract occurred November 7, 2016 / Vote 7:0

- C. A RESOLUTION OF BEAUFORT COUNTY, SOUTH CAROLINA ADOPTING A CLASSIFICATION STRUCTURE THAT UTILIZES THE DECISION BAND™ METHOD TO EVALUATE POSITIONS ([backup](#))
  - 1. Consideration of adoption to occur November 14, 2016
  - 2. Finance Committee discussion and recommendation to adopt resolution occurred November 7, 2016 / Vote 7:0
  
- D. A RESOLUTION REQUESTING THAT THE PRESIDENT OF THE UNITED STATES OF AMERICA GIVE FAVORABLE CONSIDERATION OF ESTABLISHING A NATIONAL MONUMENT IN BEAUFORT COUNTY, SOUTH CAROLINA TO REMEMBER THE RECONSTRUCTION ERA ([backup](#))
  - 1. Consideration of adoption to occur November 14, 2016
  - 2. Community Services Committee discussion and recommendation to adopt resolution occurred November 7, 2016 / Vote 6:0
  
- E. ALLOCATION OF \$140,000 / APPROPRIATIONS ACT OF FY 2016-2017: PROVISIO 50.13 LOCAL ECONOMIC DEVELOPMENT ALLIANCES FUNDS ([backup](#))
  - 1. Consideration of using the \$140,000 allocated for Beaufort County in the Appropriations Act 2016-2017: Provisio 50.13 budget Local Economic Development Alliances Funds for economic development in furtherance of the Beaufort Digital Corridor or the Don Ryan Center for Innovation incentives.
  - 2. Governmental Committee discussion and recommendation to approve allocation occurred November 7, 2016 / Vote7:1

## 12. PUBLIC HEARING

- A. AN ORDINANCE OF BEAUFORT COUNTY COUNCIL UPDATING THE BEAUFORT COUNTY SMOKING ORDINANCE ([backup](#))
  - 1. Consideration of third and final reading to occur November 14, 2016
  - 2. Second reading approval occurred October 24, 2016 / Vote 10:1
  - 3. First reading approval occurred October 12, 2016 / Vote 8:0
  - 4. Community Services Committee discussion and recommendation to approve ordinance on first reading occurred September 26, 2016 / Vote 5:0
  - 5. Community Services Committee discussion occurred August 22, 2016
  - 6. Community Services Committee discussion occurred June 27, 2016
  - 7. Community Services Committee discussion occurred March 28, 2016

## 13. MATTERS ARISING OUT OF EXECUTIVE SESSION

14. PUBLIC COMMENT - Speaker sign-up encouraged.

## 15. ADJOURNMENT

Official Proceedings  
County Council of Beaufort County  
October 24, 2016

The electronic and print media duly notified in  
accordance with the State Freedom of Information Act.

A caucus of the County Council of Beaufort County was held Monday, October 24, 2016 beginning at 5:00 p.m. in the Executive Conference Room of the Administration Building, Beaufort County Government Robert Smalls Complex, 100 Ribaut Road, Beaufort, South Carolina.

**ATTENDANCE**

Chairman D. Paul Sommerville, Vice Chairman Gerald Stewart and Councilmen Cynthia Bensch, Rick Caporale, Gerald Dawson, Brian Flewelling, Steven Fobes, Alice Howard, William McBride, Stewart Rodman and Roberts "Tabor" Vaux.

**PLEDGE OF ALLEGIANCE**

The Chairman led those present in the Pledge of Allegiance.

**CALL FOR EXECUTIVE SESSION**

It was moved by Mr. Rodman, seconded by Mr. Fobes, that Council go immediately into executive session for receipt of legal advice for pending or threatened claims. The vote: YEAS – Mrs. Bensch, Mr. Caporale, Mr. Dawson, Mr. Flewelling, Mr. Fobes, Mrs. Howard, Mr. McBride, Mr. Rodman, Mr. Sommerville, Mr. Stewart and Mr. Vaux. The motion passed.

**EXECUTIVE SESSION**

**ADJOURNMENT**

Council adjourned at 6:00 p.m.

COUNTY COUNCIL OF BEAUFORT COUNTY

By: \_\_\_\_\_  
D. Paul Sommerville, Chairman

ATTEST:

\_\_\_\_\_  
Ashley M. Bennett, Clerk to Council

Ratified:

Official Proceedings  
County Council of Beaufort County  
October 24, 2016

The electronic and print media duly notified in accordance with the State Freedom of Information Act.

The regular session of the County Council of Beaufort County was held Monday, October 24, 2016 beginning at 6:00 p.m. in Council Chambers of the Administration Building, Beaufort County Government Robert Smalls Complex, 100 Ribaut Road, Beaufort, South Carolina.

**ATTENDANCE**

Chairman D. Paul Sommerville, Vice Chairman Gerald Stewart and Councilmen Cynthia Bensch, Rick Caporale, Gerald Dawson, Brian Flewelling, Steven Fobes, Alice Howard, William McBride, Stewart Rodman and Roberts "Tabor" Vaux.

**PLEDGE OF ALLEGIANCE**

The Chairman led those present in the Pledge of Allegiance.

**INVOCATION**

Council member Brian Flewelling gave the Invocation.

**PROCLAMATIONS**

**Anti-Bullying Awareness Month**

The Chairman proclaimed October 2016 as Anti-Bullying Awareness Month. This declaration is intended to draw attention to the benefits of resolution and prevention of conflicts in educational environments, the importance of student education on the impacts of bullying, raising awareness and facilitating frank discussion of the dangers of bullying. Councilman Alice Howard and Mrs. Aracely Johnson, a Beaufort Elementary School classroom teacher, accepted the proclamation.

**ADMINISTRATIVE CONSENT AGENDA**

**Review of the Proceedings of the Caucus held October 12, 2016**

This item comes before Council under the Administrative Consent Agenda.

It was moved by Mr. Flewelling, seconded by Mr. Rodman, that Council approve the minutes of the caucus held October 12, 2016. The vote: YEAS – Mrs. Bensch, Mr. Caporale, Mr. Dawson, Mr. Flewelling, Mr. Fobes, Mrs. Howard, Mr. McBride, Mr. Rodman, Mr. Sommerville, Mr. Stewart and Mr. Vaux. The motion passed.

## **Review of the Proceedings of the Regular Session held October 12, 2016**

This item comes before Council under the Administrative Consent Agenda.

It was moved by Mr. Flewelling, seconded by Mr. Rodman, that Council approve the minutes of the regular session held October 12, 2016. The vote: YEAS – Mrs. Bensch, Mr. Caporale, Mr. Dawson, Mr. Flewelling, Mr. Fobes, Mrs. Howard, Mr. McBride, Mr. Rodman, Mr. Sommerville, Mr. Stewart and Mr. Vaux. The motion passed.

## **Committee Reports**

### **Finance Committee**

#### **30-Day Extension of Tax Bill Payments**

It was moved by Mr. Stewart, as Finance Committee Chairman, seconded by Mr. Flewelling, that Council adopt a resolution to authorize the County Treasurer to take all necessary action to seek approval from the South Carolina Department of Revenue for a 30-day extension from penalties delineated within South Carolina Code Ann. 12-45-180(a). The vote: YEAS – Mrs. Bensch, Mr. Caporale, Mr. Dawson, Mr. Flewelling, Mr. Fobes, Mrs. Howard, Mr. McBride, Mr. Rodman, Mr. Sommerville, Mr. Stewart and Mr. Vaux. The motion passed.

## **DELINQUENT TAX SALE 2016 REPORT**

Mrs. Maria Walls, Beaufort County Treasurer, gave an overview of the Delinquent Tax Sale, current finances, and tax collections. There were 649 parcels, totaling \$783,908 in taxes due, sent to auction, and 357 parcels sold at a total bid collection amount of \$15,682,814. That is a total overage amount of \$15,078,906. Cash on hand at present is as follows: \$66,587,813 unrestricted and \$79,072,310 restricted. The collection rate for tax year 2015 is 97.98%.

Mrs. Walls stated over the last few months, the Treasurer's Office has received numerous complaints concerning motor vehicle billings. The Auditor's Office has failed to assign the correct millage to thousands of vehicles. The Treasurer's Office performed a review through August 2016 in which 12,192 (4,615 overpaid and 6,626 underpaid) were incorrectly billed. There is \$119,172,740 in vehicle market value that is not being taxed appropriately. Revenues have been incorrectly dispersed because the revenues billed are not correct. She requested Council ask Administration to review the tax data periodically. It needs to be right for the people of this County. She asked Council to provide guidance on the taxation process.

**PUBLIC COMMENT**

The Chairman recognized Mr. Charlie Smalls, a Daufuskie Island resident, who thanked Council for all of its support over the last year. He thanked U.S. Congressman Mar, Sanford and State Senator Tom Davis for touring Daufuskie Island to see the devastation caused by Hurricane Matthew. There were more than 2,000 trees to clean up. The results of residents' clean-up efforts have been astounding. It is hopeful that FEMA responds to Daufuskie Island. A mosquito problem exists on Daufuskie Island.

**CONSENT AGENDA**

**AN ORDINANCE OF BEAUFORT COUNTY COUNCIL UPDATING THE BEAUFORT COUNTY SMOKING ORDINANCE**

This item comes before Council under the Consent Agenda. Discussion occurred at the September 26, 2016 meeting of the Community Services Committee.

It was moved by Mr. McBride, as Community Services Committee Chairman, that Council approve on second reading an ordinance of Beaufort County Council updating the Beaufort County Smoking Ordinance. The vote: YEAS – Mrs. Bensch, Mr. Caporale, Mr. Dawson, Mr. Fobes, Mrs. Howard, Mr. McBride, Mr. Rodman, Mr. Sommerville and Mr. Stewart. NAYS – Mr. Flewelling and Mr. Vaux. The motion passed.

The Chairman announced a public hearing on Monday, November 14, 2016 beginning at 6:30 p.m., in the Large Meeting Room, Hilton Head Island Branch Library, 11 Beach City Road, Hilton Head Island, South Carolina.

**A RESOLUTION REQUESTING THE GENERAL ASSEMBLY TO AMEND THE ANNEXING AUTHORITY OF MUNICIPALITIES AND PROVIDE COUNTY COUNCILS THE ABILITY TO PROTECT THEIR CITIZENS FROM LAND USE THAT MAY BE INAPPROPRIATE AND CONTRARY TO THE COMPREHENSIVE LAND USE AND TRANSPORTATION PLAN ADOPTED BY THE COUNTY**

This item comes before Council under the Consent Agenda. Discussion occurred at the October 17, 2016 meeting of the Natural Resources Committee.

**Motion to postpone:** It was moved by Mr. Rodman, seconded by Mr. Vaux, that Council postpone adoption of a resolution requesting the General Assembly to amend the annexing authority of municipalities and provide County Councils the ability to protect their citizens from land use that may be inappropriate and contrary to the Comprehensive Land Use and Transportation Plan adopted by the County until November 28, 2016, to allow the municipalities to provide input. The vote: YEAS – Mrs. Bensch, Mr. Caporale, Mr. Fobes, Mr. Rodman and Mr. Vaux. NAYS – Mr. Dawson, Mr. Flewelling, Mrs. Howard, Mr. McBride, Mr. Sommerville and Mr. Stewart. The motion failed.

**Motion to table:** It was moved by Mrs. Bensch, seconded by Mr. Caporale, that Council table adoption of a resolution requesting the General Assembly to amend the annexing authority of municipalities and provide County Councils the ability to protect their citizens from land use that may be inappropriate and contrary to the Comprehensive Land Use and Transportation Plan adopted by the County until November 28, 2016, to allow the municipalities to provide input. The vote: YEAS – Mrs. Bensch, Mr. Caporale and Mr. Vaux.. NAYS – Mr. Dawson, Mr. Flewelling, Mr. Fobes, Mrs. Howard, Mr. McBride, Mr. Rodman, Mr. Sommerville and Mr. Stewart. The motion failed.

It was moved by Mr. Flewelling, as Natural Resources Committee Chairman, no second required that Council adopt a resolution requesting the General Assembly to amend the annexing authority of municipalities and provide County Councils the ability to protect their citizens from land use that may be inappropriate and contrary to the Comprehensive Land Use and Transportation Plan adopted by the County until November 28, 2016, to allow the municipalities to provide input. The vote: YEAS – Mr. Dawson, Mr. Flewelling, Mrs. Howard, Mr. McBride, Mr. Sommerville and Mr. Stewart. NAYS - Mrs. Bensch, Mr. Caporale, Mr. Fobes, Mr. Rodman and Mr. Vaux. The motion passed.

## **PUBLIC HEARINGS**

**COMPREHENSIVE PLAN FUTURE LAND USE MAP AMENDMENT FOR FIVE PARCELS (TOTALING APPROXIMATELY 125 ACRES--R600 021 000 0002 0000, R600 021 000 004A 0000, R600 021 000 0194 0000, R600 021 000 0195 0000, AND R600 021 000 0075 0000; KNOWN AS PEPPER HALL PLANTATION LOCATED ON THE NORTH SIDE OF U.S. HIGHWAY 278 BETWEEN THE OKATIE RIVER AND GRAVES ROAD) FROM:**

- **COMMUNITY COMMERCIAL AND RURAL FOR A TOTAL OF APPROXIMATELY 33 ACRES FRONTING U.S. HIGHWAY 278 (R600 021 000 0195 0000 AND A PORTION OF R600 021 000 004A 000) TO REGIONAL COMMERCIAL, AND**
- **RURAL FOR APPROXIMATELY 92 ACRES TO NEIGHBORHOOD MIXED USE (R600 021 000 0002 0000, R600 021 000 0194 0000, R600 021 000 0075 0000, AND A PORTION OF R600 021 000 004A 0000)**



**COMPREHENSIVE SOUTHERN BEAUFORT COUNTY ZONING MAP AMENDMENT FOR FIVE PARCELS (TOTALING APPROXIMATELY 125 ACRES-- R600 021 000 0002 0000, R600 021 000 004A 0000, R600 021 000 0194 0000, R600 021 000 0195 0000, AND R600 021 000 0075 0000; KNOWN AS PEPPER HALL PLANTATION LOCATED ON THE NORTH SIDE OF U.S. HIGHWAY 278 BETWEEN THE OKATIE RIVER AND GRAVES ROAD) FROM:**

- **T2-RURAL ZONING FOR APPROXIMATELY 33 ACRES FRONTING U.S. HIGHWAY 278 (R600 021 000 0195 0000 AND A PORTION OF R600 021 000 004A 000) TO C5 REGIONAL CENTER MIXED USE, AND**
- **T2-RURAL ZONING FOR APPROXIMATELY 92 ACRES TO C3 NEIGHBORHOOD MIXED USE (R600 021 000 0002 0000, R600 021 000 0194 0000, R600 021 000 0075 0000, AND A PORTION OF R600 021 000 004A 0000)**

Due to the association of Agenda Items 10A and 10B, the Chairman declared that the two items be taken conjointly for purposes of a public hearing, discussion and action.

Mr. Vaux recused himself, left the room, and was not present for any of the discussion. His law firm formerly represented the seller in this same matter.

The Chairman opened a public hearing beginning at 6:30 p.m. for the purpose of receiving public comment on a Comprehensive Future Land Use Map Amendment for five parcels (totaling approximately 125 acres -- R600 021 000 0002 0000, R600 021 000 004A 0000, R600 021 000 0194 0000, R600 021 000 0195 0000, and R600 021 000 0075 0000; known as Pepper Hall Plantation located on the north side of U.S. Highway 278 between the Okatie River and Graves Road from: Community Commercial and Rural for a total of approximately 33 acres fronting U.S. Highway 278 (R600 021 000 0195 0000 and a portion of R600 021 000 004A 000) to Regional Commercial, and Rural for approximately 92 acres to Neighborhood Mixed Use (R600 021 000 0002 0000, R600 021 000 0194 0000, R600 021 000 0075 0000, and a portion of R600 021 000 004A 0000); and Comprehensive Southern Beaufort County Zoning Map Amendment for five parcels (totaling approximately 125 acres -- R600 021 000 0002 0000, R600 021 000 004A 0000, R600 021 000 0194 0000, R600 021 000 0195 0000, and R600 021 000 0075 0000; known as Pepper Hall Plantation located on the north side of U.S. Highway 278 between the Okatie River and Graves Road from: T2-Rural Zoning for approximately 33 acres fronting U.S. Highway 278 (R600 021 000 0195 0000 and a portion of R600 021 000 004A 000) to C5 Regional Center Mixed Use, and T2-Rural Zoning for approximately 92 acres to C3 Neighborhood Mixed Use (R600 021 000 0002 0000, R600 021 000 0194 0000, R600 021 000 0075 0000, and a portion of R600 021 000 004A 0000). After calling once for public comment, the Chairman recognized Mr. Barry Johnson, lawyer, representing the Graves Family, who thanked Council for its cooperative spirit as well as staff in answering the array of questions. At second reading, a Council member inquired about the Graves Family's position on the zoning before Council. Despite all of the work, the zoning before Council is not likely to work for the Graves Family. However, what would work is C5 on the 33 acres fronting U.S. Highway 278 and C4 on the 92 acres.

Mr. Reed Armstrong, South Coast Project Manager, S.C. Coastal Conservation League, expressed the support of the Coastal Conservation League for the Comprehensive Future Land Use Map amendment and the Comprehensive Southern Beaufort County Zoning Map Amendment before Council. This support is a reasonable compromise for the Pepper Hall Plantation property. He is pleased that the Community Development Code provided a means for this long- lasting issue. As development plans for this property come along, there are details that will require close monitoring due to the impacts on neighboring communities. These include issues such as connective streets, open space, stormwater management, and land use.

After calling twice more for public comment and receiving none, the Chairman declared the hearing closed at 6:39 p.m.

It was moved by Mr. Flewelling, as Natural Resources Chairman, no second required that Council approve on third and final reading a Comprehensive Future Land Use Map Amendment for five parcels (totaling approximately 125 acres -- R600 021 000 0002 0000, R600 021 000 004A 0000, R600 021 000 0194 0000, R600 021 000 0195 0000, and R600 021 000 0075 0000; known as Pepper Hall Plantation located on the north side of U.S. Highway 278 between the Okatie River and Graves Road from: Community Commercial and Rural for a total of approximately 33 acres fronting U.S. Highway 278 (R600 021 000 0195 0000 and a portion of R600 021 000 004A 000) to Regional Commercial, and Rural for approximately 92 acres to Neighborhood Mixed Use (R600 021 000 0002 0000, R600 021 000 0194 0000, R600 021 000 0075 0000, and a portion of R600 021 000 004A 0000). The vote: YEAS –Mr. Dawson, Mr. Flewelling, Mr. Fobes, Mrs. Howard, Mr. McBride, Mr. Rodman, Mr. Sommerville and Mr. Stewart. NAYS – Mrs. Bensch and Mr. Caporale. RECUSED – Mr. Vaux recused himself, left the room, and was not present for any of the discussion. His law firm formerly represented the seller in this same matter. The motion passed.

It was moved by Mr. Flewelling, as Natural Resources Chairman, no second required that Council approve on third and final reading a Comprehensive Southern Beaufort County Zoning Map Amendment for five parcels (totaling approximately 125 acres -- R600 021 000 0002 0000, R600 021 000 004A 0000, R600 021 000 0194 0000, R600 021 000 0195 0000, and R600 021 000 0075 0000; known as Pepper Hall Plantation located on the north side of U.S. Highway 278 between the Okatie River and Graves Road from: T2-Rural Zoning for approximately 33 acres fronting U.S. Highway 278 (R600 021 000 0195 0000 and a portion of R600 021 000 004A 000) to C5 Regional Center Mixed Use, and T2-Rural Zoning for approximately 92 acres to C3 Neighborhood Mixed Use (R600 021 000 0002 0000, R600 021 000 0194 0000, R600 021 000 0075 0000, and a portion of R600 021 000 004A 0000). The vote: YEAS –Mr. Dawson, Mr. Flewelling, Mr. Fobes, Mrs. Howard, Mr. McBride, Mr. Rodman, Mr. Sommerville and Mr. Stewart. NAYS – Mrs. Bensch and Mr. Caporale. RECUSED – Mr. Vaux recused himself, left the room, and was not present for any of the discussion. His law firm formerly represented the seller in this same matter. The motion passed.

**AN ORDINANCE AUTHORIZING THE ISSUANCE AND SALE OF GENERAL OBLIGATION BONDS, SERIES 2016B, OR SUCH OTHER APPROPRIATE SERIES DESIGNATION, OF BEAUFORT COUNTY, SOUTH CAROLINA, IN THE PRINCIPAL AMOUNT OF NOT EXCEEDING \$51,000,000; FIXING THE FORM AND DETAILS OF THE BONDS; AUTHORIZING THE COUNTY ADMINISTRATOR OR HIS LAWFULLY-AUTHORIZED DESIGNEE TO DETERMINE CERTAIN MATTERS RELATING TO THE BONDS; PROVIDING FOR THE PAYMENT OF THE BONDS AND THE DISPOSITION OF THE PROCEEDS THEREOF; AND OTHER MATTERS RELATING THERETO**

The Chairman opened a public hearing beginning at 6:47 p.m. for the purpose of receiving public comment regarding an ordinance authorizing the issuance and sale of General Obligation Bonds, series 2016B, or such other appropriate series designation, of Beaufort County, South Carolina, in the principal amount of not exceeding \$51,000,000; fixing the form and details of the bonds; authorizing the County Administrator or his lawfully-authorized designee to determine certain matters relating to the bonds; providing for the payment of the bonds and the disposition of the proceeds thereof; and other matters relating thereto. After calling three times for public comment and receiving none, the Chairman declared the hearing closed at 6:48 p.m.

It was moved by Mr. Stewart, as Chairman of the Finance Committee, no second required that Council approve on third and final reading an ordinance authorizing the issuance and sale of General Obligation Bonds, series 2016B, or such other appropriate series designation, of Beaufort County, South Carolina, in the principal amount of not exceeding \$51,000,000; fixing the form and details of the bonds; authorizing the County Administrator or his lawfully-authorized designee to determine certain matters relating to the bonds; providing for the payment of the bonds and the disposition of the proceeds thereof; and other matters relating thereto. The vote: YEAS –Mr. Caporale, Mr. Dawson, Mr. Flewelling, Mr. Fobes, Mrs. Howard, Mr. McBride, Mr. Rodman, Mr. Sommerville, Mr. Stewart and Mr. Vaux. NAYS – Mrs. Bensch. The motion passed.

**AN ORDINANCE TO AMEND SECTION 66-81, *ET SEQ.* OF THE BEAUFORT COUNTY CODE OF ORDINANCES SO AS TO RENAME THE TAX EQUALIZATION BOARD AND PROVIDE AMENDMENTS TO BOARD MEMBERSHIP**

The Chairman opened a public hearing beginning at 6:48 p.m. for the purpose of receiving public comment regarding an ordinance to amend Section 66-81, *et seq.* of the Beaufort County Code of Ordinances so as to rename the Tax Equalization Board and provide amendments to board membership. After calling three times for public comment and receiving none, the Chairman declared the hearing closed at 6:49 p.m.

It was moved by Mr. Stewart, as Chairman of the Finance Committee, that Council approve on third and final reading an ordinance to amend Section 66-81, et seq. of the Beaufort County Code of Ordinances so as to rename the Tax Equalization Board and provide amendments to board membership. The vote: YEAS – Mrs. Bensch, Mr. Caporale, Mr. Dawson, Mr. Flewelling, Mr. Fobes, Mrs. Howard, Mr. McBride, Mr. Rodman, Mr. Sommerville, Mr. Stewart and Mr. Vaux. The motion passed.

**AN ORDINANCE TO APPROPRIATE FUNDS NOT TO EXCEED \$250,000 FROM THE 3% LOCAL ACCOMMODATIONS TAX FUNDS TO THE COUNTY GENERAL FUND FOR CONSTRUCTION OF THE SPANISH MOSS TRAIL – PHASE 7**

The Chairman opened a public hearing beginning at 6:49 p.m. for the purpose of receiving public comment regarding an ordinance to appropriate funds not to exceed \$250,000 from the 3% Local Accommodations Tax Funds to the County General Fund for construction of the Spanish Moss Trail – Phase 7. After calling three times for public comment and receiving none, the Chairman declared the hearing closed at 6:50 p.m.

It was moved by Mr. Stewart, as Chairman of the Finance Committee, that Council approve on third and final reading an ordinance to appropriate funds not to exceed \$250,000 from the 3% Local Accommodations Tax Funds to the County General Fund for construction of the Spanish Moss Trail – Phase 7. The vote: YEAS – Mr. Dawson, Mr. Flewelling, Mr. Fobes, Mrs. Howard, Mr. McBride, Mr. Rodman, Mr. Sommerville, Mr. Stewart and Mr. Vaux. NAYS – Mrs. Bensch and Mr. Caporale. The motion passed.

**OFFICE OF JUSTICE PROGRAMS FY-2016 EDWARD BYRNE MEMORIAL JUSTICE GRANT (JAG) PROGRAM: LOCAL IN THE AMOUNT OF \$54,160**

The Chairman opened a public hearing beginning at 6:50 p.m. for the purpose of receiving information from the public regarding an Office of Justice Programs FY-2016 Edward Byrne Memorial Justice Grant (JAG) Program: local grant award in the amount of \$54,160. This is a 100% federally funded grant in the amount of \$54,160. It does not require a match and the grant funds will be used for the following: The objective of the 2016 JAG Grant project is for the Beaufort County Sheriff's Office Records Management System (Spillman) to interface with the SLED Fusion Center via a direct electronic state link to the South Carolina Information Exchange (SCIEEx) which is a searchable central database of participating agencies' incident reports, supplemental reports, and field interviews which enables law enforcement officers, investigators, and analysts across the state to mine and investigate criminal cases, identify and predict crime trends, and garner intelligence on potential terrorist threats and/or activities. This project will address hardware, software and license issues necessary to obtain access to an information-sharing database for South Carolina called the South Carolina Information Exchange (SCIEEx). After calling three times for public comment and receiving none, the Chairman declared the hearing closed at 6:51 p.m.

**AN ORDINANCE TO APPROPRIATE \$85,369 FROM THE LOCAL HOSPITALITY TAX FUND FOR CONSTRUCTION OF DAUFUSKIE ISLAND PARK TRAIL AND AMENITIES**

The Chairman opened a public hearing beginning at 6:51 p.m. for the purpose of receiving public comment regarding an ordinance to appropriate \$85,369 from the Local Hospitality Tax Fund for construction of Daufuskie Island Park trail and amenities. After calling three times for public comment and receiving none, the Chairman declared the hearing closed at 6:52 p.m.

It was moved by Mr. Dawson, as Public Facilities Committee Chairman, no second required, that Council approve on second reading an ordinance to appropriate \$85,369 from the Local Hospitality Tax Fund for construction of Daufuskie Island Park trail and amenities. The vote: YEAS – Mrs. Bensch, Mr. Caporale, Mr. Dawson, Mr. Flewelling, Mr. Fobes, Mrs. Howard, Mr. McBride, Mr. Rodman, Mr. Sommerville, Mr. Stewart and Mr. Vaux. The motion passed.

**COMPREHENSIVE PLAN FUTURE LAND USE MAP AMENDMENT FOR R600 040 000 0209 0000, R600 040 000 0824 0000, AND R600 040 000 0825 0000 (THREE PROPERTIES KNOWN AS EXECUTIVE GOLF COURSE, TOTALING 20.99 ACRES LOCATED ALONG BLUFFTON PARKWAY BETWEEN HILTON HEAD NATIONAL DRIVE AND KELLIE COURT): FROM RURAL TO NEIGHBORHOOD MIXED USE**

**SOUTHERN BEAUFORT COUNTY ZONING MAP AMENDMENTS FOR R600 040 000 0209 0000, R600 040 000 0824 0000, AND R600 040 000 0825 0000 (THREE PROPERTIES KNOWN AS EXECUTIVE GOLF COURSE, TOTALING 20.99 ACRES LOCATED ALONG BLUFFTON PARKWAY BETWEEN HILTON HEAD NATIONAL DRIVE AND KELLIE COURT); FROM T2-RURAL DISTRICT TO T4-NEIGHBORHOOD CENTER DISTRICT**

Due to the association of Agenda Items 10H and 10I, the Chairman declared that the two items be taken conjointly for purposes of a public hearing, discussion and action.

The Chairman opened a public hearing beginning at 6:52 p.m. for the purpose of receiving public comment regarding Comprehensive Plan Future Land Use Map amendments for R600 040 000 0209 0000, R600 040 000 0824 0000 and R600 040 000 0825 0000 (three properties, known as Executive Golf Course, totaling 20.99 acres located along Bluffton Parkway between Hilton Head National Drive and Kellie Court) from Rural to Neighborhood Mixed Use and Southern Beaufort County Zoning Map Amendments for R600 040 000 0209 0000, R600 040 000 0824 0000 and R600 040 000 0825 0000 (three properties, known as Executive Golf Course, totaling 20.99 acres located along Bluffton Parkway between Hilton Head National Drive and Kellie Court) from T2-Rural District to T4-Neighborhood Center District. After calling three times for public comment and receiving none, the Chairman declared the hearing closed at 6:53 p.m.

It was moved by Mr. Flewelling, as Natural Resources Committee Chairman, no second required, that Council approve on third and final reading Comprehensive Plan Future Land Use Map amendments for R600 040 000 0209 0000, R600 040 000 0824 0000 and R600 040 000 0825 0000 (three properties, known as Executive Golf Course, totaling 20.99 acres located along Bluffton Parkway between Hilton Head National Drive and Kellie Court) from Rural to Neighborhood Mixed Use. The vote: YEAS – Mrs. Bensch, Mr. Caporale, Mr. Dawson, Mr. Flewelling, Mr. Fobes, Mrs. Howard, Mr. McBride, Mr. Rodman, Mr. Sommerville, Mr. Stewart and Mr. Vaux. The motion passed.

It was moved by Mr. Flewelling, as Natural Resources Committee Chairman, no second required, that Council approve on third and final reading Southern Beaufort County Zoning Map Amendments for R600 040 000 0209 0000, R600 040 000 0824 0000 and R600 040 000 0825 0000 (three properties, known as Executive Golf Course, totaling 20.99 acres located along Bluffton Parkway between Hilton Head National Drive and Kellie Court) from T2-Rural District to T4-Neighborhood Center District. The vote: YEAS – Mrs. Bensch, Mr. Caporale, Mr. Dawson, Mr. Flewelling, Mr. Fobes, Mrs. Howard, Mr. McBride, Mr. Rodman, Mr. Sommerville, Mr. Stewart and Mr. Vaux. The motion passed.

**TEXT AMENDMENTS TO THE STORMWATER MANAGEMENT ORDINANCE (CHAPTER 99): AMEND ARTICLE II, STORMWATER MANAGEMENT (FOR CHANGES RELATED TO THE MS4 PERMIT IMPLEMENTATION); ADD ARTICLE III, REGULATORY GENERAL PROVISIONS; ARTICLE IV, STORMWATER MANAGEMENT STANDARDS TO BE APPLIED; ARTICLE V, ILLICIT DISCHARGES AND CONNECTIONS TO THE STORMWATER SYSTEM; AND ARTICLE VI, INSPECTION, ENFORCEMENT, AND CORRECTION**

The Chairman opened a public hearing beginning at 6:53 p.m. for the purpose of receiving public comment regarding text amendments to the Stormwater Management Utility Ordinance (Chapter 99): amend Article II, Stormwater Management (for changes related to the MS4 Permit implementation; add Article II, Regulatory General Provisions; Article IV, Stormwater Management Standards to be applied; Article V, Illicit Discharges and Connections to the Stormwater System; and Article VI Inspection, Enforcement, and Correction. After calling three times for public comment and receiving none, the Chairman declared the hearing closed at 6:53 p.m.

It was moved by Mr. Flewelling, as Natural Resources Committee Chairman, no second required, that Council approve on third and final reading text amendments to the Stormwater Management Utility Ordinance (Chapter 99): amend Article II, Stormwater Management (for changes related to the MS4 Permit implementation; add Article II, Regulatory General Provisions; Article IV, Stormwater Management Standards to be applied; Article V, Illicit Discharges and Connections to the Stormwater System; and Article VI Inspection, Enforcement, and Correction. The vote: YEAS – Mrs. Bensch, Mr. Caporale, Mr. Dawson, Mr. Flewelling, Mr. Fobes, Mrs. Howard, Mr. McBride, Mr. Rodman, Mr. Sommerville, Mr. Stewart and Mr. Vaux. The motion passed.

**MATTERS ARISING OUT OF EXECUTIVE SESSION**

**PROCLAMATION DECLARING PUBLIC HEALTH EMERGENCY / STATE OF EMERGENCY AS A RESULT OF HURRICANE MATTHEW**

The Chairman issued a Proclamation declaring a Public Health Emergency / State of Emergency due to Hurricane Matthew.

It was moved by Mr. Rodman, seconded by Mr. Flewelling, that Council ratify and endorse a Proclamation declaring a public health emergency as a result of Hurricane Matthew. The vote: YEAS- Mrs. Bensch, Mr. Caporale, Mr. Dawson, Mr. Flewelling, Mr. Fobes, Mrs. Howard, Mr. Rodman, Mr. Sommerville, Mr. Stewart, and Mr. Vaux. NAYS - Mr. McBride. The motion passed.

**MOTION TO EXTEND BEYOND 8:00 PM**

It was moved by Mr. Fobes, seconded by Mrs. Howard, that Council extend beyond 8:00 p.m. The vote: YEAS – Mrs. Bensch, Mr. Caporale, Mr. Dawson, Mr. Flewelling, Mr. Fobes, Mrs. Howard, Mr. Rodman, Mr. Sommerville, Mr. Stewart and Mr. Vaux. NAYS – Mr. McBride. The motion passed.

**PUBLIC COMMENT**

Mr. Pat Parkinson, President, Callawassee Island Property Owners Association, thanked Council for the proclamation declaring a public health emergency as a result of Hurricane Matthew, Callawassee Island currently has 20,000 cubic yards of storm debris lining the roads, providing difficulty for emergency services to get to our residents. He thanked all County Government leaders who coordinated evacuation and return, as well as Congress and County Administration.

Mr. Ted Bartlett, a resident of Dataw Island, thanked Council for the proclamation declaring a public health emergency due to Hurricane Matthew. The possibility that FEMA would exclude private communities from a program that private communities help fund, is inexcusable. Dataw Island has enough debris to fill up the Administration Building twice over.

Mr. Chris Assaf, representing the Fripp Island Property Owners Association, thanked Council for the proclamation declaring a public health emergency due to Hurricane Matthew and thanked for the assistance with the removal of white goods. The property owners on Fripp Island need Council's support.

**UPDATE / HURRICANE MATTHEW RECOVERY**

Mr. Eric Larson, Division Director–Environmental Engineering, presented Beaufort County’s new Disaster Recovery website that will serve as a one-stop portal for residents, businesses and municipalities to gain information about services available to them in the aftermath of Hurricane Matthew. Visit the website at [www.beaufortcountedisasterrecovery.net](http://www.beaufortcountedisasterrecovery.net)

Mr. Gary James, County Assessor, provided a spreadsheet on damage assessment through October 24, 2016.

**ADJOURNMENT**

Council adjourned at 8:26 p.m.

COUNTY COUNCIL OF BEAUFORT COUNTY

By: \_\_\_\_\_  
D. Paul Sommerville, Chairman

ATTEST: \_\_\_\_\_  
Ashley M. Bennett, Clerk to Council

Ratified:

**DRAFT**



# COMMUNITY SERVICES COMMITTEE

October 24, 2016

The electronic and print media duly notified in accordance with the State Freedom of Information Act.

The Community Services Committee met Monday, October 24, 2016 beginning at 3:00 p.m. in the Executive Conference Room of the Administration Building, Beaufort County Government Robert Smalls Complex, 100 Ribaut Road, Beaufort, South Carolina.

## ATTENDANCE

Committee Chairman William McBride, Vice Chairman Gerald Dawson and Committee members Rick Caporale, Steven Fobes, Alice Howard and Roberts "Tabor" Vaux. Non-committee members Cynthia Bensch, Brian Flewelling, Jerry Stewart and Paul Sommerville present. (Paul Sommerville, as County Council Chairman, serves as an *ex-officio* member of each standing committee of Council and is entitled to vote.)

County staff: Kimberly Chesney, Tax Collector; Allison Coppage, Assistant County Attorney; Phil Foot, Assistant County Administrator-Public Safety; Joshua Gruber, Assistant County Administrator/Special Counsel; Greg Hunt, Mosquito Control Director; Tom Keaveny, County Attorney; Gary Kubic, County Administrator; Eric Larson, Division Director-Environmental Engineering; Monica Spells, Assistant County Administrator-Civic Engagement and Outreach; Maria Walls, Treasurer; and George Wright, Deputy Treasurer.

Beaufort Memorial Hospital: Russell Baxley, President and CEO.

Public: Mike Covert, resident of Bluffton and Frank Turano, Lowcountry Regional Manager, Alliance Consulting Engineers.

Media: Joe Croley, *Lowcountry Inside Track*.

Councilman McBride chaired the meeting.

## INFORMATION ITEMS

### 1. Update / Mosquito Control

**Notification:** To view video of full discussion of this meeting please visit [http://beaufort.granicus.com/ViewPublisher.php?view\\_id=2](http://beaufort.granicus.com/ViewPublisher.php?view_id=2)

**Discussion:** Mr. Greg Hunt, Director, Mosquito Control Department, commented on the mosquito control spraying efforts in the aftermath of Hurricane Matthew.

- Received 696 complaints the week of October 17.
- Received 427 complaints on October 21.

- Aerial spray missions have been hampered by fog conditions.
- Spray trucks (five total) will deploy the night of October 24.
- Treatment of the northern part of the County to occur the morning of October 25.
- Aerial spray resumes October 26, 27 and 28 treating Bluffton and Hilton Head Island.
- Spray trucks typically operate from 11:30 p.m. to 6:30 a.m.
- Aircraft flies at sunrise for approximately two hours.
- Public encouraged to use the interactive map to track spraying activities.
- Treated 18,000 acres just off S.C. Highway 46 in two hours.
- Mosquito problem is a result of storm surge and rainfall due to Hurricane Matthew.

**Status:** Information only.

## **2. Introduction of Russell Baxley, President and CEO / Beaufort Memorial Hospital and Hurricane Matthew Recovery**

**Notification:** To view video of full discussion of this meeting please visit [http://beaufort.granicus.com/ViewPublisher.php?view\\_id=2](http://beaufort.granicus.com/ViewPublisher.php?view_id=2)

Discussion: Mr. Russell Baxley, President and CEO, Beaufort Memorial Hospital, was hired September 12, 2016. He is from Johnsonville, South Carolina. He received his Bachelor of Science degree in microbiology from Clemson University and Master of Healthcare Administration from the University of South Carolina. He most recently served as CEO of Lancaster Regional Medical Center in Lancaster, Pennsylvania.

Timeline of Hurricane Matthew:

- October 4 Governor Haley issued an evacuation notice.
- October 4 / October 5 DHEC approved the hospital request to shelter in place. Staff began working to reduce the census from 113 patients to 60. The hospital could safely house approximately 60 patients, sufficient supplies, and generator power for eight to nine days. Approximately 80 to 100 staff worked around the clock until after the mandatory evacuation was lifted.
- October 5 staff worked the census down to 90 patients.
- October 6 staff continued working the census down to 60 patients. Storm surge continued to be an issue. Hospital declared closed at approximately 4:00 p.m.
- October 6 / October 7 staff evacuated approximately 70 patients, plus several nurses, over a 12-hour period, to various hospitals – McCleodHealth, Clarendon Memorial Hospital, Aiken Regional Medical Center, AnMed Health Medical Center, and Self Regional Healthcare.
- Operated on generator power for approximately 22 hours.
- October 9 hospital reopened at 12:00 noon.

**Status:** Information only.

## COMMUNITY SERVICES COMMITTEE

November 7, 2016

The electronic and print media duly notified in accordance with the State Freedom of Information Act.

The Community Services Committee met Monday, November 7, 2016 beginning at 1:30 p.m. in the Executive Conference Room of the Administration Building, Beaufort County Government Robert Smalls Complex, 100 Ribaut Road, Beaufort, South Carolina.

### ATTENDANCE

Committee Chairman William McBride, Vice Chairman Gerald Dawson and Committee members Rick Caporale, Steven Fobes, Alice Howard and Roberts "Tabor" Vaux. Non-committee members Cynthia Bensch, Jerry Stewart and Paul Sommerville present. (Paul Sommerville, as County Council Chairman, serves as an *ex-officio* member of each standing committee of Council and is entitled to vote.)

County staff: Joshua Gruber, Assistant County Administrator/Special Counsel; Tom Keaveny, County Attorney; and Gary Kubic, County Administrator.

Public: Mike Covert, resident of Bluffton; Billy Keyserling, Mayor, City of Beaufort; Jennifer Sanborn, Marketing and Communications Manager, 303 Associates; Dick Stewart, President and CEO, 303 Associates; and Van Willis, Manager, Town of Port Royal;

Media: Joe Croley, *Lowcountry Inside Track*.

Councilman McBride chaired the meeting.

### INFORMATION ITEMS

- 1. A Resolution Requesting that the President of the United States of America Give Favorable Consideration of Establishing a New Unit of the National Park Service in Beaufort County to Remember the Reconstruction Era**

**Notification:** To view video of full discussion of this meeting please visit [http://beaufort.granicus.com/ViewPublisher.php?view\\_id=2](http://beaufort.granicus.com/ViewPublisher.php?view_id=2)

**Discussion:** Mr. William McBride, Chairman, Community Services Committee, introduced two versions of resolution requesting that the President of the United States of America give favorable consideration to establishing a National Monument in Beaufort County, South Carolina to remember the Reconstruction Era.

Version A was adopted by both the City of Beaufort and Town of Port Royal, while version B, submitted by Councilman Rodman, delineates an array of historical activities and sites that defined the Reconstruction Era. The closing paragraph in both resolutions retains the same

resolve: “That the County Council of Beaufort County hereby adopts a resolution requesting the President of the United States of America give favorable consideration to establishing a National Monument in Beaufort County to remember the Reconstruction Era.” Each member of the committee expressed support of resolution A.

Mr. Rodman agreed to forward the resolution to Drs. Steve Wise, Larry Rowland, and Alexander Morris, distinguished historians of the Palmetto State, for their review and comment.

**Motion:** It was moved by Mr. Vaux, seconded by Mr. Fobes that Council adopt a resolution requesting that the President of the United States of America gives favorable consideration to establishing a National Monument in Beaufort County, South Carolina to remember the Reconstruction Era. The vote: YEAS – Mr. Caporale, Mr. Dawson, Mr. Fobes, Mrs. Howard, Mr. McBride and Mr. Vaux. The motion passed.

**Recommendation:** Council adopt resolution requesting that the President of the United States of America give favorable consideration to establishing a National Monument in Beaufort County, South Carolina to remember the Reconstruction Era.

DRAFT

## FINANCE COMMITTEE

October 24, 2016

The electronic and print media duly notified in accordance with the State Freedom of Information Act.

The Finance Committee met Monday, October 24, 2016 beginning at 3:30 p.m., in the Executive Conference Room, Administration Building, Beaufort County Government Robert Smalls Complex, 100 Ribaut Road, Beaufort, South Carolina.

### ATTENDANCE

Chairman Jerry Stewart, Vice Chairman Steven Fobes and members Cynthia Bensch, Rick Caporale, Brian Flewelling, William McBride and Stu Rodman. Non-committee members Gerald Dawson, Alice Howard and Paul Sommerville present. (Paul Sommerville, as County Council Chairman, serves as an *ex-officio* member of each standing committee of Council and is entitled to vote.).

County staff: Jim Beckert, Auditor; Kimberly Chesney, Tax Collector; Allison Coppage, Assistant County Attorney; Joshua Gruber, Deputy County Administrator/Special Counsel; Eric Lawson, Division Director–Environmental Engineering; Alicia Holland, Assistant County Administrator–Finance; Gary James, Assessor; Tom Keaveny, County Attorney; Gary Kubic, County Administrator; Maria Walls, Treasurer; and George Wright, Deputy Treasurer.

Public: Mike Covert, Bluffton resident and Norma Stewart, Bluffton resident.

Media: Joe Croley, *Lowcountry Inside Track*.

Councilman Stewart chaired the meeting.

### ACTION ITEM

#### **1. 30-Day Extension of Tax Bill Payments**

**Notification:** To view video of full discussion of this meeting please visit [http://beaufort.granicus.com/ViewPublisher.php?view\\_id=2](http://beaufort.granicus.com/ViewPublisher.php?view_id=2)

**Discussion:** Mrs. Maria Walls, Treasurer, presented to the Committee the protocol for a 30-day extension of tax bill payments. If Council decided to move forward with a 30-day extension of tax bill payments, it would require approval of a resolution by County Council, then the Treasurer would submit a letter to the South Carolina Department of Revenue (DOR) requesting the extension be granted.

Mrs. Walls stated a 30-day extension would not be detrimental to the organization or any other taxing authorities. Approval of the extension would not eliminate a penalty. It would delay the January 15 penalty until February 15, meaning both penalties would be due at the same time. In addition, if approved, the print vendor would have to alter the tax bill where it identifies the penalty dates. This task would take 48 hours. Subsequent to that turnaround time, BB&T would need to retest the Lockbox Facility used to scan and process payments from a three-date penalty to a two-date penalty, which would take no more than ten business days.

**Motion:** It was moved by Mr. Flewelling, seconded by Mr. Caporale, that Committee approve and recommend Council adopt a resolution to authorize the County Treasurer to take all necessary action to seek approval from the South Carolina Department of Revenue for a 30-day extension from penalties delineated within South Carolina Code Ann. 12-45-180(a). The vote: YEAS – Mrs. Bensch, Mr. Caporale, Mr. Fobes, Mr. Flewelling, Mr. McBride, Mr. Rodman and Mr. Stewart. The motion passed.

**Recommendation:** Council adopt a resolution to authorize the County Treasurer to take all necessary action to seek approval from the South Carolina Department of Revenue for a 30-day extension from penalties delineated within South Carolina Code Ann. 12-45-180(a).

## **INFORMATION ITEMS**

### **2. Financial Impact of Hurricane Matthew**

**Notification:** To view video of full discussion of this meeting please visit [http://beaufort.granicus.com/ViewPublisher.php?view\\_id=2](http://beaufort.granicus.com/ViewPublisher.php?view_id=2)

**Discussion:** Mr. Joshua Gruber, Deputy County Administrator / Special Counsel, provided the Committee with an update on current cash positions and provided an overview of a graph outlining Beaufort County's total cash position from July 2015 to August 2016. The County has issued several contracts (estimated cost of \$10 million) related to debris management and response due to Hurricane Matthew. We are hoping a substantial portion will be reimbursed by FEMA. If we are eligible to use FEMA's pilot program, we would be reimbursed at 87% of all work done within the first 30 days, 82% for work done between 30 to 90 days, and 75% thereafter. Historically, the General Assembly has reimbursed counties for the unreimbursed portions.

Mrs. Alicia Holland, Assistant County Administrator–Finance, stated in conversations with the Treasurer regarding the cash flow, she feels Beaufort County will be fine. Beaufort County has a \$10 million line of credit available through Bank of America, if needed.

Mr. Gruber informed the Committee that after Hurricane Matthew, a request was made to the State asking that we be allowed to use our own contractor for debris cleanup since they were already on-site, instead of waiting for the State contractor to clean up the debris from the State roadways. The State denied the request due to the inability to differentiate between debris being picked up from County roadways versus State roadways. The County Administrator, at that

time, made the decision to take on the responsibility for the State roadways, since we could respond to it the fastest. Member of the Legislative Delegation have been informed of the matter.

Mr. Gruber provided the Committee with information on the three permitted debris sites-- Bluffton at Pinckney Point, St. Helena Island at Henry Sod Farm, and Lobeco at Isley Farm. The Bluffton and the St. Helena sites have been approved for Air Curtain Destruction and the Lobeco site has been approved for grinding of the vegetation.

**Status:** Information only.

### **3. Third and Final Reading of \$51,000,000 General Obligation Bond**

**Notification:** To view video of full discussion of this meeting please visit [http://beaufort.granicus.com/ViewPublisher.php?view\\_id=2](http://beaufort.granicus.com/ViewPublisher.php?view_id=2)

**Discussion:** Committee Chairman Jerry Stewart stated this item is on today's County Council agenda for third and final reading.

Mr. Joshua Gruber, Deputy County Administrator / Special Counsel, reviewed with the Committee the effects this bond issues would have on millage. Of the \$51 million, the portions that are attributable to the Rural and Critical Lands Program and Stormwater Management, do not affect the County's debt millage. The other remaining portions would. Our current available debt capacity, under that calculation, is approximately \$50 million.

**Status:** Information only.

## GOVERNMENTAL COMMITTEE

November 7, 2016

The electronic and print media duly notified in accordance with the State Freedom of Information Act.

The Governmental Committee met Monday, November 7, 2016 beginning at 4:00 p.m. in the Executive Conference Room of the Administration Building, Beaufort County Government Robert Smalls Complex, 100 Ribaut Road, Beaufort, South Carolina.

### ATTENDANCE

Chairman Stu Rodman, Vice Chairman Rick Caporale, and Committee members Cynthia Bensch, Alice Howard and Jerry Stewart. Gerald Dawson and Brian Flewelling absent. Non-Committee members Steven Fobes, William McBride and D. Paul Sommerville present. (Paul Sommerville, as County Council Chairman, serves as an *ex-officio* member of each standing committee of Council and is entitled to vote.)

County Staff: Joshua Gruber, Deputy County Administrator/Special Counsel and Thomas Keaveny, County Attorney.

Public: Ernest Andrade, Executive Director, Charleston Digital Corridor; Andy Beall, member, Mayors Heritage Tourism Advisory Committee; Joel Braun, Director, Business Sales, Hargray Communications; Mike Covert, resident of Bluffton; Malcolm Goodridge, Beaufort Regional Chamber of Commerce; Richard Gough, member, Economic Development Corporation; Hannah Horne, Director, Public Policy and Small Business, Hilton Head Island/Bluffton Chamber of Commerce; Deborah Johnson, project manager, City of Beaufort; Billy Keyserling, Mayor, City of Beaufort; Joe Lee, member, Economic Development Corporation; Stephen Murray, Chairman, Economic Development Corporation; David Nelems, Executive Director, Don Ryan Center for Innovation; Bill Prokop, Manager, City of Beaufort; Jason Ruhf, Beaufort Regional Chamber of Commerce; Linda Roper, Courts Administrator, City of Beaufort; Karen Warner, Manager, Beaufort Digital Corridor; Jennifer Weidner, Associate Strategic Account Manager, Hargray Communications; Blakely Williams, President/CEO, Beaufort Regional Chamber of Commerce; and Van Willis, Manager, Town of Port Royal.

Media: Joe Croley, *Lowcountry Inside Track*.

Mr. Rodman chaired the meeting.



## **ACTION ITEM**

### **1. Allocation of \$140,000 / Appropriations Act for FY 2016-2017: Proviso 50.13 Local Economic Development Alliances Funds**

**Notification:** To view video of full discussion of this meeting please visit [http://beaufort.granicus.com/ViewPublisher.php?view\\_id=2](http://beaufort.granicus.com/ViewPublisher.php?view_id=2)

**Discussion:** Mr. Stephen Murray, Chairman of the Economic Development Corporation, presented this item to the Committee. The Beaufort Digital Corridor and Don Ryan Center for Innovation will simultaneously develop complementary projects that address a twofold strategy vital to the overall economic health of the county, regions and state that involves: (i) recruiting and developing new companies and (ii) growing businesses from within to retain talent. These innovations centers have been initiated by municipalities – City of Beaufort and Town of Bluffton – the impact will be countywide with no jurisdictional lines evident beyond the addresses of the physical sites where these centers are located, and the critical operating support and investment provided by the two municipalities to ensure sustainability of these projects they have cultivated.

The request before Committee is to consider using the \$140,000 allocated for Beaufort County in the Appropriations Act for FY 2016-2017: Proviso 50.13 Local Economic Development Alliances Funds -- for economic development to further the Beaufort Digital Corridor or the Don Ryan Center for Innovation incentives.

**Motion:** It was moved by Mr. Flewelling, seconded by Mr. Caporale, that Committee approve and recommend to Council using the \$140,000 allocated for Beaufort County in the Appropriations Act for FY 2016-2017: Proviso 50.13 Local Economic Development Alliances Funds for economic development in furtherance of the Beaufort Digital Corridor or the Don Ryan Center for Innovation incentives. The vote: YEAS – Mr. Caporale, Mr. Dawson, Mr. Flewelling, Mrs. Howard, Mr. Sommerville, Mr. Stewart and Mr. Rodman. NAY – Mrs. Bensch. The motion passed.

**Recommendation:** Council approve the use of the \$140,000 allocated for Beaufort County in the Appropriations Act for FY 2016-2017: Proviso 50.13 Local Economic Development Alliances Funds for economic development in furtherance of the Beaufort Digital Corridor or the Don Ryan Center for Innovation incentives.

## **INFORMATION ITEMS**

### **2. Consideration of Contract Award / Facilitator for Beaufort County Economic Development Corporation**

**Notification:** To view video of full discussion of this meeting please visit [http://beaufort.granicus.com/ViewPublisher.php?view\\_id=2](http://beaufort.granicus.com/ViewPublisher.php?view_id=2)

**Motion:** It was moved by Mr. Flewelling, seconded by Mrs. Howard, that Committee award a contract to Camoin Associates, Saratoga Springs, New York in the amount not to exceed \$32,197 (\$29,270 total project fee and \$2,927 ten percent contingency) to provide facilitation and preparation of a Strategic Plan for the Beaufort County Economic Development Corporation. The vote: YEAS – Mrs. Bensch, Mr. Caporale, Mr. Dawson, Mr. Flewelling, Mrs. Howard, Mr. Stewart and Mr. Rodman. The motion passed.

**Status:** Committee awarded a contract to Camoin Associates, Saratoga Springs, New York in the amount not to exceed \$32,197 (\$29,270 total project fee and \$2,927 ten percent contingency) to provide facilitation and preparation of a Strategic Plan for the Beaufort County Economic Development Corporation.

### **3. Update / Heritage Tourism**

**Notification:** To view video of full discussion of this meeting please visit [http://beaufort.granicus.com/ViewPublisher.php?view\\_id=2](http://beaufort.granicus.com/ViewPublisher.php?view_id=2)

**Discussion:** Dr. Andy Beall, Executive Director, Santa Elena Foundation, reported that the Mayors Heritage Tourism Commission has held monthly meetings. The first effort was to identify and then quantify all of the different historic assets in the county. To “test assets” the members agreed to participate in a series of tours (four to date) and to collect the data needed for a county-wide view of all the county's historic assets.

**Status:** Informational only.

### **4. Comprehensive Financial Plan: Revenues and Expenditures**

**Notification:** To view video of full discussion of this meeting please visit [http://beaufort.granicus.com/ViewPublisher.php?view\\_id=2](http://beaufort.granicus.com/ViewPublisher.php?view_id=2)

**Discussion:** Mr. Rodman stated that discussion of this item occurred during the Finance Committee held earlier today.

**Status:** No action.

## 5. Executive Session

**Notification:** To view video of full discussion of this meeting please visit [http://beaufort.granicus.com/ViewPublisher.php?view\\_id=2](http://beaufort.granicus.com/ViewPublisher.php?view_id=2)

**Motion:** It was moved by Mrs. Bensch, seconded by Mr. Flewelling, that Committee goes immediately into executive session for the purposes of discussing negotiations incident to provide contractual arrangements, discussion of economic development prospect-project Abacus and discussion of economic development prospect-Project Eagle. The vote: YEAS – Mrs. Bensch, Mr. Caporale, Mr. Dawson, Mr. Flewelling, Mrs. Howard, Mr. Stewart and Mr. Rodman. The motion passed.

**Status:** No action.

DRAFT

## NATURAL RESOURCES COMMITTEE

October 17, 2016

The electronic and print media duly notified in  
Accordance with the State Freedom of Information Act.

The Natural Resources Committee met Monday, October 17, 2016 beginning at 2:00 p.m. in the Executive Conference Room, Administration Building, Beaufort County Government Robert Smalls Complex, 100 Ribaut Road, Beaufort, South Carolina.

### ATTENDANCE

Committee Chairman Brian Flewelling, Vice Chairman Alice Howard and members Steven Fobes William McBride, Jerry Stewart and Roberts "Tabor" Vaux present. Member Gerald Dawson absent.

County Staff: Pamela Cobb, Disaster Recovery Coordinator; Allisson Coppage, Assistant County Attorney; Tony Criscitiello, Planning Director; Joshua Gruber, Deputy County Administrator/Special Counsel; Alicia Holland, Assistant County Administrator-Finance; Gary James, Assessor; Thomas Keaveny, County Attorney; Gary Kubic, County Administrator; Eric Larson, Division Director-Environmental Engineering; and Dan Morgan, Mapping and Applications Director.

Public: Reid Armstrong, South Coast Office Project Manager, Coastal Conservation League and Mike Covert, resident of Bluffton.

Media: Joe Croley, *Lowcountry Inside Track*.

Mr. Flewelling chaired the meeting.

### ACTION ITEM

- 1. A resolution requesting the General Assembly to amend the annexing authority of municipalities and provide County Councils the ability to protect their citizens from land use that may be inappropriate and contrary to the Comprehensive Land Use and Transportation Plan adopted by the County**

**Notification:** To view video of full discussion of this meeting please visit [http://beaufort.granicus.com/ViewPublisher.php?view\\_id=2](http://beaufort.granicus.com/ViewPublisher.php?view_id=2)

**Discussion:** Mr. Tom Keaveny, County Attorney, reviewed this item with the Committee. This is a resolution requesting the General Assembly to amend the annexing authority of municipal governments, to allow Beaufort County Council to protect the public health, safety, morals, convenience, general welfare and quality of life for non-municipal citizens. This resolution is similar to the resolution passed by Edgefield County.

**Motion:** It was moved by Mr. McBride, seconded by Mr. Fobes, that Natural Resources Committee recommend Council adopt a resolution requesting the General Assembly to amend the annexing authority of municipalities and provide County Councils the ability to protect their citizens from land use that may be inappropriate and contrary to the Comprehensive Land Use and Transportation Plan adopted by the County. The vote: YEAS – Mr. Flewelling, Mr. Fobes, Mrs. Howard, Mr. McBride, Mr. Stewart and Mr. Vaux. ABSENT – Mr. Dawson. The motion passed.

**Recommendation:** Council adopt a resolution requesting the General Assembly to amend the annexing authority of municipalities and provide County Councils the ability to protect their citizens from land use that may be inappropriate and contrary to the Comprehensive Land Use and Transportation Plan adopted by the County.

## **INFORMATION ITEMS**

### **2. Off Agenda / Discussion / Redistributing Seats on Planning Commission**

**Notification:** To view video of full discussion of this meeting please visit [http://beaufort.granicus.com/ViewPublisher.php?view\\_id=2](http://beaufort.granicus.com/ViewPublisher.php?view_id=2)

**Discussion:** The Planning Commission is currently composed of nine members: four members who reside in northern Beaufort County, including the municipalities (one each from Sheldon Township, Port Royal Island, Lady's Island, and St. Helena Island); four members who reside in southern Beaufort County, including the municipalities; and one at-large member who may reside anywhere in the County, including municipalities. There have been discussions of whether or not there is a better approach to the membership structure and the possibility of membership based on councilmatic districts. It was asked that staff bring forward a recommendation.

**Status:** Committee requested staff bring forward a recommendation to possibly amend the membership structure of the Planning Commission.

### **3. Text amendments to the Community Development Code: Overnight Parking of Trucks and Home Occupation**

**Notification:** To view video of full discussion of this meeting please visit [http://beaufort.granicus.com/ViewPublisher.php?view\\_id=2](http://beaufort.granicus.com/ViewPublisher.php?view_id=2)

**Discussion:** Mr. Tony Criscitiello, Planning Director, reviewed this item with the Committee.

### Overnight Parking of Trucks

There have been issues and concerns relative to the parking of trucks on properties. Section 3.1.60, Consolidate Use Table and the language in Division 5.5: Off-Street Parking contradicts one another.

### Home Occupation

There have been issues and concerns relative to use of Home Business. Table 44.2.20A: Table of Permitted Accessory Uses and the language in Section 4.2.80: Home Business was reviewed with the Committee. The language is intertwined and there is discussion of whether a caveat is needed to allow the parking of trucks in T2.

The Committee discussed this item and the possibility of including a 50 foot buffer condition was suggested. The Committee concurred with the creation of a specific use and asked that the Planning Commission weigh in.

**Status:** This item was sent to the Planning Commission for discussion and recommendation.

#### **4. Environmental Protection Agency (EPA) Issue Regarding Kalama Chemical**

**Notification:** To view video of full discussion of this meeting please visit [http://beaufort.granicus.com/ViewPublisher.php?view\\_id=2](http://beaufort.granicus.com/ViewPublisher.php?view_id=2)

**Discussion:** Mr. Tony Criscitiello, Planning Director, reviewed with the Committee the history relative to Kalama Specialty Chemicals Superfund Site (Site), located in Beaufort, South Carolina. The principal product manufactured at the Site was Krenite, an herbicide made under contract with DuPont Company. Wastes from the Site included wastewater, composed of cooling water, runoff, boiler blowdown and pump seal leakage and spillage disposed of on site, and other non-aqueous and organic wastes, which companies disposed of at approved off-site incineration or disposal facilities. Mr. Criscitiello briefed the Committee on a laboratory equipment fire at the facility in 1979, the ongoing analyses of the site soils and the institutional controls put in place at the site. These controls are in the form of restricting the use of groundwater on the following parcels R100 020 000 0091 0000 and R100 020 000 0089 000.

**Status:** Information only.

## 5. Hurricane Matthew Recovery Functions

**Notification:** To view video of full discussion of this meeting please visit [http://beaufort.granicus.com/ViewPublisher.php?view\\_id=2](http://beaufort.granicus.com/ViewPublisher.php?view_id=2)

**Discussion:** Mr. Tony Criscitiello, Planning Director, reviewed with the Committee the Planning Departments Recovery Functions: Function #13 Temporary Housing and Function #16 Environmental Preservation and Restoration.

Mr. Eric Larson, Division Director–Environmental Engineering, provided the Committee with a briefing covering the following areas: Debris Management, Damage Assessment, Utilities Update, Donations and Volunteers, Finance and FEMA Documentation, Shelters and PODs, Schools, Animal Shelter, Mortuary Services, Chamber of Commerce, Temporary Housing, Communications, and the municipalities. A handout was provided to the Committee that outlined the same.

Mr. Gary James, Assessor, provided the Committee with a Damage Assessment Report. A handout was provided to the Committee that outlined the same.

**Status:** Information only.

## 6. Off Agenda / Planning Department Bulletin Board

**Notification:** To view video of full discussion of this meeting please visit [http://beaufort.granicus.com/ViewPublisher.php?view\\_id=2](http://beaufort.granicus.com/ViewPublisher.php?view_id=2)

**Discussion:** Committee Chairman Brian Flewelling asked for an update on the creation of an online interactive bulletin board for the function of the Planning Department.

Mr. Tony Criscitiello, Planning Director, stated the creation is still in the works and will be reviewed by the Committee in the near future.

**Status:** Information only.

## 7. Consideration of Reappointments and Appointments / Zoning Board of Appeals

**Notification:** To view video of full discussion of this meeting please visit [http://beaufort.granicus.com/ViewPublisher.php?view\\_id=2](http://beaufort.granicus.com/ViewPublisher.php?view_id=2)

**Status:** This item will be taken up at the next meeting of the Natural Resources Committee.

**ACCOMMODATIONS TAX BOARD**  
**Beaufort County Industrial Village**  
**104 Industrial Village Road, Building #3**  
**Tuesday, October 4, 2016**

Organization	Event/Project	Amt. Requested	Rec. Last Yr.	Amt. Recom	% of Ask	Name	Notes
Arts Center of Coastal Carolina	Tourism Marketing of the Unincorporated Area of Southern Beaufort County	\$ 15,000	\$ 11,250	\$ 10,000	66.7%	Linda S. Bloom	
Beaufort Arts Council	Promotional Marketing Piece - 'A Lowcountry Journey Through the Arts'	\$ 2,073	\$ -	\$ 2,000	96.5%	Delene D. Miller	Rack cards
Beaufort Arts Council	ArtPop	\$ 8,250	\$ -	\$ -	0.0%	Delene D. Miller	Billboards-12
Beaufort County Black Chamber of Commerce	Cultural Tourism Marketing	\$ 125,000	\$ 75,000	\$ 81,000	64.8%	Liz Mitchell	Pathfinders; So. Living; Group
Beaufort County Historical Society	Historical Markers	\$ 4,000	\$ 5,000	\$ 1,500	37.5%	Mary Lou Brewton	
Beaufort Film Society	Beaufort International Film Festival	\$ 27,000	\$ 17,500	\$ 17,500	64.8%	Ron Tucker	
Beaufort History Museum	Renovation of the Main Gallery Exhibit	\$ 100,000	\$ 10,000	\$ 30,000	30.0%	Carol Lauvray	Panels
Beaufort Regional Chamber of Commerce	Tourism Marketing FY 2016-2017	\$ 120,000	\$ 75,000	\$ 100,000	83.3%	Robb Wells	All but print
Bluffton Historical Preservation Society	Heyward House Historic Center	\$ 20,000	\$ 20,000	\$ 18,500	92.5%	Katie Epps	
Burton Fire District	Emergency Response Resource/Vehicle for Spanish Moss Trail	\$ 28,000	\$ -	\$ -	0.0%	James Still	Not tourists
Coastal Discovery Museum	Cultural and Eco-Tourism Programs	\$ 28,500	\$ 20,000	\$ 20,000	70.2%	Natalie Hefter	Eco ads
Community Foundation of the Lowcountry	2017 Public Air Exhibition on HHI	\$ 20,000	\$ -	\$ 4,000	20.0%	Jean M. Heyduck	Ads
Daufuskie Island Community Preservation Zone Association (CPZA)	Accessories for Phase 2 Development of the Daufuskie Island County Park	\$ 30,079	\$ -	\$ -	0.0%	Don Newton	
Daufuskie Island Foundation	Daufuskie Day	\$ 15,000	\$ 6,000	\$ 5,500	36.7%	Deborah Edmondson	Print ads
Daufuskie Island Historical Foundation	Brochure Printing	\$ 5,000	\$ 1,500	\$ 2,500	50.0%	Nancy Ludtke	Brochures
Exchange Club and Child Abuse Prevention Association (CAPA)	CAPA and Exchange Club Ghost Tours	\$ 1,076	\$ 500	\$ 680	63.2%	Jessica Chapman	Banner & Columbia mag
Friends of Fort Fremont	Fort Fremont Historical Preserve - Visitor Educational Video	\$ 7,000	\$ 5,000	\$ 5,000	71.4%	Wendy Wilson	Post-production & rack cards
Friends of Hunting Island State Park	Replacement of ADA Compliant Equipment at Hunting Island SP	\$ 20,000	\$ -	\$ 11,365	56.8%	Mary Ann Radke	2 chairs; mats
Friends of the Spanish Moss Trail	Spanish Moss Trail	\$ 35,160	\$ -	\$ 3,150	9.0%	Sissy Perryman	App upgrade
Greater Bluffton Chamber of Commerce	Tourism Events	\$ 20,000	\$ -	\$ 10,800	54.0%	Shellie West	
Gullah Museum of Hilton Head Island	Programming Offerings	\$ 50,000	\$ 15,000	\$ 20,000	40.0%	Louise Cohen	
Heritage Library Foundation, Inc	Heritage Library Beaufort Branch	\$ 20,000	\$ 1,000	\$ 400	2.0%	Linda Piekut	Sign
HHI Bluffton Chamber of Commerce and Visitor & Convention Bureau	Southern Beaufort County Destination Marketing	\$ 25,000	\$ 20,000	\$ 21,000	84.0%	Brenda Ciapanna	Conde Nast
HHI Motoring Festival & Concours d'Elegance	HHI Coucours d'Elegance	\$ 30,000	\$ 25,000	\$ 25,000	83.3%	Lindsay Harrell	Advertising
Hilton Head Choral Society	Choral Festival Event and Audience Development Project	\$ 8,000	\$ 3,000	\$ 3,000	37.5%	James C. Deas	Social media
Hilton Head Hospitality Association	Hilton Head Wine and Food Festival	\$ 10,000	\$ 2,000	\$ 5,000	50.0%	Jeff Gerber	Social media
Hilton Head Seafood Festival	Coastal Culinary and Heritage Dinner	\$ 12,000	\$ -	\$ 5,000	41.7%	Kelly Smith	
Hilton Head Symphony Orchestra	Television & Facebook Advertising	\$ 12,000	\$ 5,000	\$ 6,000	50.0%	Sarah Bergin	Cable ads
Historic Beaufort Foundation	Fall Festival of Houses & Gardens	\$ 15,942	\$ 3,500	\$ 5,255	33.0%	Isabella S. Reeves	Printing
Historic Bluffton Arts & Seafood Festival, Inc	Historic Arts & Seafood Festival	\$ 10,000	\$ 10,000	\$ 10,000	100.0%	MaryAnn O'Neill	Southern Living
Lean Ensemble Theater	LET Productions	\$ 6,000	\$ -	\$ 1,350	22.5%	Stephen Hasley	Social media; org dues
Lowcountry Golf Course Owners Association	Golf Tourism Broadcast Campaign	\$ 20,000	\$ 10,000	\$ 10,000	50.0%	Robbie Wooten	
Main Street Beaufort	Tourism Marketing FY 2016-2017	\$ 35,000	\$ 20,000	\$ 15,000	42.9%	LaNelle Fabian	Visitrs guide; Facebook;
Main Street Youth Theatre, Inc.	Main Street Youth Theatre 2017 Season	\$ 15,000	\$ -	\$ -	0.0%	Phyllis Neville	
Mitchelville Preservation Project	Mitchelville Preservation Project	\$ 75,000	\$ 25,000	\$ 23,500	31.3%	Courtney Young	
Native Island Business and Community Affairs Association (NIBCAA)	HHI Gullah Celebration	\$ 75,000	\$ 20,000	\$ 23,000	30.7%	Courtney Young	Print & social media
Port Royal Sound Foundation	Port Royal Sound Foundation Maritime Center	\$ 69,590	\$ 3,750	\$ 10,000	14.4%	Jody Hayward	Print and digital ads
SC Lowcountry & Resort Island Tourism Commission	Promotion of Beaufort County & the Lowcountry	\$ 40,000	\$ 32,000	\$ 32,000	80.0%	Peach Morrison	
The First Tee of the Lowcountry	Disc Golf Tournament	\$ 25,000	\$ -	\$ 9,500	38.0%	John Preston	Facility
The Sandbox Children's Museum	Big Summer Blowout	\$ 2,000	\$ 2,000	\$ 1,500	75.0%	Caroline Rinehart	Marketing

Note: Event-\$5,000; Project-\$3,000

TOTAL: \$ 1,186,670 \$ 444,000 \$ 550,000 46.8%

Total Allotment: \$550,000

Amount Remaining: \$ -





COUNTY COUNCIL OF BEAUFORT COUNTY  
**PURCHASING DEPARTMENT**  
106 Industrial Village Road  
Post Office Drawer 1228  
Beaufort, South Carolina 29901-1228

TO: Councilman Jerry Stewart, Chairman, Finance Committee  
FROM: Dave Thomas, CPPO, Purchasing Director  
SUBJ: **Contract Award Recommendation for IFB# 071416HXD: Runway 21 Extension and Taxiway F Infield Drainage Improvements**  
DATE: October 17, 2016

**BACKGROUND:** Beaufort County issued an Invitation to Bid (IFB) to contractors capable of providing the requisite services associated with the extension of Runway 21 and improvements to the drainage system that parallels Taxiway F. This project is being executed in accordance with the Hilton Head Island Airport Master Plan Phase I Implementation as directed by Beaufort County and Town of Hilton Head Councils in 2010.

Bids were received and reviewed by airport staff and consultants and it was determined that Quality Enterprises USA, Inc., was the lowest responsible/responsive bidder.

**VENDOR INFORMATION:**

Quality Enterprises USA, Inc. Chesapeake, VA (sole bidder)

**COST:**

\$10,364,389

**CONSTRUCTION ADMIN, RESIDENT PROJECT REPRESENTATIVE:**

Talbert, Bright, and Ellington, Charlotte, NC  
(Construction Admin, Quality Control, Resident Project representative, 18-B As-Built Survey)

\$1,063,605

Total: \$11,427,924

**FUNDING:** 90% via FAA AIP Grant 39, 5% through SCAC Grant (pending), and 5% via Hilton Head Island Airport Capital Projects Fund.

**FOR ACTION:** Finance Committee meeting occurring November 7, 2016.

**RECOMMENDATION:** The Finance Committee approve and recommend to County Council the contract award to Quality Enterprises USA, Inc., to perform the required construction services for a total cost of \$10,364,389 and the construction administration fee of \$1,063,605 to Talbert, Bright, and Ellington.

cc: Gary Kubic, County Administrator  
Joshua Gruber, Deputy County Administrator/Special Counsel  
Alicia Holland, Asst. County Administrator, Finance  
Colin Kinton, Director, Transportation Engineering  
Jon Rembold, Airports Director

Att: Bid Tab

**BID TABULATION**  
**SCHEDULE A - RUNWAY 21 EXTENSION**  
**HILTON HEAD ISLAND AIRPORT**  
**TBE PROJECT NO. 2119-1006**  
AUGUST 18, 2016

BASE BID					QUALITY ENTERPRISES USA, INC. CHESAPEAKE, VA LICENSE NO.: 97783		Engineer's Estimate	
ITEM NO.	SPEC NO.	DESCRIPTION	QTY	UNIT	UNIT PRICE	EXT. TOTAL	UNIT PRICE	EXT. TOTAL
1	GP105	MOBILIZATION	1	LS	\$693,000.00	\$693,000.00	\$800,000.00	\$800,000.00
2	02374	TEMPORARY CONSTRUCTION ENTRANCE	1	EA	\$2,100.00	\$2,100.00	\$3,000.00	\$3,000.00
3	02374	TEMPORARY SILT FENCE	3,055	LF	\$3.50	\$10,692.50	\$4.00	\$12,220.00
4	02374	TEMPORARY SEDIMENT BASIN WITH SKIMMER	2	EA	\$12,185.00	\$24,370.00	\$16,000.00	\$32,000.00
5	02374	TYPE 'A' INLET PROTECTION	4	EA	\$190.00	\$760.00	\$500.00	\$2,000.00
6	02374	TEMPORARY WOOD RISER INLET PROTECTION	2	EA	\$1,190.00	\$2,380.00	\$500.00	\$1,000.00
7	02374	TEMPORARY DIVERSION SWALE	570	LF	\$6.00	\$3,420.00	\$5.00	\$2,850.00
8	02374	RIP RAP, CLASS B	225	SY	\$90.00	\$20,250.00	\$95.00	\$21,375.00
9	02374	TEMPORARY TURBIDITY CURTAIN	1	EA	\$1,300.00	\$1,300.00	\$2,000.00	\$2,000.00
10	P-151	CLEARING AND GRUBBING	1.5	AC	\$9,500.00	\$14,250.00 *	\$4,000.00	\$6,000.00
11	REP	REMOVE EXISTING BITUMINOUS PAVEMENT, FULL DEPTH (AIRFIELD)	110	SY	\$10.00	\$1,100.00	\$25.00	\$2,750.00
12	REP	REMOVE EXISTING BITUMINOUS PAVEMENT, FULL DEPTH (NON-AIRFIELD)	2,275	SY	\$6.00	\$13,650.00	\$10.00	\$22,750.00
13	P-160	BITUMINOUS PAVEMENT MILLING (4-INCH DEPTH)	39	SY	\$60.00	\$2,340.00	\$50.00	\$1,950.00
14	RPS	REMOVE EXISTING BUILDING #1	1	LS	\$175,000.00	\$175,000.00	\$200,000.00	\$200,000.00
15	RPS	REMOVE EXISTING BUILDING #2	1	LS	\$17,800.00	\$17,800.00	\$2,500.00	\$2,500.00
16	RPS	REMOVE EXISTING TRIPLE PIPE HEADWALL	1	EA	\$1,500.00	\$1,500.00	\$2,000.00	\$2,000.00
17	RPS	REMOVE EXISTING 18-INCH CORRUGATED PLASTIC PIPE	26	LF	\$25.00	\$650.00	\$15.00	\$390.00
18	RPS	REMOVE EXISTING 24-INCH CORRUGATED PLASTIC PIPE	42	LF	\$25.00	\$1,050.00	\$15.00	\$630.00
19	RPS	REMOVE EXISTING SANITARY SEWER LINE (GRAVITY)	464	LF	\$18.00	\$8,352.00	\$10.00	\$4,640.00
20	RPS	REMOVE EXISTING SANITARY SEWER MANHOLE	1	EA	\$800.00	\$800.00	\$1,000.00	\$1,000.00
21	RPS	REMOVE EXISTING SANITARY SEWER LINE (FORCE MAIN)	1,021	LF	\$11.75	\$11,996.75	\$10.00	\$10,210.00
22	RPS	REMOVE EXISTING SANITARY SEWER RELIEF VALVE VAULT	1	EA	\$800.00	\$800.00	\$2,000.00	\$2,000.00
23	P-152	UNCLASSIFIED EXCAVATION	65,000	CY	\$10.00	\$650,000.00	\$12.00	\$780,000.00
24	P-152	UNSUITABLE EXCAVATION	4,000	CY	\$15.50	\$62,000.00	\$20.00	\$80,000.00
25	P-304	6-INCH THICK CEMENT-TREATED BASE COURSE	25,550	SY	\$26.00	\$664,300.00	\$25.00	\$638,750.00
26	P-304	PORTLAND CEMENT	650	TON	\$190.00	\$123,500.00	\$180.00	\$117,000.00
27	P-401	BITUMINOUS CONCRETE SURFACE COURSE	6,250	TON	\$153.25	\$957,812.50	\$150.00	\$937,500.00
28	P-602	BITUMINOUS PRIME COAT	7,500	GAL	\$6.35	\$47,625.00	\$5.00	\$37,500.00
29	P-603	BITUMINOUS TACK COAT	2,500	GAL	\$2.85	\$7,125.00	\$3.00	\$7,500.00
30	P-620	REMOVE EXISTING PAVEMENT MARKING	42,000	SF	\$1.55	\$65,100.00	\$4.00	\$168,000.00
31	P-620	AIRFIELD PAVEMENT MARKING (REFLECTORIZED AVIATION WHITE)	10,800	SF	\$1.30	\$14,040.00	\$2.00	\$21,600.00
32	P-620	AIRFIELD PAVEMENT MARKING (REFLECTORIZED AVIATION YELLOW)	3,000	SF	\$1.40	\$4,200.00	\$2.00	\$6,000.00
33	P-620	AIRFIELD PAVEMENT MARKING (NON-REFLECTORIZED BLACK)	13,550	SF	\$1.00	\$13,550.00	\$1.00	\$13,550.00
34	P-620	AIRFIELD PAVEMENT MARKING (REFLECTORIZED RED)	1,425	SF	\$2.10	\$2,992.50	\$5.00	\$7,125.00
35	P-620	AIRFIELD PAVEMENT MARKING (NON-REFLECTORIZED GREEN)	6,000	SF	\$0.90	\$5,400.00	\$4.00	\$24,000.00
36	P-620	AIRFIELD PAVEMENT MARKING (NON-REFLECTORIZED AVIATION YELLOW APPLIED AT HALF RATE)	3,200	SF	\$0.80	\$2,560.00	\$1.50	\$4,800.00
37	D-701	24" REINFORCED CONCRETE PIPE, CLASS III	252	LF	\$103.00	\$25,956.00	\$110.00	\$27,720.00
38	D-701	30" REINFORCED CONCRETE PIPE, CLASS III	815	LF	\$140.00	\$114,100.00	\$180.00	\$146,700.00
39	D-701	48" REINFORCED CONCRETE PIPE, CLASS III	860	LF	\$285.00	\$245,100.00	\$280.00	\$240,800.00
40	D-701	54" REINFORCED CONCRETE PIPE, CLASS III	478	LF	\$355.00	\$169,690.00	\$350.00	\$167,300.00

**BID TABULATION**  
**SCHEDULE A - RUNWAY 21 EXTENSION**  
**HILTON HEAD ISLAND AIRPORT**  
**TBE PROJECT NO. 2119-1006**  
AUGUST 18, 2016

BASE BID					QUALITY ENTERPRISES USA, INC. CHESAPEAKE, VA LICENSE NO.: 97783		Engineer's Estimate	
ITEM NO.	SPEC NO.	DESCRIPTION	QTY	UNIT	UNIT PRICE	EXT. TOTAL	UNIT PRICE	EXT. TOTAL
41	D-705	PAVEMENT EDGE STRIP DRAIN	4,250	LF	\$8.50	\$36,125.00	\$16.00	\$68,000.00
42	D-705	6-INCH PVC SUBGRADE UNDERDRAIN PIPE, SCHEDULE 80	2,375	LF	\$36.00	\$85,500.00	\$25.00	\$59,375.00
43	D-705	4-INCH PVC STRIP DRAIN COLLECTOR PIPE, SCHEDULE 80	1,335	LF	\$30.00	\$40,050.00	\$20.00	\$26,700.00
44	D-705	6-INCH PVC SUBGRADE UNDERDRAIN COLLECTOR PIPE, SCHEDULE 80	475	LF	\$36.00	\$17,100.00	\$25.00	\$11,875.00
45	D-705	4-INCH STRIP DRAIN CLEANOUT	11	EA	\$1,235.00	\$13,585.00	\$650.00	\$7,150.00
46	D-705	6-INCH SUBGRADE UNDERDRAIN CLEANOUT	4	EA	\$1,400.00	\$5,600.00	\$750.00	\$3,000.00
47	D-751	4' X 4' STORM DRAIN GRATE INLET	5	EA	\$4,100.00	\$20,500.00	\$3,800.00	\$19,000.00
48	D-751	5' X 5' STORM DRAIN JUNCTION BOX	1	EA	\$17,900.00	\$17,900.00	\$5,000.00	\$5,000.00
49	D-751	8' X 24' STORM DRAIN JUNCTION BOX	1	EA	\$46,000.00	\$46,000.00	\$40,000.00	\$40,000.00
50	D-751	LOWER EXISTING STORM DRAIN JUNCTION BOX	1	EA	\$2,100.00	\$2,100.00	\$2,500.00	\$2,500.00
51	D-752	CONCRETE PIPE COLLAR	3	EA	\$1,600.00	\$4,800.00	\$2,000.00	\$6,000.00
52	D-752	TRIPLE PIPE CONCRETE HEADWALL	1	EA	\$33,500.00	\$33,500.00	\$15,000.00	\$15,000.00
53	F-162	REMOVE EXISTING FENCE	1,365	LF	\$9.00	\$12,285.00	\$15.00	\$20,475.00
54	F-162	6-FOOT HIGH CHAIN LINK FENCE WITH 3 STRANDS BARBED WIRE	1,460	LF	\$34.00	\$49,640.00	\$26.00	\$37,960.00
55	L-105	REMOVE EXISTING GUIDANCE SIGN AND BASE	1	EA	\$710.00	\$710.00	\$1,500.00	\$1,500.00
56	L-105	REMOVE EXISTING GUIDANCE SIGN BASE	2	EA	\$595.00	\$1,190.00	\$500.00	\$1,000.00
57	L-105	REMOVE EXISTING TAXIWAY EDGE LIGHT	31	EA	\$150.00	\$4,650.00	\$75.00	\$2,325.00
58	L-105	REMOVE EXISTING RUNWAY EDGE LIGHT	20	EA	\$180.00	\$3,600.00	\$100.00	\$2,000.00
59	L-105	REMOVE EXISTING RUNWAY THRESHOLD LIGHT	16	EA	\$215.00	\$3,440.00	\$100.00	\$1,600.00
60	L-105	REMOVE EXISITNG 4-UNIT PAPI, COMPLETE	1	LS	\$3,550.00	\$3,550.00	\$2,000.00	\$2,000.00
61	L-108	CABLE TRENCH	14,875	LF	\$2.00	\$29,750.00	\$2.00	\$29,750.00
62	L-108	L-824 1/C, #8, 5kV, TYPE "C" CABLE	17,280	LF	\$1.55	\$26,784.00	\$1.25	\$21,600.00
63	L-108	1/C, #6 BARE COPPER COUNTERPOISE, INCLUDING GROUND RODS AND GROUND CONNECTORS	14,875	LF	\$2.10	\$31,237.50	\$1.50	\$22,312.50
64	L-110	2-INCH, SCHEDULE 40 PVC CONDUIT IN GRASSED AREAS	14,615	LF	\$3.40	\$49,691.00	\$4.00	\$58,460.00
65	L-110	2-INCH, SCHEDULE 40 PVC CONDUIT ENCASED IN CONCRETE	260	LF	\$30.00	\$7,800.00	\$4.00	\$1,040.00
66	L-110	4-INCH, 4-WAY CONCRETE ENCASED UNDERGROUND DUCT	1,275	LF	\$65.00	\$82,875.00	\$75.00	\$95,625.00
67	L-125	L-861T BASE MOUNTED MEDIUM INTENSITY TAXIWAY EDGE LIGHT - LED LAMP	108	EA	\$900.00	\$97,200.00	\$800.00	\$86,400.00
68	L-125	L-862 BASE MOUNTED MEDIUM INTENSITY LED RUNWAY EDGE LIGHT - YELLOW/CLEAR LENS	20	EA	\$1,900.00	\$38,000.00	\$2,000.00	\$40,000.00
69	L-125	L-862 BASE MOUNTED MEDIUM INTENSITY LED RUNWAY EDGE LIGHT - YELLOW/RED LENS	2	EA	\$2,135.00	\$4,270.00	\$2,000.00	\$4,000.00
70	L-125	L-862E BASE MOUNTED MEDIUM INTENSITY LED RUNWAY THRESHOLD LIGHT - RED/OBSCURED LENS	8	EA	\$2,000.00	\$16,000.00	\$2,000.00	\$16,000.00
71	L-125	L-862E BASE MOUNTED MEDIUM INTENSITY LED RUNWAY THRESHOLD LIGHT - RED/RED LENS	8	EA	\$2,000.00	\$16,000.00	\$2,000.00	\$16,000.00
72	L-125	FED IN-PAVEMENT MEDIUM INTENSITY LED RUNWAY THRESHOLD LIGHT - OBSCURED/GREEN LENS, STYLE 3, LOW PROFILE	6	EA	\$2,000.00	\$12,000.00	\$2,000.00	\$12,000.00
73	L-125	FED IN-PAVEMENT MEDIUM INTENSITY LED RUNWAY THRESHOLD LIGHT - YELLOW/GREEN LENS, STYLE 3, LOW PROFILE	2	EA	\$3,000.00	\$6,000.00	\$2,000.00	\$4,000.00
74	L-125	ELECTRICAL MANHOLE	22	EA	\$8,500.00	\$187,000.00	\$8,000.00	\$176,000.00

**BID TABULATION**  
**SCHEDULE A - RUNWAY 21 EXTENSION**  
**HILTON HEAD ISLAND AIRPORT**  
**TBE PROJECT NO. 2119-1006**  
AUGUST 18, 2016

BASE BID					QUALITY ENTERPRISES USA, INC. CHESAPEAKE, VA LICENSE NO.: 97783		Engineer's Estimate	
ITEM NO.	SPEC NO.	DESCRIPTION	QTY	UNIT	UNIT PRICE	EXT. TOTAL	UNIT PRICE	EXT. TOTAL
75	L-125	RELOCATE EXISTING AIRFIELD GUIDANCE SIGN WITH NEW CONCRETE PAD	2	EA	\$3,000.00	\$6,000.00	\$4,800.00	\$9,600.00
76	L-125	REPLACE EXISTING AIRFIELD GUIDANCE SIGN PANEL WITH NEW PANEL	2	EA	\$1,780.00	\$3,560.00	\$4,800.00	\$9,600.00
77	L-125	L-858, SIZE 1, STYLE 2, CLASS 2, AIRFIELD GUIDANCE SIGN (3 - 4 CHARACTERS)	10	EA	\$5,225.00	\$52,250.00	\$6,500.00	\$65,000.00
78	L-125	L-858, SIZE 1, STYLE 2, CLASS 2, AIRFIELD GUIDANCE SIGN (5 - 6 CHARACTERS)	3	EA	\$7,000.00	\$21,000.00	\$7,000.00	\$21,000.00
79	L-125	L-880 4-UNIT LED PAPI INSTALLATION, COMPLETE	1	LS	\$65,000.00	\$65,000.00	\$50,000.00	\$50,000.00
80	T-901	TEMPORARY SEEDING (MULCHED)	23	AC	\$1,480.00	\$34,040.00	\$2,000.00	\$46,000.00
81	T-901	PERMANENT SEEDING (MULCHED)	18	AC	\$2,000.00	\$36,000.00	\$3,000.00	\$54,000.00
82	M-103	CLOSED RUNWAY MARKER	2	EA	\$9,600.00	\$19,200.00	\$9,000.00	\$18,000.00
83	R-651	SECURITY FENCE SIGN	10	EA	\$650.00	\$6,500.00	\$325.00	\$3,250.00
84	PSD	RELOCATE EXISTING SANITARY SEWER MANHOLE	1	EA	\$2,200.00	\$2,200.00	\$7,500.00	\$7,500.00
85	PSD	10" PVC SANITARY SEWER FORCE MAIN	1,037	LF	\$42.00	\$43,554.00	\$60.00	\$62,220.00
86	PSD	10" 11.25-DEGREE RESTRAINED MJ BEND	3	EA	\$780.00	\$2,340.00	\$750.00	\$2,250.00
87	PSD	10" 30-DEGREE RESTRAINED MJ BEND	1	EA	\$1,100.00	\$1,100.00	\$750.00	\$750.00
88	PSD	10" 45-DEGREE RESTRAINED MJ BEND	2	EA	\$775.00	\$1,550.00	\$750.00	\$1,500.00
89	PSD	CONCRETE THRUST BLOCKING, ANY SIZE	6	EA	\$450.00	\$2,700.00	\$1,000.00	\$6,000.00
90	PSD	FORCE MAIN AIR RELEASE VALVE AND VAULT, COMPLETE	1	LS	\$7,935.00	\$7,935.00	\$8,000.00	\$8,000.00
91	PSD	SANITARY SEWER FORCE MAIN IN-LINE CONNECTION	1	EA	\$2,670.00	\$2,670.00	\$2,500.00	\$2,500.00

**TOTAL SCHEDULE A BID AMOUNT**

**\$5,496,643.75 \***

**\$5,841,927.50**

\* DENOTES MATH ERROR

**BID TABULATION**  
**SCHEDULE B - TAXIWAY 'F' INFIELD DRAINAGE IMPROVEMENTS**  
**HILTON HEAD ISLAND AIRPORT**  
**TBE PROJECT NO. 2119-1006**  
AUGUST 18, 2016

BASE BID					QUALITY ENTERPRISES USA, INC. CHESAPEAKE, VA LICENSE NO.: 97783		Engineer's Estimate	
ITEM NO.	SPEC NO.	DESCRIPTION	QTY	UNIT	UNIT PRICE	EXT. TOTAL	UNIT PRICE	EXT. TOTAL
1	GP105	MOBILIZATION	1	LS	\$428,000.00	\$428,000.00	\$500,000.00	\$500,000.00
2	02374	TEMPORARY CONSTRUCTION ENTRANCE	2	EA	\$2,100.00	\$4,200.00	\$3,000.00	\$6,000.00
3	02374	TEMPORARY SILT FENCE	6,000	LF	\$3.50	\$21,000.00	\$4.00	\$24,000.00
4	02374	TEMPORARY SEDIMENT TUBE CHECK DAMS	6	EA	\$105.00	\$630.00	\$250.00	\$1,500.00
5	02374	TEMPORARY SEDIMENT BASIN WITH SKIMMER	2	EA	\$12,185.00	\$24,370.00	\$16,000.00	\$32,000.00
6	02374	TYPE 'A' INLET PROTECTION	10	EA	\$190.00	\$1,900.00	\$500.00	\$5,000.00
7	02374	TEMPORARY WOOD RISER INLET PROTECTION	13	EA	\$1,190.00	\$15,470.00	\$500.00	\$6,500.00
8	RPS	REMOVE EXISTING GRATE INLET	2	EA	\$1,000.00	\$2,000.00	\$50.00	\$100.00
9	RPS	REMOVE EXISTING STORM DRAIN MANHOLE	2	EA	\$1,000.00	\$2,000.00	\$1,000.00	\$2,000.00
10	RPS	REMOVE EXISTING 36-INCH CONCRETE PIPE	371	LF	\$25.00	\$9,275.00	\$30.00	\$11,130.00
11	RPS	REMOVE EXISTING 48-INCH CONCRETE PIPE	652	LF	\$35.00	\$22,820.00	\$18.00	\$11,736.00
12	RPS	REMOVE EXISTING 54-INCH CONCRETE PIPE	80	LF	\$55.00	\$4,400.00	\$25.00	\$2,000.00
13	P-152	UNCLASSIFIED EXCAVATION	27,000	CY	\$11.00	\$297,000.00	\$15.00	\$405,000.00
14	P-152	UNSUITABLE EXCAVATION	4,300	CY	\$15.50	\$66,650.00	\$15.00	\$64,500.00
15	P-209	CRUSHED AGGREGATE BASE COURSE	165	CY	\$115.00	\$18,975.00	\$150.00	\$24,750.00
16	P-401	BITUMINOUS CONCRETE SURFACE COURSE	1,470	TON	\$153.25	\$225,277.50	\$200.00	\$294,000.00
17	P-602	BITUMINOUS PRIME COAT	1,955	GAL	\$6.35	\$12,414.25	\$5.00	\$9,775.00
18	P-603	BITUMINOUS TACK COAT	590	GAL	\$2.85	\$1,681.50	\$3.00	\$1,770.00
19	P-620	AIRFIELD PAVEMENT MARKING (REFLECTORIZED AVIATION WHITE)	25	SF	\$5.35	\$133.75	\$3.00	\$75.00
20	P-620	AIRFIELD PAVEMENT MARKING (REFLECTORIZED AVIATION YELLOW)	235	SF	\$2.50	\$587.50	\$3.00	\$705.00
21	P-620	AIRFIELD PAVEMENT MARKING (NON-REFLECTORIZED BLACK)	650	SF	\$1.55	\$1,007.50	\$2.00	\$1,300.00
22	D-701	12" HDPE DOUBLE WALL CORRUGATED PIPE	330	LF	\$44.00	\$14,520.00	\$15.00	\$4,950.00
23	D-701	18" HDPE DOUBLE WALL CORRUGATED PIPE	876	LF	\$52.00	\$45,552.00	\$25.00	\$21,900.00
24	D-701	18" REINFORCED CONCRETE PIPE, CLASS III	56	LF	\$105.00	\$5,880.00	\$90.00	\$5,040.00
25	D-701	36" REINFORCED CONCRETE PIPE, CLASS III	2,575	LF	\$200.00	\$515,000.00	\$200.00	\$515,000.00
26	D-701	48" REINFORCED CONCRETE PIPE, CLASS III	2,360	LF	\$300.00	\$708,000.00	\$280.00	\$660,800.00
27	D-701	12" HDPE TEE FITTING	20	EA	\$285.00	\$5,700.00	\$225.00	\$4,500.00
28	D-701	12" HDPE 90-DEGREE BEND	20	EA	\$245.00	\$4,900.00	\$75.00	\$1,500.00
29	D-701	18" HDPE TEE FITTING	6	EA	\$1,000.00	\$6,000.00	\$50.00	\$300.00
30	D-701	18" HDPE 90-DEGREE BEND	6	EA	\$605.00	\$3,630.00	\$125.00	\$750.00
31	D-751	4' X 4' STORM DRAIN GRATE INLET	11	EA	\$4,400.00	\$48,400.00	\$3,800.00	\$41,800.00
32	D-751	4' X 4' STORM DRAIN JUNCTION BOX	2	EA	\$6,000.00	\$12,000.00	\$8,000.00	\$16,000.00
33	D-751	5' X 5' STORM DRAIN JUNCTION BOX	7	EA	\$6,740.00	\$47,180.00	\$9,000.00	\$63,000.00
34	D-751	6' X 6' STORM DRAIN JUNCTION BOX	8	EA	\$17,450.00	\$139,600.00	\$20,000.00	\$160,000.00
35	D-751	4' X 10' STORM DRAIN GRATE INLET	8	EA	\$18,700.00	\$149,600.00	\$20,000.00	\$160,000.00
36	D-751	4' X 10' STORM DRAIN EMERGENCY OVERFLOW BOX	1	EA	\$13,125.00	\$13,125.00	\$18,000.00	\$18,000.00
37	D-751	6' X 10' STORM DRAIN EMERGENCY OVERFLOW BOX	1	EA	\$15,900.00	\$15,900.00	\$22,000.00	\$22,000.00
38	D-751	5'-6" X 6' OUTLET CONTROL STRUCTURE	1	EA	\$19,500.00	\$19,500.00	\$14,000.00	\$14,000.00
39	D-751	6' X 10' OUTLET CONTROL STRUCTURE	1	EA	\$32,000.00	\$32,000.00	\$30,000.00	\$30,000.00
40	L-105	REMOVE EXISTING TAXIWAY EDGE LIGHT	1	EA	\$950.00	\$950.00	\$75.00	\$75.00
41	L-108	CABLE TRENCH	100	LF	\$12.00	\$1,200.00	\$2.00	\$200.00
42	L-108	L-824 1/C, #8, 5kV, TYPE "C" CABLE	135	LF	\$9.00	\$1,215.00	\$5.00	\$675.00
43	L-108	1/C, #6 BARE COPPER COUNTERPOISE, INCLUDING GROUND RODS AND GROUND CONNECTORS	90	LF	\$12.00	\$1,080.00	\$6.00	\$540.00
44	L-110	2-INCH, SCHEDULE 40 PVC CONDUIT IN GRASSED AREAS	90	LF	\$8.30	\$747.00	\$4.00	\$360.00

**BID TABULATION**  
**SCHEDULE B - TAXIWAY 'F' INFIELD DRAINAGE IMPROVEMENTS**  
**HILTON HEAD ISLAND AIRPORT**  
**TBE PROJECT NO. 2119-1006**  
AUGUST 18, 2016

BASE BID					QUALITY ENTERPRISES USA, INC. CHESAPEAKE, VA LICENSE NO.: 97783		Engineer's Estimate	
ITEM NO.	SPEC NO.	DESCRIPTION	QTY	UNIT	UNIT PRICE	EXT. TOTAL	UNIT PRICE	EXT. TOTAL
45	L-110	4-INCH, 4-WAY CONCRETE ENCASED UNDERGROUND DUCT	44	LF	\$89.00	\$3,916.00	\$75.00	\$3,300.00
46	L-125	ELECTRICAL MANHOLE	2	EA	\$10,500.00	\$21,000.00	\$8,000.00	\$16,000.00
47	L-125	L-858, SIZE 1, STYLE 2, CLASS 2, AIRFIELD GUIDANCE SIGN (3 - 4 CHARACTERS)	1	EA	\$7,400.00	\$7,400.00	\$4,800.00	\$4,800.00
48	R-651	36-INCH WIDE, TYPE E STOP SIGN WITH CONTACT ATC SIGN	19	SF	\$42.00	\$798.00	\$100.00	\$1,900.00
49	SPEC.	UNDERGROUND ARCH DETENTION SYSTEM, INCLUDING ALL APPURTENANCES	150,000	CF	\$10.40	\$1,560,000.00	\$10.00	\$1,500,000.00
50	SPEC.	VIDEO INSPECTION - EXISTING 54" RCP	480	LF	\$62.00	\$29,760.00	\$80.00	\$38,400.00
51	CIPP	CIPP SLIP LINE EXISTING 54" RCP	480	LF	\$430.00	\$206,400.00	\$500.00	\$240,000.00
52	T-901	TEMPORARY SEEDING (MULCHED)	25	AC	\$1,480.00	\$37,000.00	\$2,000.00	\$50,000.00
53	T-901	PERMANENT SEEDING (MULCHED)	25	AC	\$2,000.00	\$50,000.00	\$3,000.00	\$75,000.00

<b>TOTAL SCHEDULE B BID AMOUNT</b>	<b>\$4,867,745.00</b>	<b>\$5,074,631.00</b>
<b>TOTAL SCHEDULE A BID AMOUNT</b>	<b>\$5,496,643.75</b>	<b>\$5,841,927.50</b>
<b>TOTAL SCHEDULE A AND SCHEDULE B AMOUNTS</b>	<b>\$10,364,388.75</b>	<b>\$10,916,558.50</b>
DBE SUBCONTRACTOR AMOUNT	\$639,437.00	
DBE PERCENTAGE OF TOTAL BID AMOUNT	6.17%	

I HEREBY CERTIFY THIS TABULATION OF BIDS TO BE CORRECT.

TALBER, BRIGHT & ELLINGTON, INC.

8/22/2016  
DATE

**HILTON HEAD ISLAND AIRPORT  
HILTON HEAD ISLAND, SOUTH CAROLINA  
WORK AUTHORIZATION 16-02  
October 6, 2016  
PROJECT NO.: TBI NO. 2119-1602**

It is agreed to undertake the following work in accordance with the provisions of our Contract for Professional Services.

---

**Description of Work Authorized:** Construction administration services and inspection for the Extension of Runway 21 and Taxiways ‘A’ and ‘F’, Taxiway ‘F’ Infield Drainage Improvements, removal of trees along the west side of the Airport in various locations, re-alignment of the existing Hilton Head PSD sewer force main, and the demolition of the structures at 154 Beach City Road and 160 Beach City Road. Services in include:

- **Construction Administration** – this includes providing professional construction contract administration services during the construction contract. This includes conduct Preconstruction Conference and transmit meeting minutes, review of submittals/shop drawings, site visits during construction, conduct progress meetings and transmit meeting minutes, answer questions and review Contractor change requests during construction, process Contractor pay requests during construction, conduct final inspection and transmit punch list items, prepare record drawings and coordinate final improvements with FAA, final Engineer’s Report, project closeout documents.
- **Quality Assurance Testing** – this includes subconsultant providing materials testing services required by the FAA during construction for quality assurance and acceptance. This primarily includes testing of soils for moisture and compaction, compressive strength of concrete placed during construction, testing of crushed aggregate base course for moisture and compaction, and testing of asphalt pavements.
- **Resident Project Representative** – this includes providing resident project representative (construction observation) services required by the FAA during construction. This primarily includes providing a full-time resident construction observer while the Contractor is onsite working to observe the Contractor’s work activities and finished work. This project also has nighttime runway closures from 9pm-6am for all work within the runway safety area. A second-shift resident construction observer will be present when the Contractor is working during these scheduled nighttime runway closures to observe the Contractor’s work activities and finished work, and to verify that the runway can be re-opened to air traffic each morning after a scheduled runway closure. The resident construction

observer will also verify quantities of completed work by the Contractor that are eligible for inclusion on each Contractor pay request.

- **Phase I 18B Survey** – this includes one survey completed in accordance with FAA AC 150/5300-18B. This survey will be an as-built survey of the approach surfaces (20:1 and 30:1 combination to the proposed Runway 21 and Runway 3 landing thresholds) for new instrument approach procedure development by the FAA Flight procedures office. An AutoCAD file will be provided of the completed as-built survey and the required statement of work, imagery files, and data files will be uploaded upon completion to the FAA AGIS website in accordance with FAA AC 5300-18B.

**Estimated Time Schedule:** Work shall be completed in accordance with the schedule established and agreed upon by the Owner and Engineer.

**Cost of Services:** The method of payment shall be in accordance with Article 6 of the Master Contract. The basic services work shall be performed in accordance with the Master Contract as a lump sum of **\$182,066.05**, which includes reimbursable expenses. Special Additional Services shall be performed as listed below with a budget of **\$881,538.00**. The total value of this Work Authorization shall not exceed **\$1,063,604.05** without additional authorization

**Agreed as to Scope of Services, Time Schedule and Budget:**

**APPROVED:**  
BEAUFORT COUNTY

**APPROVED:**  
TALBERT, BRIGHT & ELLINGTON,  
INC.

\_\_\_\_\_  
Title

\_\_\_\_\_  
Vice President  
Title:

\_\_\_\_\_  
Date:

\_\_\_\_\_  
Date:

\_\_\_\_\_  
Witness:

\_\_\_\_\_  
Witness:

---

Talbert, Bright & Ellington, Inc.

Work Authorization 2119-1602



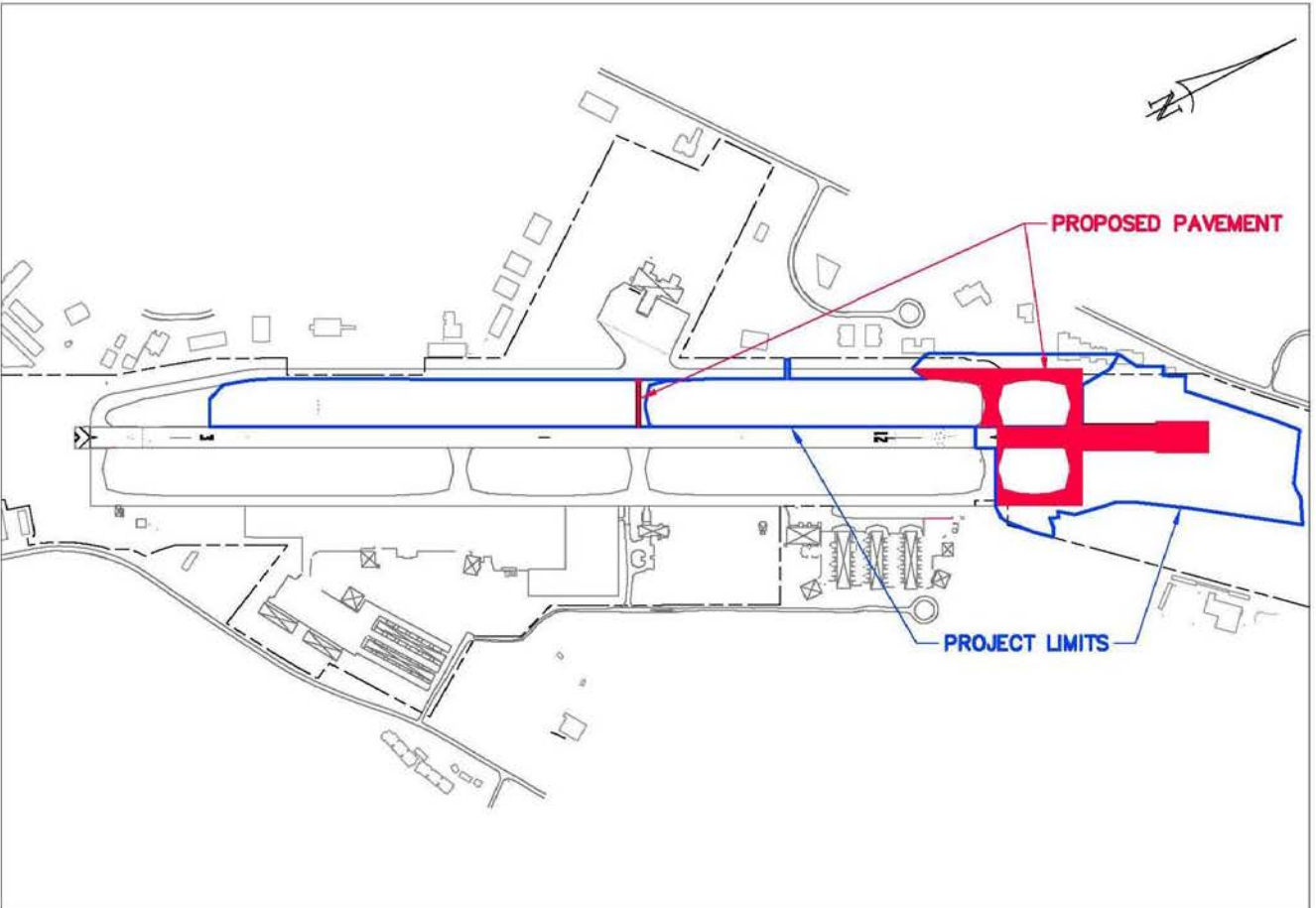

**SUMMARY OF FEES**  
**RUNWAY 21 EXTENSION SCHEDULES A AND B COMBINED**  
HILTON HEAD ISLAND AIRPORT  
HILTON HEAD ISLAND, SOUTH CAROLINA

AIP GRANT 3-45-0030-039-2016  
CLIENT PROJECT NO:  
TBI PROJECT NO. 2119-1602

October 6, 2016

DESCRIPTION	ESTIMATED COST
<b>BASIC SERVICES</b>	
CONSTRUCTION ADMINISTRATION PHASE (06)	\$ 162,565.00
<b>SPECIAL SERVICES</b>	
EXPENSES	\$ 19,501.05
RESIDENT PROJECT REPRESENTATIVE - NTE	\$ 525,728.00
<u>SUBCONSULTANTS</u>	
QUALITY ASSURANCE TESTING - NTE	\$ 279,910.00
PHASE I 18B SURVEY - NTE	\$ 75,900.00
SPECIAL SERVICES SUBTOTAL	\$ 901,039.05
<b>TOTAL CONSTRUCTION PHASE</b>	<b>\$ 1,063,604.05</b>

MANHOUR ESTIMATE  
 RUNWAY 21 EXTENSION SCHEDULES A AND B COMBINED  
 HILTON HEAD ISLAND AIRPORT  
 HILTON HEAD ISLAND, SOUTH CAROLINA

AIP GRANT 3-45-0030-039-2016  
 CLIENT PROJECT NO:  
 TBI PROJECT NO. 2119-1602

October 6, 2016

CONSTRUCTION ADMINISTRATION PHASE (06)

DESCRIPTION	PRIN	PM	E6	E4	E1	T5	AD5
	\$ 175	\$ 164	\$ 147	\$ 112	\$ 72	\$ 98	\$ 76
Develop project scope/contract	4	6	0	0	0	0	2
Prepare contract docs and RFC plans	0	5	16	0	0	12	16
Coordinate award of contract	2	6	0	0	0	0	2
Coordinate with subconsultants	4	24	8	0	0	4	16
Coord./conduct precon conf.	0	10	0	0	0	0	2
Precon minutes	0	4	0	0	0	0	2
Coordinate/review project schedule	4	4	0	0	0	0	0
Coordinate/review submittals	0	48	24	0	0	0	12
Construction visits/Progress Mtgs	24	264	24	0	0	0	16
Construction reports/Mtg Minutes	5	78	8	0	0	0	12
Review/coordinate field changes	12	34	24	0	0	12	16
Review QA Test Results/Invoices	2	44	0	0	0	0	7
Construction correspondence	16	66	16	0	0	0	16
Process requests for partial payment	0	52	0	0	0	0	12
Final inspection/punchlist	2	10	0	0	0	0	4
Final Engineer's Report	0	8	4	0	0	0	4
Develop record drawings	0	16	32	0	0	36	2
<b>MANHOUR TOTAL</b>	<b>71</b>	<b>673</b>	<b>156</b>	<b>0</b>	<b>0</b>	<b>64</b>	<b>139</b>

DIRECT LABOR EXPENSES:

CLASSIFICATION		BILL RATE	EST MHRS	EST COST
Principal	PRIN	\$ 175	71	\$ 12,425
Project Manager	PM	\$ 164	673	\$ 110,372
Engineer VI	E6	\$ 147	156	\$ 22,932
Engineer IV	E4	\$ 112	0	\$ -
Engineer I	E1	\$ 72	0	\$ -
Technician V	T5	\$ 98	64	\$ 6,272
Admin. Assistant V	AD5	\$ 76	139	\$ 10,564
		Total	1,103	
<b>SUBTOTAL</b>				<b>\$ 162,563.00</b>

DIRECT EXPENSES:

EXPENSE DESCRIPTION	UNIT	UNIT RATE	EST UNITS	EST COST
Postage	LS	\$ 200	2	\$ 400.00
Copying	LS	\$ 500	2	\$ 1,000.00
Reproduction-Rel. for Const.	LS	\$ 1,000	2	\$ 2,000.00
Reproduction-As Built	LS	\$ 500	2	\$ 1,000.00
Miscellaneous expenses (prints, faxes, copies)	LS	\$ 200	2	\$ 400.00
Hotel	LS	\$ 150	39	\$ 5,850.00
Mileage	MI	0.445	19,890	\$ 8,851.05
<b>SUBTOTAL</b>				<b>\$ 19,501.05</b>

SCOPE OF SUBCONTRACTED SERVICES:

EXPENSE DESCRIPTION	UNIT RATE	EST UNITS	EST COST
Quality Assurance Testing - NTE	\$279,910.00	1	\$ 279,910.00
Phase I 18B Survey - NTE	\$75,900.00	1	\$ 75,900.00
<b>SUBTOTAL</b>			<b>\$ 355,810.00</b>

**TOTAL PHASE 6: \$ 537,876.05**

MANHOUR ESTIMATE  
 RUNWAY 21 EXTENSION SCHEDULES A AND B COMBINED  
 HILTON HEAD ISLAND AIRPORT  
 HILTON HEAD ISLAND, SOUTH CAROLINA

AIP GRANT 3-45-0030-039-2016  
 CLIENT PROJECT NO:  
 TBI PROJECT NO. 2119-1602

October 6, 2016

RESIDENT PROJECT REPRESENTATIVE (PHASE 51)  
 CONTRACT TIME CALENDAR DAYS: 255

DESCRIPTION	RPR
	\$ 80
Project review/Preconstruction Conference	10
Site mobilization	4
On site inspection	4,970
Final inspection	10
Follow up inspection	336
Site demobilization	4
<b>MANHOUR TOTAL</b>	<b>5,334</b>

DIRECT LABOR EXPENSES:

CLASSIFICATION		BILL RATE		EST MHRS		EST COST
RESIDENT ENGINEER	RPR	\$	80	5,334	\$	426,720
			Total	5,334		
<u>SUBTOTAL</u>						\$ 426,720.00

DIRECT EXPENSES:

EXPENSE DESCRIPTION	UNIT	UNIT RATE		EST UNITS		EST COST
Telephone	LS	\$	-	0	\$	-
Postage	LS	\$	-	0	\$	-
Miscellaneous expenses (prints, faxes, copies)	LS	\$	-	0	\$	-
Travel	LS	\$	-	0	\$	-
<u>SUBTOTAL</u>						\$ -

PER DIEM:

EXPENSE DESCRIPTION	UNIT	UNIT RATE		EST UNITS		EST COST
DAILY PER DIEM	PD	\$	208	476	\$	99,008
			Total	476		
<u>SUBTOTAL</u>						\$ 99,008.00
<b>TOTAL PHASE 51:</b>						<b>\$ 525,728.00</b>



# Hilton Head Island Airport

Fly to the Fun

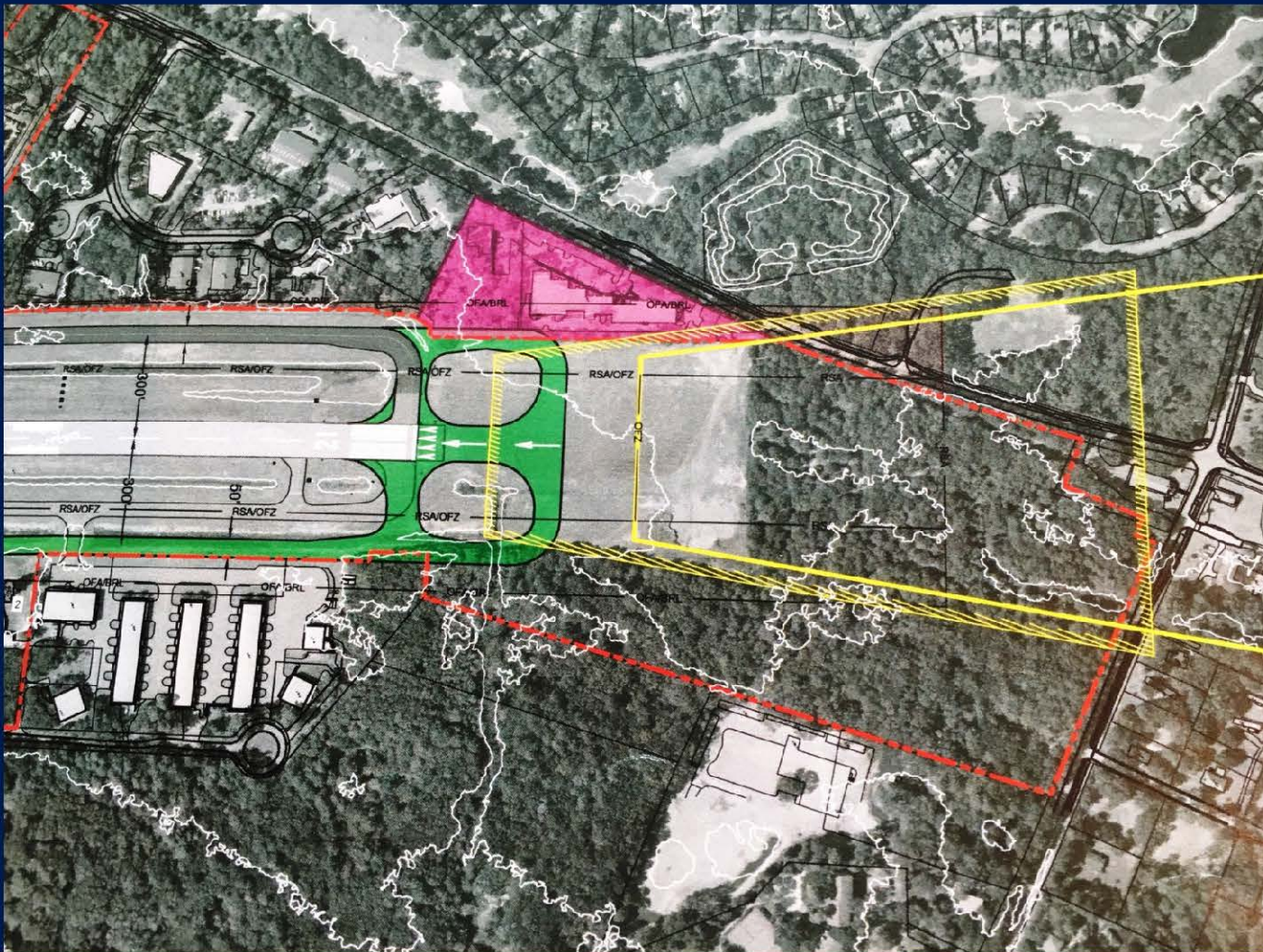

# Hilton Head Island Airport

Fly to the Fun



# Hilton Head Island Airport

**Fly to the Fun**



# Hilton Head Island Airport

Fly to the Fun



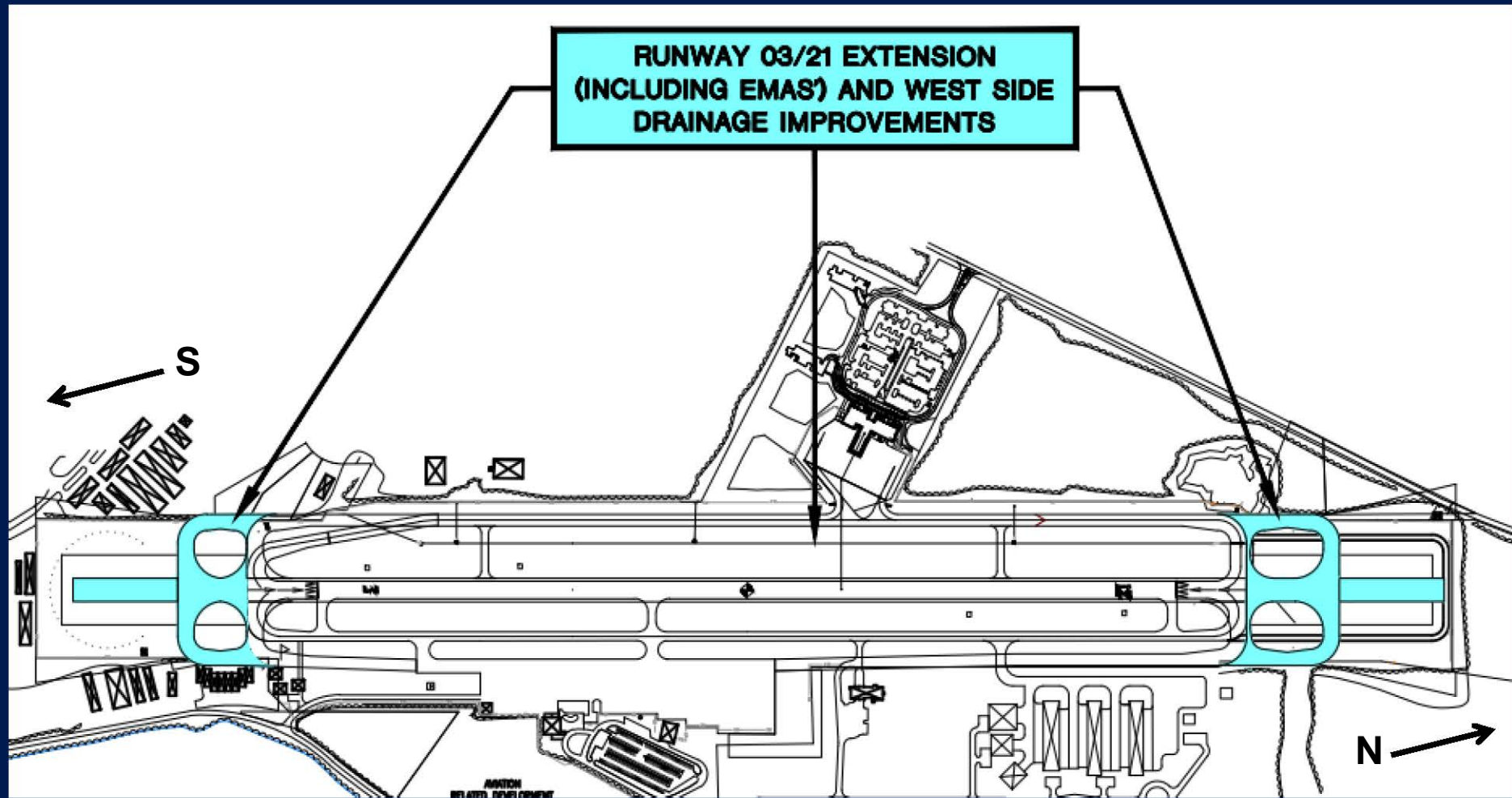

# Hilton Head Island Airport

**Fly to the Fun**



Arthur J. Gallagher & Co.  
BUSINESS WITHOUT BARRIERS™

# Beaufort County

## Classification & Compensation Study

### Preliminary Report

RONNIE CHARLES | OCTOBER 2016



# Table of Contents

- Project Summary
- Classification and Compensation Strategy
- Classification Study
- Job Evaluation Study
- Compensation Study
- Recommendations

# Project Summary

- Beaufort County contracted with Arthur J. Gallagher Human Resources & Compensation Consulting to conduct a classification and compensation study covering all County classifications.
- The objectives of the study were to:
  - Develop an updated classification structure and position descriptions
  - Evaluate all classifications to ensure internal equity
  - Assign jobs to the correct pay grade based on duties and responsibilities
  - Collect market salary and organizational data
  - Develop a salary structure that is internally equitable and externally competitive

# Project Summary

- The project consisted of five phases:
  - Classification and compensation strategy
  - Classification study
  - Job evaluation study
  - Compensation study
  - Final report

# Classification and Compensation Strategy

- Presented project to employees and management
- Reviewed current systems to understand issues and needs
- Developed the approach and strategy for the project, which included:
  - Moderately broad classification structure
  - Use of the Decision Band™ Method (DBM) job evaluation methodology
  - Use of market salary and organizational data from comparable local and regional organizations representing the public and private sector

# Classification Study

- Reviewed all position description questionnaires (PDQs) completed by County employees
- Interviewed County leadership and selected employees to:
  - Understand classification concerns
  - Ensure our understanding of the functional area, levels of responsibilities, and job duties
- Developed a classification structure covering all County positions that included:
  - Classification Series
  - Classification Titles
  - Levels within each Classification Series
  - DBM Grade
  - Nature of Work
  - Minimum Qualifications
- 149 classifications were created for all County positions, reduced from 266 unique job titles

# Classification Study

- The PDQs were continually referenced as the basis for the analysis.
- The classification structure and allocation of employees have been reviewed with County leadership for feedback.



# Job Evaluation Study

- Apply a job evaluation methodology to all jobs for:
  - Internal equity
  - Assignment to pay grades
  - Allocation of employees to correct job titles and pay grade
- Purpose of Job Evaluation
  - Establishes a job value hierarchy
  - Helps to grade a new or changed job
- Evaluate all proposed job classifications utilizing the Decision Band™ Method under the primary criteria:
  - Decision making
  - Supervision
  - Complexity and difficulty of job responsibilities

# Job Evaluation Study

## Step 1: Determine appropriate band

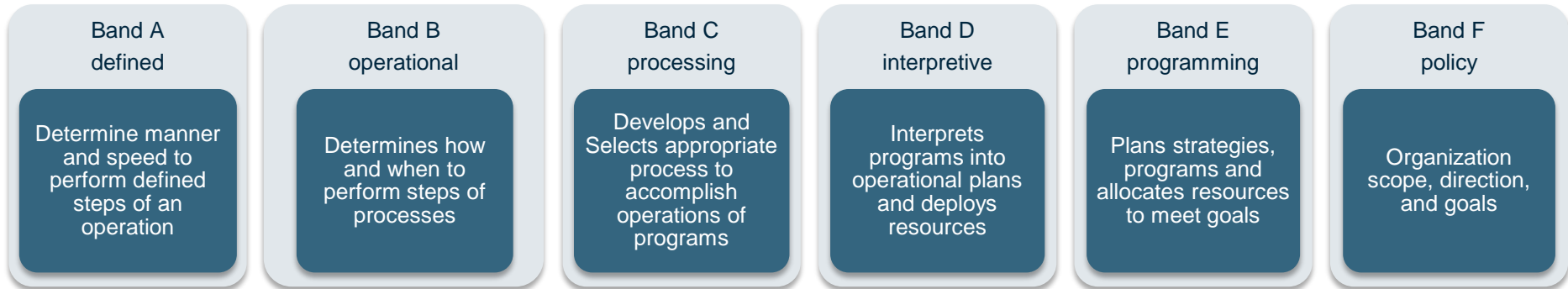

## Step 2: Determine appropriate grade

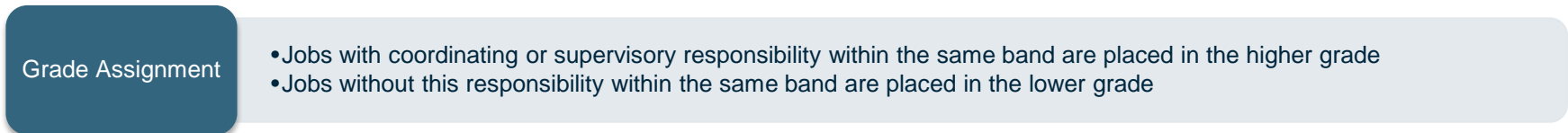

## Step 3: Determine appropriate subgrade

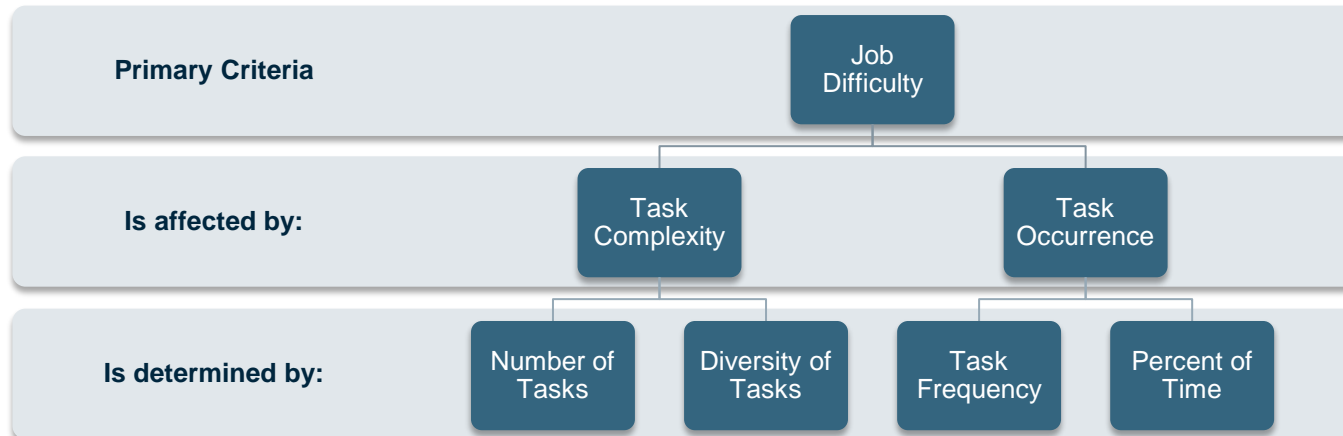

# Compensation Study – Survey Process

- Select benchmarks – Identified 46 classifications among the proposed 149 classifications (meets the 30% of job titles with market data requirement for a valid salary structure).
- Developed a customized data collection instrument
- The Data Collection Form was distributed to comparable organizations in the South Carolina and northeast Georgia area.
- Follow-up calls and emails were made to encourage survey participation.

# Compensation Study – Market Data

- In addition to the custom survey, we collected market data from published survey sources and local governments for the 45 positions:
  - Towers Watson Surveys
  - Mercer Surveys
  - Economic Research Institute
  - MRA Salary Surveys
- The positions from the survey sources that we matched to the benchmarks reflected at least 70% of the duties as outlined in the classification summaries
- We referenced market data from the closest geographic area and comparable government or public sector data cuts
- Salary data were adjusted for the Beaufort, SC labor market using data from the Economic Research Institute Geographic Assessor, and aged to January 1, 2017.

# Compensation Study – Survey Process

NO.	BENCHMARK TITLE	NO.	BENCHMARK TITLE
1.	Administrative Clerk	27.	Librarian
2.	Administrative Assistant	28.	Finance Clerk
3.	Administrative Supervisor	29.	GIS Analyst
4.	Finance Assistant	30.	Assessing Technician
5.	Administrative Specialist	31.	Custodian
6.	IT Technician	32.	Senior Recreation Supervisor
7.	Risk Manager	33.	Training Specialist
8.	Risk Management Safety Coordinator	34.	Emergency Medical Technician
9.	Maintenance Worker	35.	Solid Waste Attendant
10.	Animal Services Technician	36.	Solid Waste Foreman
11.	Employee Services Director	37.	Maintenance Technician
12.	Employee Services Specialist	38.	Maintenance Supervisor
13.	Deputy County Administrator	39.	Human Services Manager
14.	Recreation Supervisor	40.	Correctional Officer
15.	Finance Supervisor	41.	Equipment Operator (CDL)
16.	Recreation Aide	42.	Codes Enforcement Officer
17.	Assessing Specialist	43A.	Maintenance Specialist
18.	Purchasing Director	43B.	Maintenance Specialist - Electrician (Journeyman)
19.	Library Director	43C.	Maintenance Specialist - Plumber (Journeyman)
20.	IT Analyst	43D.	Maintenance Specialist - HVAC (Journeyman)
21.	Human Services Analyst	43E.	Maintenance Specialist - Carpenter (Journeyman)
22.	Engineer	43F.	Maintenance Specialist - Locksmith
23.	Court Services Assistant	43G.	Maintenance Specialist - Painter
24.	Correctional Corporal	44.	Chief Finance Officer
25.	Paramedic	45.	Division Director - Engineering and Infrastructure
26.	Library Manager	46.	Division Director - Public Safety

# Compensation Study – Survey Process

- The survey was distributed to these 25 organizations:

No.	Comparator Organizations	No.	Comparator Organizations
1.	<b>Berkeley County, SC*</b>	14.	<b>Hilton Head Island, SC*</b>
2.	<b>Charleston County, SC*</b>	15.	Mount Pleasant, SC
3.	<b>Dorchester County, SC*</b>	16.	Summerville, SC
4.	<b>Georgetown County, SC*</b>	17.	Savannah, GA
5.	Horry County, SC	18.	Pooler, GA
6.	<b>Greenville County, SC*</b>	19.	Pooler-Burroughs, GA
7.	Spartanburg County, SC	20.	<b>Bluffton, SC*</b>
8.	Sumpter County, SC	21.	Beaufort County Schools
9.	<b>York County, SC*</b>	22.	<b>Technical College of the Low Country*</b>
10.	<b>Chatham County, GA*</b>	23.	<b>State of South Carolina*</b>
11.	Effingham County, GA	24.	University of South Carolina
12.	<b>North Charleston, SC*</b>	25.	Beaufort Memorial Hospital
13.	<b>Columbia, SC*</b>		

- We received completed surveys from 13 organizations in bold, which meets our 50% participation goal.

# Compensation Study – Survey Process

- We asked the participants to match those jobs that reflected at least 70% of the duties as outlined in the benchmark summaries.
- We compiled, reviewed and entered the data collected from participants.
- We followed-up directly with the participants to clarify and validate missing or questionable information reported.

# Compensation Study – Market Data

- We follow the U.S. Department of Justice and Federal Trade Commission guidelines that state five job matches should exist per job in order to conduct statistical analyses or for drawing conclusions.
- Data collected for all but 9 positions matched this criteria
- The positions which lacked sufficient data from the custom survey included:
  - Recreation Supervisor
  - Recreation Aide
  - Library Director
  - Human Services Analyst
  - Library Manager
  - Librarian
  - Assessing Technician
  - Training Specialist
  - Human Services Manager
- In addition, we did not find sufficient data for the maintenance specialties of Plumber, Carpenter, Locksmith, and Painter.



# Compensation Study – Market Data

- Through the additional data in the published survey sources, we found sufficient market data for all benchmark positions and maintenance specialties.

# Compensation Study – Market Data

- For each benchmark comparison, the percentage difference has been calculated between the County actual/average pay and the market in terms of the County's salary:
  - Positive (+) figure indicates that the County pays above the market
  - Negative (-) figure indicates that the County pays below the market
- The following guidelines are used when determining the competitive nature of current actual compensation:
  - +/- 5% (Highly Competitive)
  - +/- 10% (Competitive)
  - +/- 11-15% (Possible misalignment with the market)
  - > 15% (Significant misalignment with the market)

# Compensation Study – Market Data

- Overall comparison between the County and the market:

Compared to the Market	Custom Survey 50 <sup>th</sup> Percentile	Published Surveys 50 <sup>th</sup> Percentile	Combined 50 <sup>th</sup> Percentile
	-9.0%	-8.2%	-9.1%

- The County's actual salary is considered Competitive with the target market of the 50<sup>th</sup> percentile.
- Based on the consistency of the results, we recommend the County utilize the combined market 50<sup>th</sup> percentile as the basis for the new salary structure. This will ensure competitiveness with the public and private sector labor markets.

# Compensation Study – Salary Structure

- We combined the market data with the DBM evaluations to develop a salary structure through regression analysis.
- The following graph shows the scatter of the salary rates for the benchmark jobs including the two data sets:
  - County's actual salary
  - Market 50<sup>th</sup> Salary Rate
- The trend line (line of best fit) of each data set provides a visual recognition of the overall difference between the County's actual pay and the market salary rate, which confirms the high competitiveness of the County's overall actual pay to the market 50<sup>th</sup> percentile salary rate.

# Compensation Study – Salary Structure

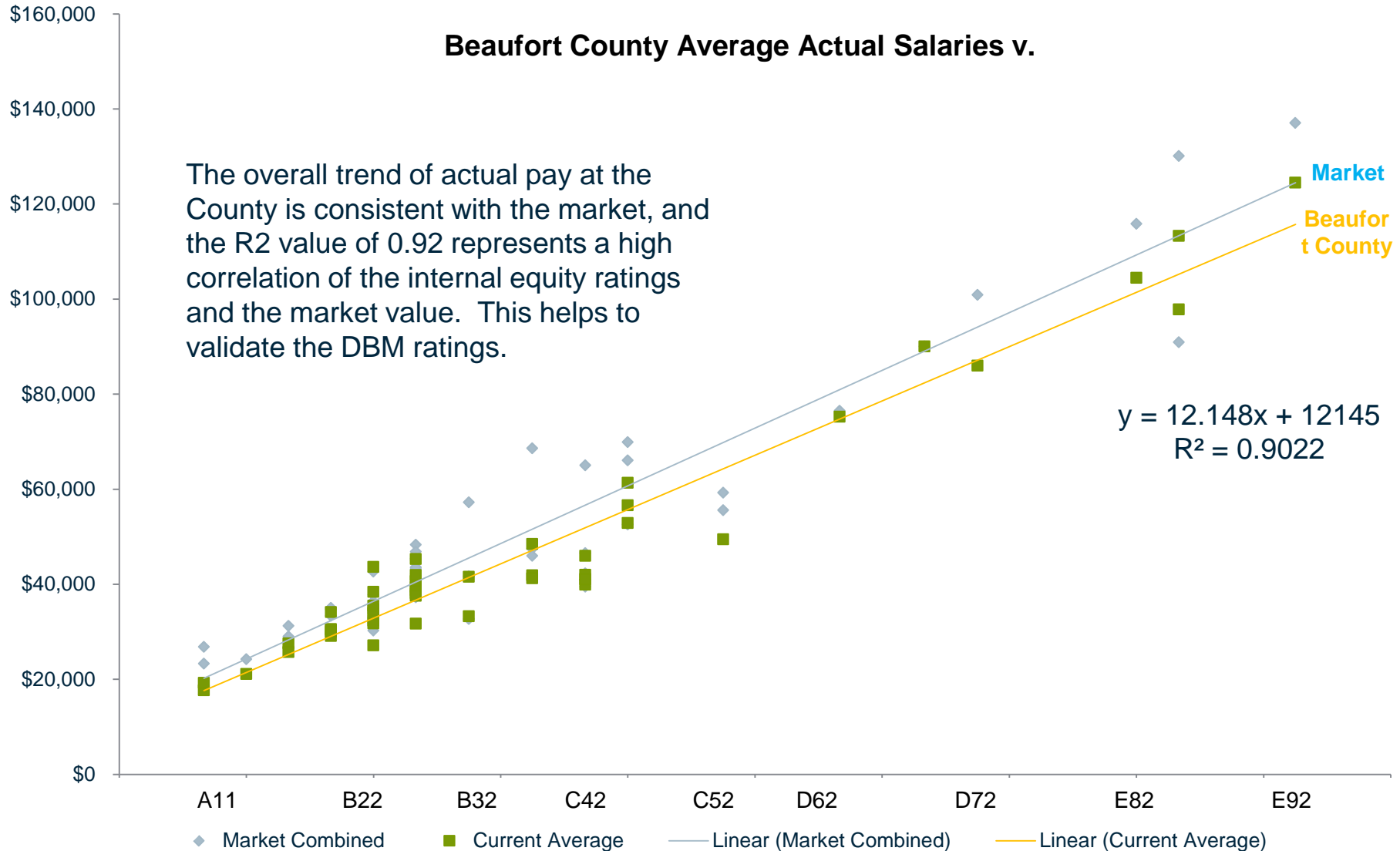

# Compensation Study – Salary Structure

- By utilizing a combination of the market data and the job evaluation results, we are proposing a salary structure that is competitive with the market and internally equitable.
- We examined two possible salary structures:
  - Midpoints based on the market 50<sup>th</sup> percentile trend line
  - Midpoints based on the market structure midpoint trend line
- Based on the average market salary range spread of 55%, which is also consistent across most benchmark jobs, we have used a flat range spread of 55% for all salary ranges.

# Compensation Study – Salary Structure

## Market Midpoint v. Market Median Salary

The lines below show the trend lines for the market median (actual/average salaries) and the market salary structure midpoint.

Based on the trend comparisons of the market median and market midpoint, we recommend basing the structure on market midpoint trend line. The trend lines are very comparable in bands D and E, while the market median trend line lags the market midpoint significantly in bands A & B.

If a structure is based on the market median the proposed structure minimum and maximum would be misaligned with the market, and not meet the goal of a salary structure that is competitive with the full spectrum of the market.

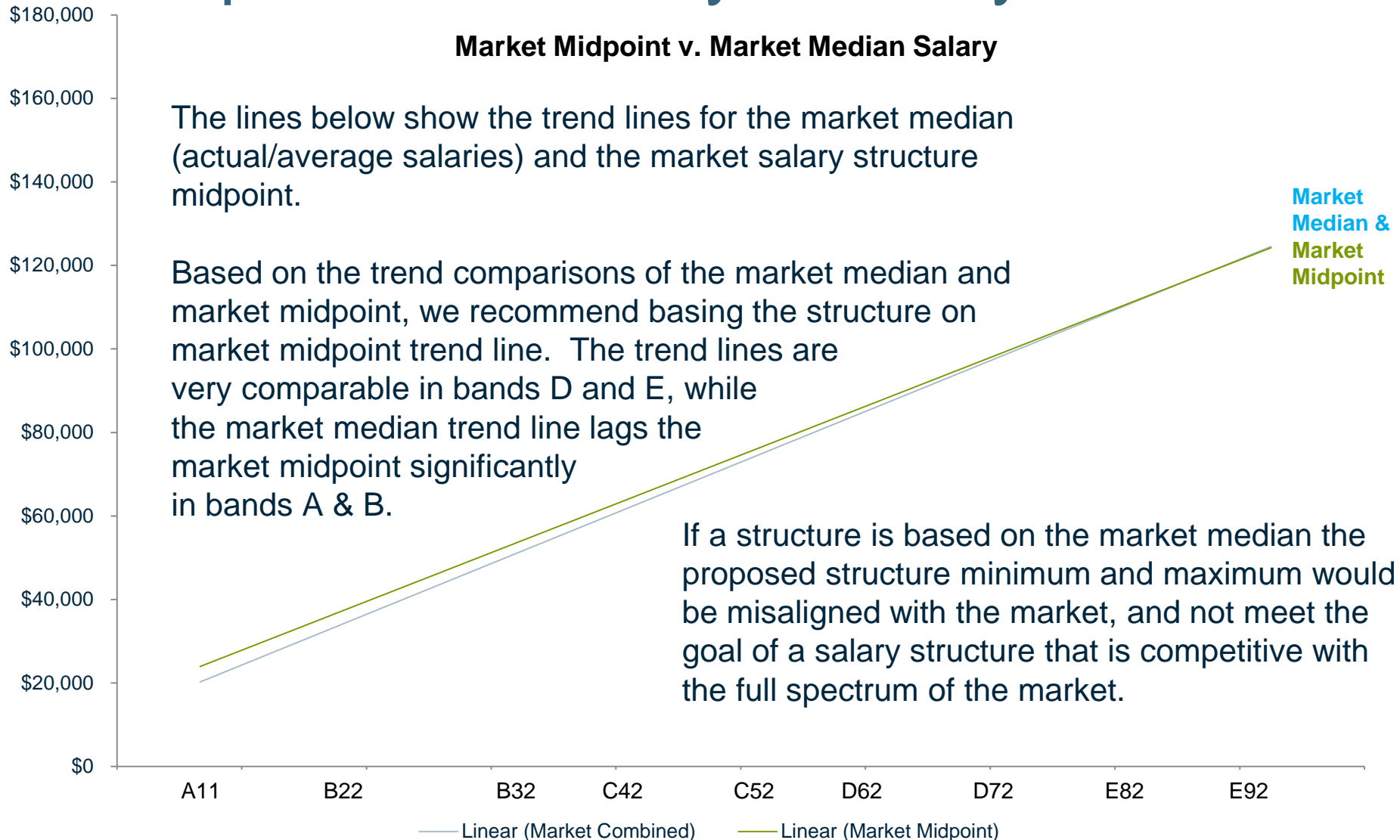

# Compensation Study – Salary Structure

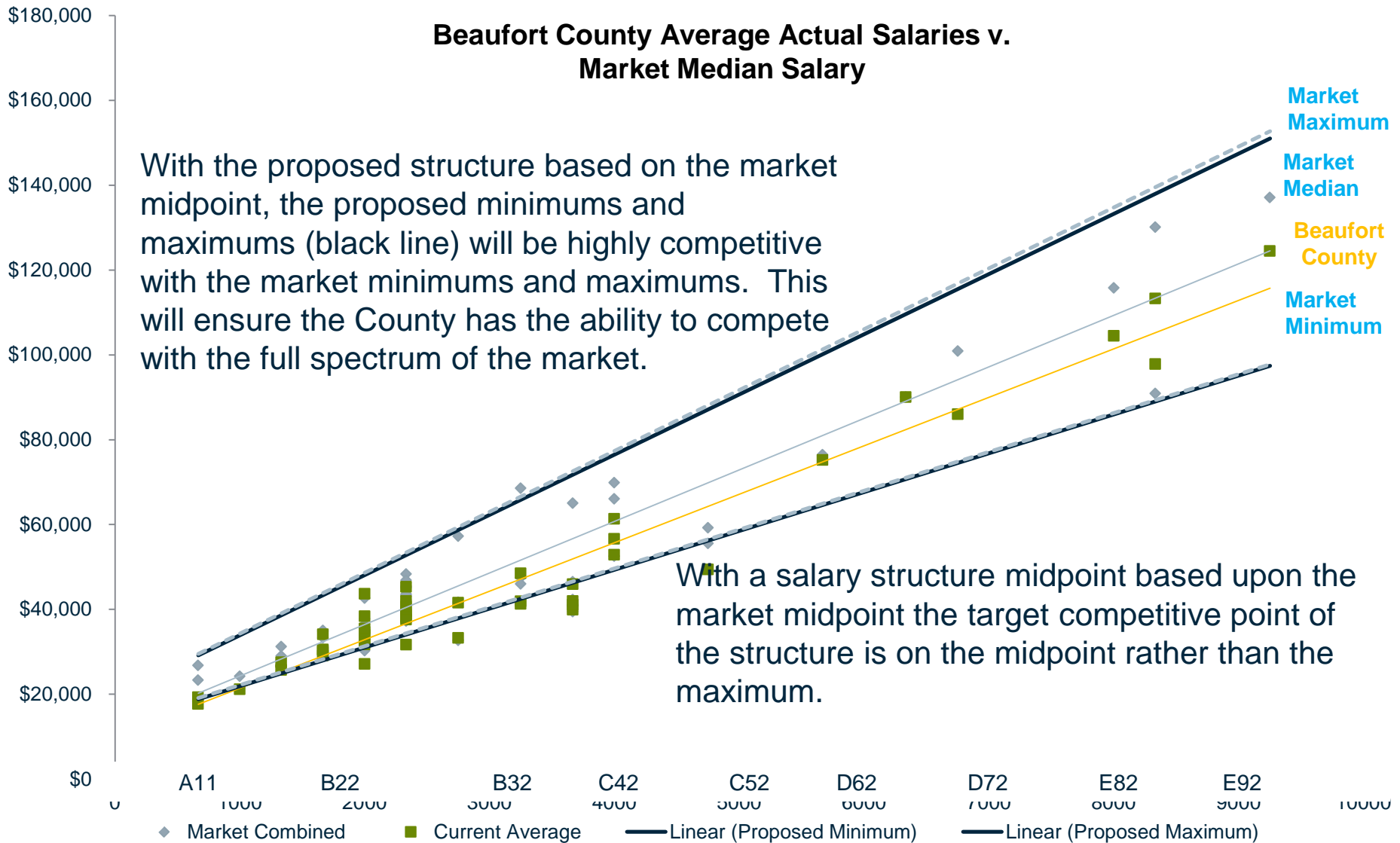



# Compensation Study – Salary Structure

Proposed Salary Structure: Based on Market Midpoint				
DBM Rating	Minimum	Midpoint	Maximum	Range Spread
A11	\$18,809	\$23,982	\$29,154	55%
A12	\$21,860	\$27,871	\$33,882	55%
A13	\$24,910	\$31,760	\$38,611	55%
B21	\$27,970	\$35,662	\$43,353	55%
B22	\$31,020	\$39,551	\$48,082	55%
B23	\$34,071	\$43,440	\$52,810	55%
B24/B31	\$37,891	\$48,311	\$58,731	55%
B25/B32	\$42,471	\$54,151	\$65,831	55%
C41	\$46,291	\$59,022	\$71,752	55%
C42	\$49,342	\$62,911	\$76,480	55%
C43	\$52,393	\$66,800	\$81,208	55%
C44/C51	\$56,213	\$71,671	\$87,129	55%
C45/C52	\$60,793	\$77,511	\$94,229	55%
D61	\$64,613	\$82,382	\$100,150	55%
D62	\$67,664	\$86,271	\$104,878	55%
D63	\$70,714	\$90,160	\$109,607	55%
D71	\$74,534	\$95,031	\$115,528	55%
D72	\$79,115	\$100,871	\$122,627	55%
E81	\$82,935	\$105,742	\$128,549	55%
E82	\$85,985	\$109,631	\$133,277	55%
E83	\$89,036	\$113,520	\$138,005	55%
E91	\$92,856	\$118,391	\$143,926	55%
E92	\$97,436	\$124,231	\$151,026	55%

# Compensation Study – Implementation

- We examined the cost of three implementation methods for the proposed salary structure, and determined that the method below meets the needs of the County. Therefore, we recommend the following:
  - Years of Service – using the estimated years of service in the current job title provided by Employee Services we move all employees to the appropriate implementation step of the salary structure

# Compensation Study – Implementation

- The overall cost to place all employees on the step in the proposed salary range based upon years of service in their current job title:

	Salary Below Proposed Step	Salary Over Proposed Step
<b>Total No. of Employees:</b>	<b>663</b>	<b>260</b>
<b>Total Cost (Annual):</b>	<b>\$2,870,031</b>	<b>Over Maximum</b>
<b>% of Overall Salary Cost:</b>	<b>8.8%</b>	<b>5</b>

- Placement is based on one year in current job per step up to the midpoint of the salary range.
  - The minimum to midpoint range was selected by taking into account the County budget, sound compensation principles, and consideration of the future growth of salaries. This approach allows the County flexibility and room to grow.
- Based on the funds available, County would implement 70% of proposed increase to step amount for all other staff in study, for a total cost of just over \$2 million.

# Recommendation

- Adopt the proposed classification structure that allows flexibility and transparent potential career paths.
- Utilize the Decision Band™ Method to evaluate positions to ensure internal equity.
- Implement the proposed salary structure to ensure competitive salary ranges for the recruitment and retention of employees per the determined implementation method.
  - Based on funds and goals of the County, we recommended the “Years of Service Method”. This will achieve a competitive salary structure, bringing employees to the minimum, and moving long-term employees through the salary range.
  - Due to the 70% implementation amount, there is approximately \$800,000 of salary increases remaining to achieve full implementation.

# Recommended Administration

- Pay administration guidelines should be implemented for placing and moving employees through the structure, we recommend the following:
  - The hiring range should be from the range minimum for minimally acceptable qualified individuals to the first quartile (25<sup>th</sup> percentile) for well qualified individuals.
  - Appointment above the first quartile or midpoint should require the approval of Management.
  - Salary advancement through the structure should be based on competent performance in the job class.
  - The salary structure should be adjusted by a structure movement trend factor every year to remain competitive with the market.
  - In addition to adjusting the salary structure each year to keep pace with the market, the County should conduct a comprehensive market compensation study similar to the salary study part of the project at least every three years.
  - The County should annually review its internal alignment and classification of jobs to ensure proper leveling between the supervisors and managers.

**RESOLUTION 2016-\_\_\_**

**A RESOLUTION OF BEAUFORT COUNTY, SOUTH CAROLINA ADOPTING A CLASSIFICATION STRUCTURE THAT UTILIZES THE DECISION BAND™ METHOD TO EVALUATE POSITIONS**

**WHEREAS**, Beaufort County Council retained Gallagher Benefit Services, Inc. to complete a Classification and Compensation Study; and

**WHEREAS**, the overall goals of the study are to ensure internal equity between job classifications within the County's organization so that there is equal pay for equal work as much as practicable, and, to develop an externally competitive salary structure and program so that the County can attract and retain qualified and quality employees; and

**WHEREAS**, the study included reviewing, updating and preparing new Job Descriptions for all County job classifications.

**NOW, THEREFORE, BE IT RESOLVED** by Beaufort County Council, that Gallagher Benefit Services, Inc.'s Classification and Compensation Study Report is hereby accepted and adopted as a tool for the County's policy and system with respect to personnel classification and compensation.

Done this \_\_\_\_\_ day of \_\_\_\_\_, 2016.

COUNTY COUNCIL OF BEAUFORT COUNTY

BY: \_\_\_\_\_  
D. Paul Sommerville, Chairman

APPROVED AS TO FORM:

\_\_\_\_\_  
Thomas J. Keaveny, II, County Attorney

ATTEST:

\_\_\_\_\_  
Ashley M. Bennett, Clerk to Council

RESOLUTION 2016 /

A RESOLUTION REQUESTING THAT THE  
PRESIDENT OF THE UNITED STATES OF AMERICA GIVE FAVORABLE  
CONSIDERATION TO ESTABLISHING A  
NATIONAL MONUMENT IN BEAUFORT COUNTY, SOUTH CAROLINA  
TO REMEMBER THE RECONSTRUCTION ERA

WHEREAS, Beaufort County is the home to many historical activities and sites that defined the Reconstruction Era including:

1. The November 7, 1861 Battle of Port Royal that freed 10,000 slaves.
2. The Port Royal Experiment started in 1862 at Camp Saxton in response to first answer the question of how society should be reconstructed.
3. Mitcheville established in 1862 on Hilton Head Island as the first self-governed town in America that ushered in the “Dawn of Freedom” where formally enslaved people for the first time experience freedom; first built and managed their own town; and first established compulsory education in America.
4. The first Union Black Regiment formed in 1862 at Ft. Saxton.
5. Harriet Tubman, known as the “Conductor of the Underground Railroad,” arrived in 1862 and formed a contraband-based intelligence network that supported the Union Army.
6. The Emancipation Oak where the Emancipation Proclamation was first read in 1863.
7. The home of Robert Smalls, who escaped a life of enslavement by commandeering the Confederate Ship Planter to later become a member of the U.S. House of Representatives and author of state legislation providing for South Carolina to have the first free and compulsory public school system in the United States of America.
8. Penn and Mather Schools where recently freed slaves were educated. Dr. Martin Luther King wrote his “I have a Dream” speech at Penn Center.
9. The Brick Baptist Church, the most prominent surviving institution of the Reconstruction Era that is connected to Penn School.
10. The Old Beaufort Firehouse dating back to 1874; and

WHEREAS, Beaufort County is rich in Reconstruction history offering the exciting possibility of both a:

1. National Monument to be located at either Penn Center / Brick Baptist Church site or the Emancipation Oak / Ft. Saxton site;
2. National Historic Trail encompassing approximately 100 sites in Beaufort and the adjacent counties, and

WHEREAS, Beaufort County lies at the center of the Charleston to Hilton Head Island to Savannah coastal corridor that attracts approximately 20 million visitors annually, which forms a ready audience to hear and appreciate the Reconstruction story; and

WHEREAS, the National Park Service has yet to establish a historic site that focuses on the Reconstruction Era; and

WHEREAS, an extensive study, commissioned by the National Park Service, recently concluded that Beaufort County is the most appropriate place to tell the Reconstruction story; and

WHEREAS, then U.S. Secretary of Interior Bruce Babbitt in 2000 recommended that Beaufort County be the national site for telling the Reconstruction story; and

WHEREAS, U.S. Congressman James Clyburn introduced legislation in 2016 in the U.S. Congress, co-sponsored by U.S. Congressman Mark Sanford, to establish the Reconstruction Monument in Beaufort County.

NOW, THEREFORE, BE IT RESOLVED, that the County Council of Beaufort County hereby adopts a resolution requesting the President of the United States of America give favorable consideration to establishing a National Monument in Beaufort County to remember the Reconstruction Era.

Adopted this \_\_\_\_ day of \_\_\_\_\_, 2016.

COUNTY COUNCIL OF BEAUFORT COUNTY

BY: \_\_\_\_\_  
D. Paul Sommerville, Chairman

APPROVED AS TO FORM:

\_\_\_\_\_  
Thomas J. Keaveny, II, County Attorney

ATTEST:

\_\_\_\_\_  
Ashley M. Bennett, Clerk to Council



## Department of Commerce Economic Development Funding Request Proposal

### **Project Proposed for Beaufort County FY 2016-2017 Funds:**

The Beaufort Digital Corridor (BDC) in northern Beaufort County and the Don Ryan Center for Innovation (DRCI) in southern Beaufort County will simultaneously develop complementary projects that address a two-fold strategy vital to the overall economic health of the county, region and state that involves: (1) recruiting & developing new companies; and (2) growing businesses from within to retain talent. The BDC and DRCI are both invested in spurring and nurturing entrepreneurship through innovation, employing compatible approaches with differently defined constituents in different geographic sectors of the county. The success of these ventures is tied to a symbiotic relationship with a local skilled workforce manifested through engagement in meaningful partnerships and relationships with our educational institutions including the University of South Carolina Beaufort, Technical College of the Lowcountry, Beaufort County Schools and Clemson University. Likewise, unique characteristics of the community, such as the military presence, provide entrepreneurial opportunities for meeting special supply/support services, while also creating opportunities to help military personnel transition into the private sector and stay in the community. Although these innovation centers have been initiated by municipalities—the City of Beaufort and the Town of Bluffton, respectively—the impact will be countywide with no jurisdictional lines evident beyond the addresses of the physical sites where these centers are located, and the critical operating support and investment provided by the two municipalities to ensure sustainability of these projects they have cultivated.

### **Appropriations Act for FY 2016-2017: Proviso 50.13 Local Economic Development Alliances (LEDA) Funds**

- \$ 140,000 allocated for Beaufort County; Department of Commerce Proviso 50.13 budget: \$5,000,000
- Beaufort was the only county (non-alliance) with an allocation
- Funds available for draw down as of July 26, 2016
- At the end of the fiscal year, any unexpended, unallocated or undistributed funds in this line item of the Department of Commerce budget will be made available to other Regional Economic Development organizations or transferred to the Rural Infrastructure Fund; these do not carry over; counties are ineligible for requesting undistributed funds. Once the county (or alliance) has drawn down their allocated funds for a project, these do not have to be spent by the end of the fiscal year. (see reporting requirements below)

### **Disbursement & Draw Down Requirements:**

- Planning Package including mission, goals, objectives and performance measures (Beaufort County)
- Project Summary
- Itemized Budget
  - Appropriated funds may NOT be used for operating costs (recurring costs, staff, benefits, rent, etc.)
- Financial Audit (Beaufort County)
- Statement of Non-Discrimination
- Certification of Matching Funds (1:1)\*
  - Must be new, received, and with documentation accompanying the request for disbursement
  - Must be private funds; cash contributions for the purpose of matching this allocation & project
  - May NOT be loans, donations or gifts of assets such as land, nor multi-year commitments

*\*NOTE: A private match in the amount of \$150,000 has been secured from Hargray Communications, payable to the City of Beaufort, and may be submitted as such as part of this Beaufort County Economic Development activity for FY 2016-2017 (per a representative for the Department of Commerce) if certified as new and intended for a match to this project.*

### **Reporting:**

- Quarterly Reports (by April 30, July 31, October 31, January 31) to the Department of Commerce until all appropriated funds have been expended.
- Annual Reports to the Chairman of Senate Finance, Chairman of House Ways & Means Committee and Secretary of Commerce (by November 1) until all appropriated funds have been expended.
- Reports may be provided by the City of Beaufort/Beaufort Digital Corridor and/or the Town of Bluffton/Don Ryan Center for Innovation on behalf of this project and submitted to Beaufort County administration for review/disbursement.

### **Beaufort Digital Corridor: Incubator, Co-Working Space, Education & Networking for Technology Companies**

The Beaufort Digital Corridor (BDC), modeled after the highly successful Charleston Digital Corridor (CDC), is slated to open later this year in the downtown commercial core of the City of Beaufort, in a redevelopment project site at 500 Carteret Street through a partnership between the City and Charleston Digital Corridor. BDC is being established as a 501(c)(6) non-profit corporation, utilizing the expert CDC staff to help meet five key objectives:

- Be the “go to” organization to support, nurture and recruit tech and creative companies to the City of Beaufort and northern Beaufort County
- Serve as a recruitment tool for high-tech and advanced skills workers and professionals
- Facilitate and enhance the education/training offerings to Beaufort’s professional and technical pool
- Participate in an advisory capacity to promote culture, history and quality of life in Beaufort County
- Be the focal point for guidance and direction for tech and creative students and entrepreneurs.

Dubbed “BASEcamp,” the space will house 10 fully furnished & wired offices ranging from 75-100 square feet each; month-to-month lease terms with one-year maximum stay; staffed reception area; 24-hour access; monthly co-working memberships; access to the conference room with a/v capacity; temporary “touchdown” workstations for members; kitchen; corridor bikes for residents’ use; mail/package handling; on-site parking and high-speed 100mb symmetric data services that can be scaled as needed. It will also be the host site of educational & social programs and events for in-house companies and other BDC members, as well as the community at large. BDC will attract a minimum of 10-12 participants in the first year and grow this to 100 participants within five years.

### **Don Ryan Center for Innovation: Incubator, Co-Working Space, Education & Networking for All Types of Companies**

The Don Ryan Center for Innovation is a proven, four-year old business incubator charged with growing Bluffton's and the surrounding regions economic base by helping innovative start-up or early stage companies. It is a 501(c)(3) non-profit corporation created in partnership with the Town of Bluffton. DRCI offers space, resources, hands-on consulting support, and can link innovators to business mentorships, technology evaluation, product development services, marketing services, intellectual property research, and seed financing. In mid-2017 the DRCI will be moving from its current donated location to a new facility twice the current size with many more capabilities. The location will still be at Buckwalter Place in Bluffton. In addition to the traditional space for incubated companies that are part of the formal incubation program, the DRCI will also house a co-working location that will be called “The HUB.” The HUB will be a place for clients who are solopreneurs, remote workers, freelancers, or people just searching for some off-site, inspiration. Twenty-eight companies have been through the formal DRCI incubator program to date. The regional impact from year one has seen jobs increase from eight to eighty-five, payroll increases from \$880,000 to \$4.9 million, and revenue increases from \$2 million to \$25 million.

#### **Project Budget**

BDC	Building Renovation/Interior demolition, Up-fit	\$ 200,000
BDC	Start Up Furniture	\$ 20,000
BDC	Start Up Equipment	\$ 7,000
BDC	Code Camp Lab	\$ 18,000
DRCI	New Site Up-fit	\$ 60,000
DRCI	New Site Fixtures & Furnishings	\$ 40,000
DRCI	“The HUB” Up-fit, fixtures & furnishings	\$ 35,000
DRCI	Makerspace tools & equipment	\$ 15,000
DRCI	IT Infrastructure, AV Equip., Appliances	\$ 25,000
<b>Total:</b>		<b>\$ 420,000</b>

#### **Source of Funding**

South Carolina Dept. of Commerce, Proviso 50.13	\$ 140,000	BDC \$70,000; DRCI \$70,000
Hargray Communications (private match)*	\$ 150,000	BDC
City of Beaufort	\$ 25,000	BDC
Town of Bluffton	\$ 30,000	DRCI
Corporate Sponsorships	\$ 25,000	DRCI
Program Fees & Fundraisers	\$ 50,000	DRCI
<b>Total:</b>	<b>\$ 420,000</b>	

**ORDINANCE 2016/ \_\_\_\_\_**

**AN ORDINANCE OF BEAUFORT COUNTY COUNCIL UPDATING THE BEAUFORT COUNTY SMOKING ORDINANCE**

**WHEREAS**, numerous medical and scientific studies show substantial levels of exposure to secondhand smoke among the United States population; and

**WHEREAS**, the U.S. Surgeon General has concluded that smoking and exposure to secondhand smoke is harmful to the smoker and to people around the smoker; and

**WHEREAS**, prohibiting smoking in and around the workplace, public buildings and publicly supported facilities increases public awareness of the adverse health effects of smoking, reduces the social acceptability of smoking, reduces harm caused by smoking to nonsmokers and to children and reduces costs to the community of addressing the medical conditions caused by smoking; and

**WHEREAS**, in 1982 Beaufort County codified its Code of Ordinance including Section 38-91 through Sec. 38-98; and

**WHEREAS**, in 2006 Beaufort County Council passed Ordinance 2006-28 adding Article V establishing the regulation and requirements relating to smoking tobacco products in the County of Beaufort and those additions were codified as Beaufort Code Section 38-101 through Sec. 38-112; and

**WHEREAS**, the South Carolina General Assembly passed the “Clean Indoor Air Act” in 1990 and codified as S.C. Code Secs. 44-95-10 through 44-95-60 which preempts some of the local ordinances; and

**WHEREAS**, Council recognizes that for a variety of reasons citizens are frequently required to come to government offices in order to conduct business as well as to enjoy cultural activities, athletic events and artistic endeavors; and

**WHEREAS**, Council has determined that it is in the best interest of the residents of Beaufort County to designate County owned and operated properties, including outdoor property adjacent to the same which is under the control of the County as smoke-free in order to protect the public health, safety and general welfare of its citizens, residents, employees and visitors who enter these properties.

**NOW THEREFORE, BE IT HEREBY ORDAINED** that, in order, to protect and promote the public health, safety and general welfare of Beaufort County residents, Beaufort County Code Article IV, Division I Sec 38-91 through 38-98 and Article IV, Division II Sec. 38-101 through 38-112 are hereby amended and replaced with the following:

**DIVISION 1. – IN COUNTY OWNED FACILITIES**

**Sec. 38-91. - Definitions.**

The following words, terms and phrases, when used in this article, shall have the meanings ascribed to them in this section, except where the context clearly indicates a different meaning:

*County owned and operated facilities* means any building or facility, including outdoor property adjacent to and part of such a building or facility, which is used by any person(s), group of persons, agencies or organizations which are funded in whole by public funds from County Council or which is operated by or under the managerial control of the County.

*Public meeting* means any meeting open to the public under the South Carolina Freedom of Information Act.

*Smoking* means inhaling, exhaling, burning, lighting or carrying a lighted cigarette, e-cigarette, cigar, pipe, device or any other lighted inhalable product.

(Code 1982, § 8-57)

**Cross reference**— Definitions generally, § 1-2.

**Sec. 38-92. - Prohibitions.**

- ~~(a)~~ Smoking shall be prohibited in and on all county owned or operated facilities.
- (b) Smoking may be prohibited in private sector establishments at the option of owners/operators in unincorporated areas of the County; such establishments shall identify designated smoking areas as set forth in Section 38-94.

(Code 1982, § 8-58)

**Sec. 38-93. - Posting of signs.**

- (a) Signs with the words "No Smoking" in letters not less than four inches high and citing in smaller letters enabling Ordinance No. 92-24 shall be conspicuously posted in each room and publicly supported place as defined in Section 38-91. These signs shall be visible to any occupant of the restricted area. Public areas not posted shall be deemed to be nonsmoking areas unless specifically posted as smoking areas.
- (b) Posting of no smoking signs shall be the responsibility of the person directly in control of the affected facility.
- (c) Signs may be posted by any private citizen in his place of business. Standard signs may be obtained from the County purchasing agent. Inclusion under this article of a private-sector establishment is entirely voluntary. The proprietor, owner, or individual responsible for such establishment may disregard enforcement of this article if he so desires in his own place of business.

(Code 1982, § 8-59)

**Sec. 38-94. - Designated smoking areas.**

- ~~(a)~~ (a) If smoking areas are designated, they shall be selected using existing physical barriers and ventilation systems to minimize the toxic effects of smoke in adjacent nonsmoking areas.
- ~~(b)~~ (b) Designated smoking areas, if any, shall not include the specific areas prohibited in Section 38-92.

**Sec. 38-95. - Responsibility.**

The County Administrator or his designated representative shall be responsible for informing each person directly in control of each publicly supported facility of this article.

(Code 1982, § 8-61)

**Sec. 38-96. – Reserved.**

**Sec. 38-97. - Violation of signs.**

No person shall smoke in any properly posted place, nor shall any person remove any “No Smoking” sign erected by or under the authority of this article.

(Code 1982, § 8-63)

**Sec. 38-98. - Penalties.**

- (a) Any person who violates any section of this article may be cited and, if found guilty of an infraction, punished by a fine of not less than ten dollars (\$10.00) nor more than twenty – five dollars (\$25.00).
- (b) Any person who owns, manages, operates, or otherwise controls a public place or place of employment and who fails to comply with the provisions of this article shall be guilty of an infraction, punishable by a fine of not less than ten (\$10.00) nor more than twenty – five dollars (\$25.00).
- (c) In addition to the fines established by this section, repeated violations of this article by a person who owns, manages, operates, or otherwise controls a place of employment may result in the suspension or revocation of any occupancy permit or business license issued to the person for the premises on which the violation occurred.

(Code 1982, § 8-64)

**Secs. 38-99, 38-100. - Reserved.**

## **DIVISION 2. - IN THE WORKPLACE**

### **Sec. 38 -101. - Intent.**

Council finds that it is in the best interest of the people of the County to protect nonsmokers from involuntary exposure to secondhand smoke in the workplace. Therefore, Council declares that the purpose of this article is to preserve, protect and improve the public health, comfort, safety and environment of the people of the County by limiting exposure to tobacco smoke in the workplace.

(Ord. No. 2006/28, § 2, 12-11-2006)

### **Sec. 38-102. - Definitions.**

- (a) *Employee* means any person who performs services for an employer in return for wages, profit or other valuable consideration.
- (b) *Employer* means any person, partnership, association, corporation, trust, school, college, university or other educational institution, nonprofit entity or other organization, including any public or private employer, any manager, supervisor, and all other persons charged with control, supervision, and operation of any work place, work space, or work spaces as defined herein, that employs one or more persons.
- (c) *Enclosed* means a space bounded by walls (with or without windows), and enclosed by doors, including but not limited to, offices, rooms, foyers, waiting areas and halls
- (d) *Secondhand smoke* is the complex mixture formed from the escaping smoke of a burning product (termed "sidestream smoke") and smoke exhaled by the smoker. Exposure to secondhand smoke is also frequently referred to as "passive smoking," "secondhand smoking" or "involuntary smoking".
- (e) *Sheriff's office* means the Beaufort County Sheriff's Office.
- (f) *Public building* means any enclosed area which is owned, operated or leased by the County as well as outdoor property adjacent to such buildings and facilities.
- (g) *Retail tobacco store* means any establishment which is not required to possess a retail food permit whose primary purpose is to sell or offer for sale to consumers, but not for resale, tobacco products and paraphernalia, in which the sale of other products is merely incidental, and in which the entry of persons under the age of 18 is prohibited at all times.
- (h) *Smoking* means the inhaling, exhaling, burning, lighting or carrying a lighted cigarette, e-cigarette, cigar, pipe, device or any other lighted inhalable product.
- (i) *Smoking materials* includes cigars, cigarettes, e-cigarettes and all other manner of devices intended to be used for the purpose of inhaling, burning, carrying or exhaling lighted products.
- (j) *Workplace* means any enclosed indoor area, structure, building or facility or any portion thereof at which one or more employee(s) perform services for their employer, including but not limited to: retail food stores; retail stores; restaurants; bars; cabarets, cafes; public or private clubs; pool halls and bowling alleys.

- (k) *Work space* or *work spaces* means any enclosed area occupied by an employee during the course of his or her employment, including but not limited to: offices, customer service areas; common areas; hallways; waiting areas; restrooms; lounges and eating areas.
- (l) *Person(s)* means a customer or other visitor on the premises regulated herein.

(Ord. No. 2006/28, § 3, 12-11-2006; Ord. No. 2008/23, 6-23-2008)

**Sec. 38-103. - Prohibition of smoking in the workplace.**

- (a) The employer shall provide a smoke free environment for all employees working in all work space, work spaces and work places as those terms are defined herein. Further, the employer and all employees shall prohibit any persons present in said work space, work spaces and work places from smoking tobacco products therein.
- (b) Smoking shall be prohibited in all work space, work spaces and work places in a workplace. This includes all common work areas, auditoriums, classrooms, conference and meeting rooms, private offices, hallways, medical facilities, cafeterias, employee lounges, staircases, restrooms and all other enclosed areas in the workplace.

(Ord. No. 2006/28, § 4, 12-11-2006)

**Sec. 38 -104. - Smoking restricted by state law: S.C. Code § 44-95-10 et seq.**

It is unlawful for a person to smoke or possess lighted smoking material in any form in the following public indoor areas:

- (a) Public schools and preschools where routine or regular kindergarten, elementary, or secondary educational classes are held including libraries;
- (b) All other indoor facilities providing children's services to the extent that smoking is prohibited in the facility by federal law and all other child day care facilities, as defined in Section 20-7-2700, which are licensed pursuant to S.C. Code, § 20-7-13(11);
- (c) Health care facilities as defined in S. C. Code § 44-7-130;
- (d) Government buildings as defined in S. C. Code § 44-95-20(4), except to the extent regulation by the County is authorized therein;
- (e) Elevators;
- (f) Public transportation vehicles, except for taxicabs;
- (g) Arenas and auditoriums of public theaters or public performing art centers.

**Sec. 38-105. - Exceptions.**

Notwithstanding the provisions of Section 38-103 herein, smoking may be permitted in the following places and/or circumstances:

- (a) Private residences, except when used as a licensed child care, adult day care or healthcare facility;

- (b) Hotel, motel, inn, bed and breakfast and lodging home rooms that are rented to guests, designated as "smoking rooms" (rooms) provided that the total percentage of such rooms does not exceed 25 percent in such establishment. A room so designated shall have signs posted indicating that smoking is allowed therein;
- (c) Retail tobacco stores as defined herein;
- (d) Religious ceremonies where smoking is part of the ritual.

(Ord. No. 2006/28, § 6, 12-11-2006)

**Sec. 38-106. - Posting of signs.**

The owner, manager or person in control of an establishment or area in which smoking is prohibited pursuant to this section shall post a conspicuous sign at the main entrance to the establishment or area. The sign shall contain the words "No Smoking" and the universal symbol for no smoking.

(Ord. No. 2006/28, § 7, 12-11-2006)

**Sec. 38-107. - Reasonable distance.**

Smoking is prohibited within a reasonable distance of 25 feet outside entrances, operable windows, and ventilation systems of enclosed areas where smoking is prohibited, so as to insure that tobacco smoke does not enter those areas.

(Ord. No. 2006/28, § 8, 12-11-2006)

**Sec.38-108. - Enforcement and penalties.**

- (a) A person who violates any section of this article may be cited and, if found guilty of an infraction, punished by a fine of not less than ten dollars (\$10.00) nor more than twenty – five dollars (\$25.00).
- (b) A person who owns, manages, operates, or otherwise controls a public place or place of employment and who fails to comply with the provisions of this article shall be guilty of an infraction punishable by a fine of not less than ten (\$10.00) nor more than twenty – five dollars (\$25.00).
- (c) In addition to the fines established by this section, repeated violations of this article by a person who owns, manages, operates, or otherwise controls a public place or place of employment may result in the suspension or revocation of any occupancy permit or business license issued to the person for the premises on which the violation occurred. (Ord. No. 2006/28, § 9, 12-11-2006; Ord. No. 2008/23, 6-23-2008)

**Sec. 38-109. - Severability.**

If any provision, clause, sentence or paragraph of this division, or the application thereof to any person or circumstances shall be held invalid, that invalidity shall not affect the other provisions



of the ordinance which can be given effect without the invalid provision or application, and to this end the provisions of this division are declared to be severable.

(Ord. No. 2006/28, § 10, 12-11-2006)

**Sec. 38-110. - Nonretaliation.**

No person or employer shall discharge, refuse to hire, refuse to serve or in any manner retaliate or take any adverse personnel action against any employee, applicant, customer or person because such employee, applicant, customer or person takes any action in furtherance of the enforcement of this section or exercises any right conferred by this section.

(Ord. No. 2006/28, § 11, 12-11-2006)

**Sec. 38-111. - Conflict with other laws, ordinances or regulations.**

Nothing in this section shall be deemed to amend or repeal any applicable fire, health or other law, ordinance or regulation so as to permit smoking in areas where it is prohibited by such applicable fire, health or other law, ordinance or regulation.

(Ord. No. 2006/28, § 12, 12-11-2006)

**Secs. 38-113- 38-150. - Reserved.**

DONE this \_\_\_\_\_ day of \_\_\_\_\_, 2016.

COUNTY COUNCIL OF BEAUFORT COUNTY

By: \_\_\_\_\_  
D. Paul Sommerville, Chairman

APPROVED AS TO FORM:

\_\_\_\_\_  
Thomas J. Keaveny, II, County Attorney

ATTEST:

\_\_\_\_\_  
Ashley M. Bennett, Clerk to Council

First Reading: October 10, 2016

Second Reading: October 24, 2016

Public Hearing:

Third and Final Reading:

# ADD-ONS

The document(s) herein were provided to Council for information and/or discussion after release of the official agenda and backup items.

Topic: Debt Potential  
Date Submitted: November 14, 2016  
Submitted By: Alicia Holland  
Venue: County Council Regular

Beaufort County, South Carolina  
 General Obligation Bonds Estimated Debt Service  
 \*\*Preliminary and Subject to Change\*\*

Fiscal Year	Current Annual Debt Service	Estimated Value of 1 Mil <sup>2</sup>	Current Millage required	\$20 million estimated debt service <sup>1</sup>	Millage required for \$20 million	Total Millage required if \$20 million	\$26 million estimated debt service <sup>1</sup>	Millage required for \$26 million	Total Millage required if \$26 million
2017	\$ 9,923,942	\$ 1,754,762	5.48	\$ 811,830	0.46	5.94	\$ 1,055,379	0.60	6.08
2018	\$ 9,984,402	\$ 1,781,083	5.61	\$ 1,445,888	0.81	6.42	\$ 1,879,654	1.06	6.66
2019	\$ 9,834,773	\$ 1,807,800	5.44	\$ 1,447,300	0.80	6.24	\$ 1,881,490	1.04	6.48
2020	\$10,219,405	\$ 1,834,917	5.57	\$ 1,445,994	0.79	6.36	\$ 1,879,792	1.02	6.59
2021	\$ 9,596,072	\$ 1,862,440	5.15	\$ 1,446,456	0.78	5.93	\$ 1,880,393	1.01	6.16
2022	\$ 9,127,226	\$ 1,890,377	4.83	\$ 1,446,106	0.76	5.59	\$ 1,879,938	0.99	5.82
2023	\$ 8,331,954	\$ 1,918,733	4.34	\$ 1,446,894	0.75	5.10	\$ 1,880,962	0.98	5.32
2024	\$ 8,141,795	\$ 1,947,514	4.18	\$ 1,446,194	0.74	4.92	\$ 1,880,052	0.97	5.15
2025	\$ 7,682,830	\$ 1,976,726	3.89	\$ 1,446,506	0.73	4.62	\$ 1,880,458	0.95	4.84
2026	\$ 3,971,930	\$ 2,006,377	1.98	\$ 1,445,225	0.72	2.70	\$ 1,878,793	0.94	2.92
2027	\$ 2,009,151	\$ 2,036,473	0.99	\$ 1,447,350	0.71	1.70	\$ 1,881,555	0.92	1.91
2028	\$ 3,037,492	\$ 2,067,020	1.47	\$ 1,447,669	0.70	2.17	\$ 1,881,969	0.91	2.38
2029	\$ 3,072,246	\$ 2,098,025	1.46	\$ 1,446,181	0.69	2.15	\$ 1,880,036	0.90	2.36
2030	\$ 1,776,536	\$ 2,129,496	0.83	\$ 1,445,388	0.68	1.51	\$ 1,879,004	0.88	1.72
2031	\$ 1,778,707	\$ 2,161,438	0.82	\$ 1,445,181	0.67	1.49	\$ 1,878,736	0.87	1.69
2032	\$ 1,778,548	\$ 2,193,860	0.81	\$ 1,445,456	0.66	1.47	\$ 1,879,093	0.86	1.67
2033	\$ 1,779,120	\$ 2,226,768	0.80	\$ 1,446,106	0.65	1.45	\$ 1,879,938	0.84	1.64
2034	\$ 1,281,973	\$ 2,260,169	0.57	\$ 1,447,025	0.64	1.21	\$ 1,881,133	0.83	1.40
2035	\$ 280,980	\$ 2,294,072	0.12	\$ 1,446,381	0.63	0.75	\$ 1,880,296	0.82	0.94
2036	\$ 280,980	\$ 2,328,483	0.12	\$ 1,446,206	0.62	0.74	\$ 1,880,068	0.81	0.93
<b>Total</b>				\$ 28,291,336			\$ 36,778,737		

Note 1: The total estimated debt service is based on the current market conditions plus 25 basis points.

Note 2: The estimated value of 1 mil for 2018 and forward assumes a 1.5% growth rate.

## \$51 million General Obligation Bond

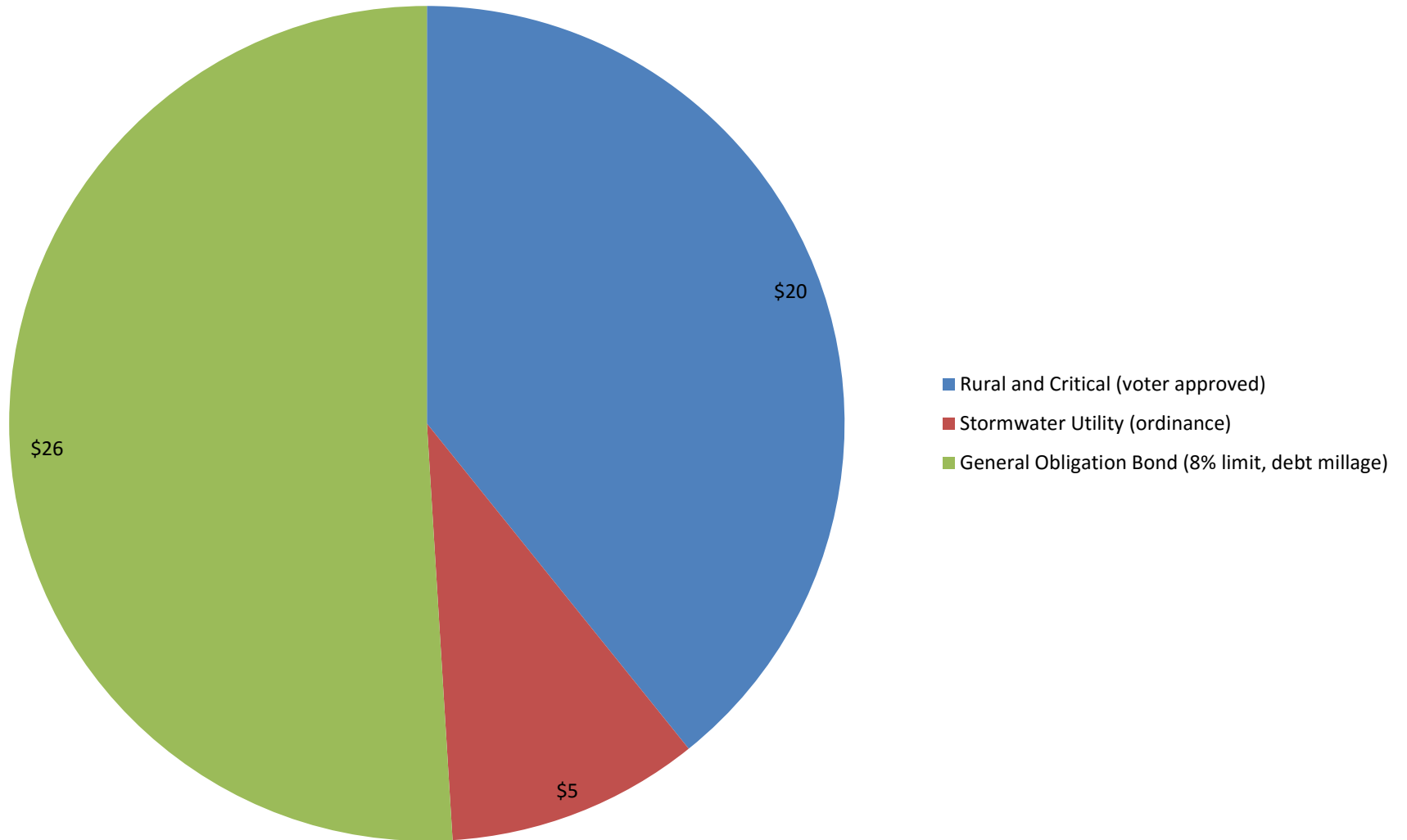

Note: values are in millions

## \$26 million GO Bond (8% debt, debt millage required)

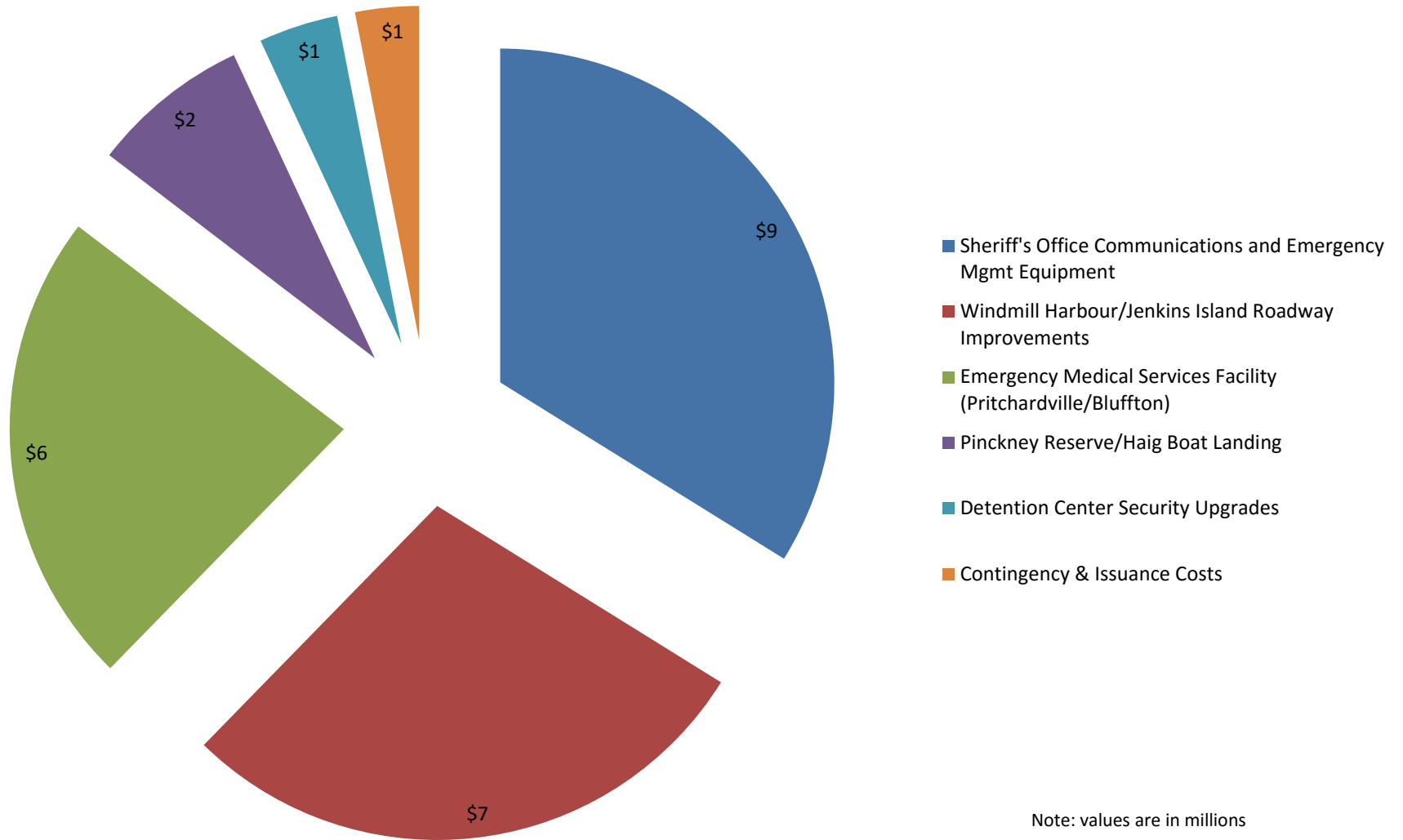

Topic: Amended Resolution Reconstruction Era  
Date Submitted: November 14, 2016  
Submitted By: Stu Rodman  
Venue: County Council Regular

## RESOLUTION 2016 /

### A RESOLUTION REQUESTING THAT THE PRESIDENT OF THE UNITED STATES OF AMERICA GIVE FAVORABLE CONSIDERATION TO ESTABLISHING A NATIONAL MONUMENT IN BEAUFORT COUNTY, SOUTH CAROLINA TO REMEMBER THE RECONSTRUCTION ERA

WHEREAS, Beaufort County is the home to many historical activities and sites that defined the Reconstruction Era including:

1. The November 7, 1861 Battle of Port Royal that freed 10,000 slaves.
2. The Port Royal Experiment was started in March 1862 by the Federal Government and Freedmen Associations in the Beaufort County Sea Islands to create a path to freedom and citizenship for former slaves.
3. Numerous Freedmen Communities, including Mitchelville on Hilton Head Island, Saxonville on St. Helena Island, Higginsonville in Beaufort and Sillimanville on Port Royal Island were established in Beaufort County, each containing schools and having a form of self-government.
4. The first Federal Black Regiment containing former slaves was organized in the county and mustered into service on January 1, 1863. Before the war ended six regiments of former slaves and one company of artillery was raised in the county and numerous freedmen joined the United States Navy and worked for the army's quartermaster corps.
5. Harriet Tubman, Thomas W. Higginson, Edward Pierce, Frances Gage, Clara Barton and numerous other well-known abolitionists and reformers who came to the Beaufort County Sea Islands and were part of the Port Royal Experiment, which is recognized by historians as the beginning of the nation's reconstruction program.
6. The site of the January 1, 1863 reading of the Emancipation Proclamation which freed the Sea Island slaves and began the end of slavery and the overall march to freedom.
7. The home of Robert Smalls, who escaped a life of enslavement by commandeering the Confederate Ship Planter to later become a member of the U.S. House of Representatives and author of state legislation providing for South Carolina its first free and compulsory public school system.
8. The site of numerous schools that served the Freedmen and their descendants including Penn and Mather Schools.
9. Over 100 sites related to reconstruction including the Brick Baptist Church, the Oaks, Frogmore and Coffin Point Plantations.
10. The Old Beaufort Firehouse, dating back to 1874, was part of the Beaufort City Government. Beaufort municipal government that remained integrated into the twentieth century long after the national demise of reconstruction, and

WHEREAS, an extensive study, commissioned by the National Park Service, recently concluded that Beaufort County is the most appropriate place to tell the Reconstruction Era story; and



**WHEREAS, the National Park Service has yet to request a Presidential Designation of the most fitting historic site to tell the story of the Reconstruction Era; and**

**WHEREAS, Beaufort County, rich in Reconstruction history, offers the exciting possibility of telling the Reconstruction story by being designated the Reconstruction National Monument on two sites:**

- 1. The January 1, 1863 reading of the Emancipation Proclamation.**
- 2. The Penn Center and the Brick Church, to also tell the Gullah Geechee story.**

**WHEREAS, Beaufort County lies at the center of the Charleston to Hilton Head Island to Savannah coastal corridor that attracts about 20 million visitors annually, which forms a ready audience to hear and appreciate the Reconstruction story; and**

**WHEREAS, then U.S. Secretary of Interior Bruce Babbitt in 2000 recommended that Beaufort County be the national site for telling the Reconstruction Era story; and**

**WHEREAS, U.S. Congressman James Clyburn introduced legislation in 2016 in the U.S. Congress, co-sponsored by U.S. Congressman Mark Sanford, to establish Beaufort County as ideal site to tell the Reconstruction Era story.**

**NOW, THEREFORE, BE IT RESOLVED, that the County Council of Beaufort County hereby adopts a resolution requesting the President of the United States of America give favorable consideration to establishing a National Monument in Beaufort County to remember the Reconstruction Era.**

**Adopted this \_\_\_\_ day of \_\_\_\_\_, 2016.**

**COUNTY COUNCIL OF BEAUFORT COUNTY**

**BY: \_\_\_\_\_  
D. Paul Sommerville, Chairman**

**APPROVED AS TO FORM:**

**ATTEST:**

\_\_\_\_\_  
**Thomas J. Keaveny, II, County Attorney**

\_\_\_\_\_  
**Ashley M. Bennett, Clerk to Council**