



MEMORANDUM

TO: All Residents and Employees of Beaufort County

FROM: Eric Larson, P.E., Director of Environmental Engineering & Land Management
Manager of Stormwater Utility

SUBJECT: Driveway Apron and Culvert Installation on County Roads

DATE: 12/13/2018

Effective immediately, Beaufort County Public Works will be discontinuing (refer to the attached technical memo recommending this change in policy) its service of installing a driveway asphalt apron and culvert for a fee, within County Right-of-Way for residents who request this service after completing an Encroachment Permit. Residents who now apply for an Encroachment Permit for a driveway must follow all SCDOT specifications for residential driveways (outlined in SCDOT Detail Sheets and SCDOT ARMS manual example, attached with this memorandum) and have the entrance installed by either a qualified contractor or do the installation themselves. As stated in the Beaufort County Encroachment Permit, all residents must contact Beaufort County Public Works 24 Hours prior to installation. After installing a driveway on a County road, the resident must then contact the Special Projects Engineer with Beaufort County Public Works to inspect that the driveway meets all County requirements to receive final approval and permit release.

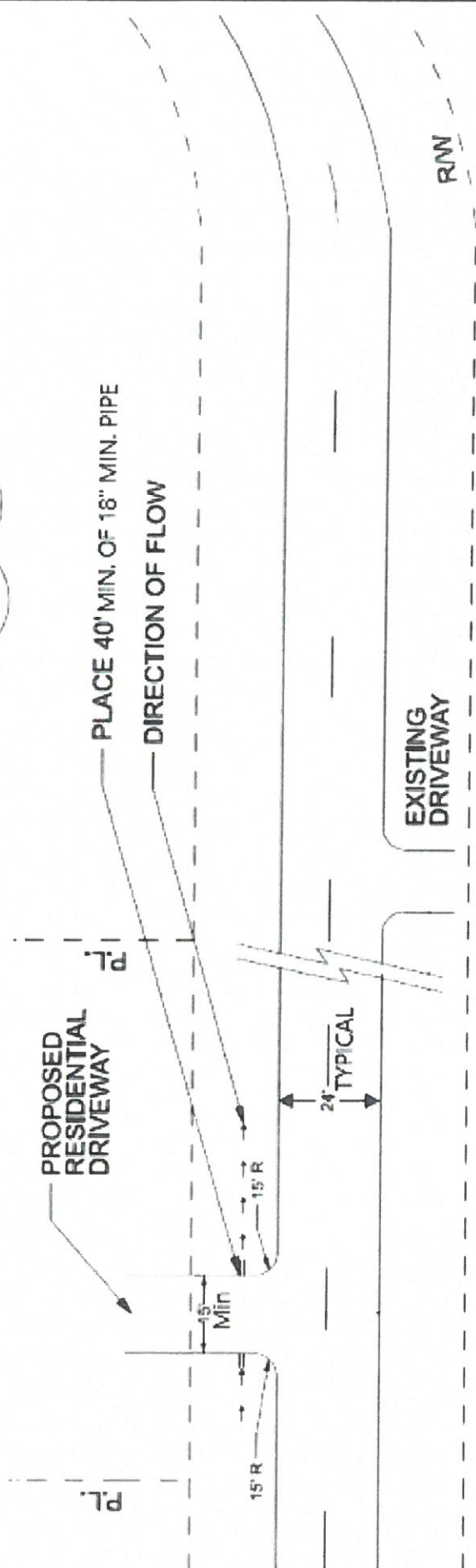
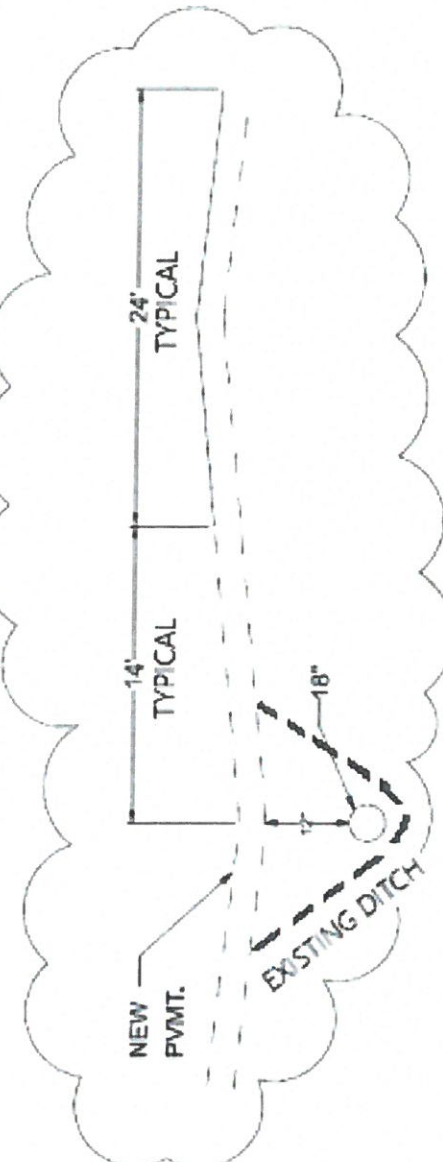

**TYPICAL ENCROACHMENT PERMIT SKETCH
FOR RESIDENTIAL DRIVEWAY**

1 inch = X feet

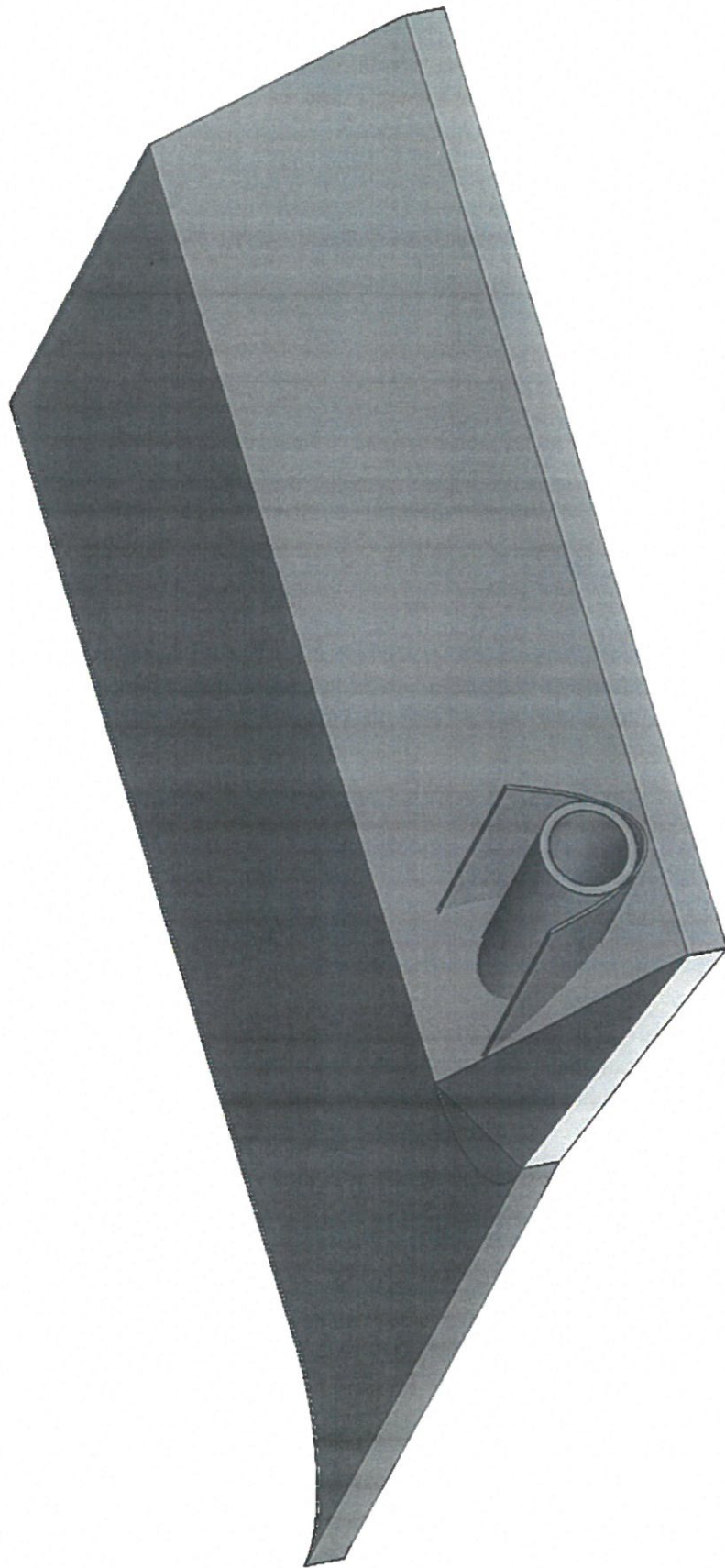

REFERENCES
 NATIONAL SPECIFICATIONS FOR STANDARD SPECIFICATIONS, SECTION 720.00
 PUBLIC RIGHTS-OF-WAY (NOVEMBER 21, 2005)

CONTRACT NO. 2005-115
 PROJECT NO. 1107283

PRECONSTRUCTION
 SUPPORT ENGINEER



DATE: MARCH 24, 2009

NO.	DATE	BY	DESCRIPTION
1			GENERAL REVISIONS
2			
3			
4			
5			

scdot
 SOUTH CAROLINA DEPARTMENT OF TRANSPORTATION
 DESIGN STANDARDS OFFICE
 955 PARK STREET
 ROOM 405
 COLUMBIA, SC 29201

STANDARD DRAWING
 DRIVEWAY WITH SIDEWALK ADJACENT TO CURB

720-405-00
 AUTOMATIC LISTING DATE: MAY 2009

- NOTES:
1. PROVIDE ADDITIONAL CONTRACTION JOINTS WITHIN DRIVEWAY WIDTH AS SPECIFIED IN SCDOT STANDARD SPECIFICATIONS, SECTION 720.00. DRIVEWAYS TO BE CONSTRUCTED WHERE DESIGNATED BY THE RESIDENT CONSTRUCTION ENGINEER.
 2. ALL CONCRETE CURB THROUGH DRIVEWAY TO BE MEASURED AND PAID FOR AS CURB. CURB SHALL BE CONCRETE AND DRIVEWAYS ARE TO BE 12" WIDE UNLESS NOTED OTHERWISE.
 3. SIDEWALK SHALL BE BUILT IN ACCORDANCE WITH THE RESIDENT'S SPECIFICATIONS. SIDEWALK SHALL BE ACCESSIBLE PUBLIC RIGHTS-OF-WAY (NOVEMBER 21, 2005). AND SIDEWALK SHALL BE INSTALLED BETWEEN DRIVEWAY APPROACH WITH OR BELOW ELEVATION OF DRIVEWAY.
 4. CURB CURB OR INTEGRAL CURB DETAILS SEE STANDARD DRAWING NO. 720-150-00.
 5. ALL CURB SHALL BE 12" HIGH UNLESS NOTED OTHERWISE.
 6. CONCRETE CURB SHALL BE 12" HIGH UNLESS NOTED OTHERWISE.
 7. PROVIDE CONCRETE SIDEWALK 12" UNIFORM.

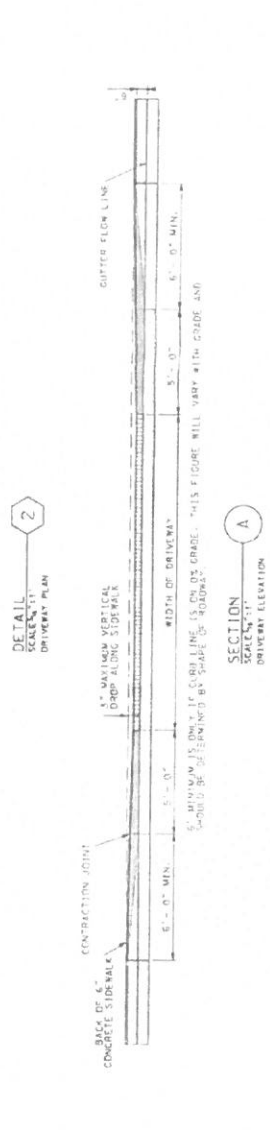
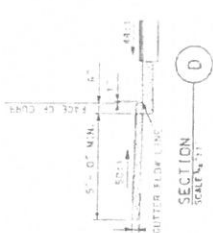
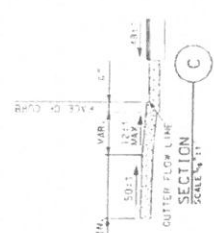
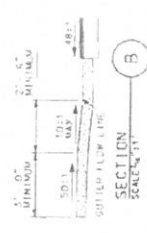
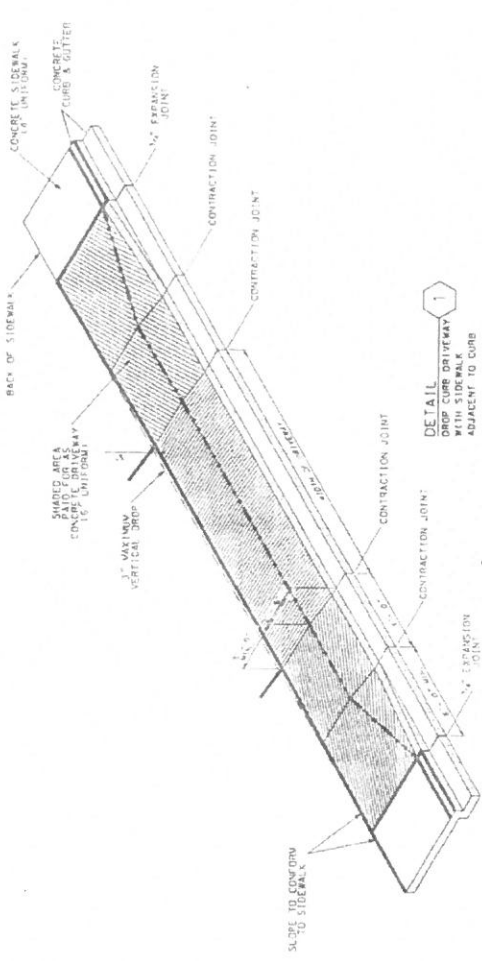

REFERENCES
 NATIONAL SPECIFICATIONS FOR HIGHWAY CONSTRUCTION, SECTION 201-45
 PUBLIC ROADS ACT, CHAPTER 23, 1990

SECTION 201-45
 DRIVEWAYS WITH SEPARATED SIDEWALKS WITHIN 7'-4 1/2" OF CURB

PRECONSTRUCTION
 SUPPORT ENGINEER
 SOUTH CAROLINA REGISTERED PROFESSIONAL ENGINEER
 NO. 8858
 EDWIN SYLVESTER ENBLETT

DATE: JULY 20, 2005
 DIT

1	DATE	DESCRIPTION
2	7/20/05	GREEN REVISED
3	7/20/05	GREEN REVISED
4	7/20/05	GREEN REVISED
5	7/20/05	GREEN REVISED

SCDOT
 DESIGN STANDARDS OFFICE
 955 PARK STREET
 COLUMBIA, SC 29201

STANDARD DRAWING
 DRIVEWAY WITH SEPARATED SIDEWALK WITHIN 7'-4 1/2" OF CURB

720-410-00
 (REVISED) FEBRUARY 2005

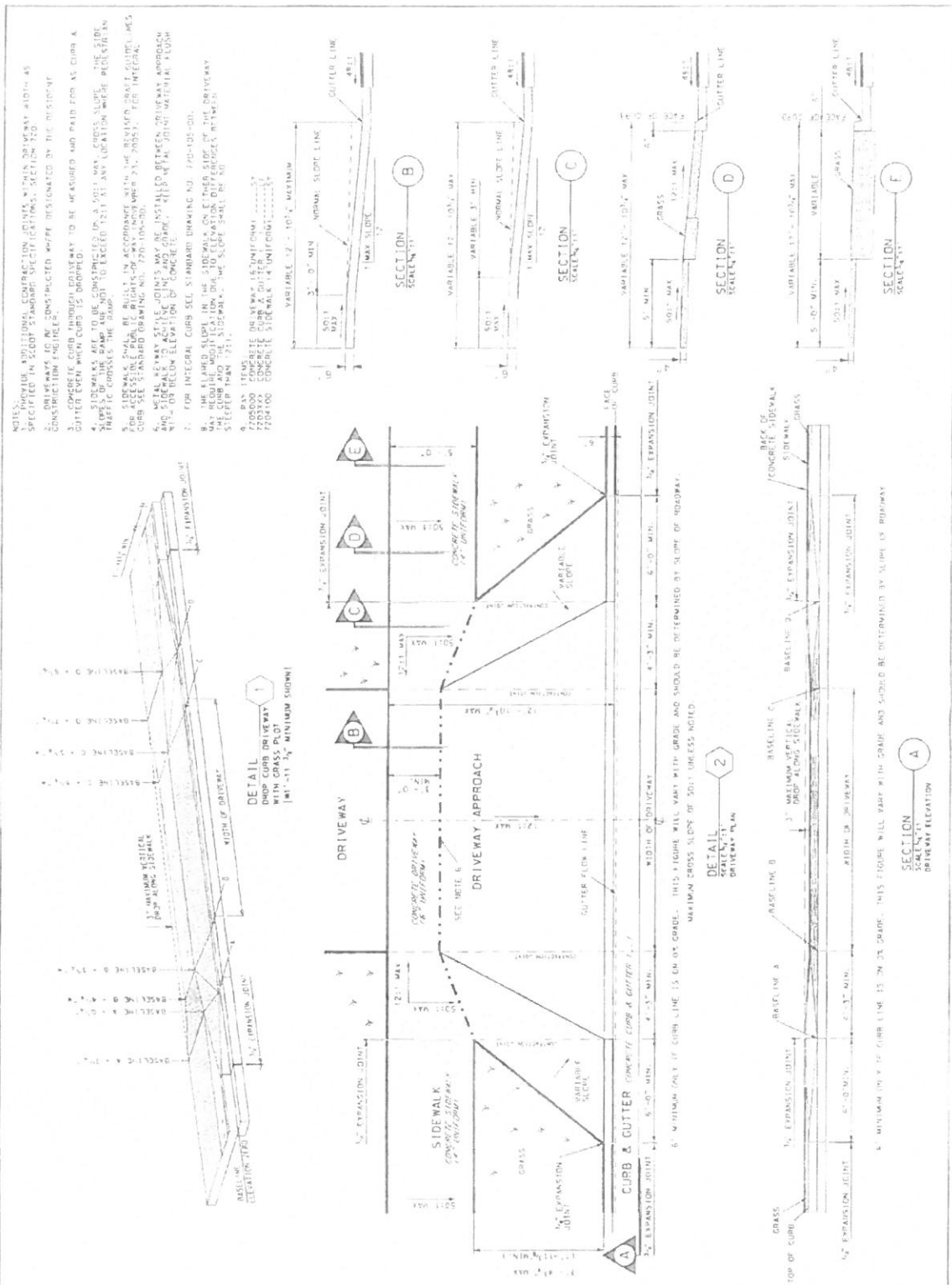

- NOTES:
1. MATERIALS, PORTLAND CEMENT CONCRETE MIXTURES, AND FINISHES SHALL BE AS SPECIFIED IN SCDOT STANDARD SPECIFICATIONS, SECTION 201-45.
 2. DRIVEWAYS TO BE CONSTRUCTED WHERE DESIGNATED BY THE RECEIVING CONSTRUCTION ENGINEER.
 3. CONCRETE CURB THROUGH DRIVEWAY TO BE MEASURED AND PAID FOR AS CURB & GUTTER EVEN WHEN CURB IS BROADENED.
 4. SIDEWALKS ARE TO BE CONSTRUCTED UP A 30:1 MAX. CROSS-SLOPE. THE SIDE GUTTER SHALL BE LOCATED 12" AT ANY LOCATION WHERE PEDESTRIAN TRAFFIC CROSSES THE DRIVEWAY.
 5. SIDEWALK SHALL BE BUILT IN ACCORDANCE WITH THE REVISIONS TO THE SIDEWALK CURB SECTION OF THE SCDOT STANDARD SPECIFICATIONS, CHAPTER 23, 1990. FOR INTEGRAL AND SIDEWALK TO ADJACENT DRIVEWAY, METAL REINFORCING BARS SHALL BE INSTALLED BETWEEN DRIVEWAY AND SIDEWALK TO ACHIEVE LINE AND GRADE WITH JOINT MATERIAL ROOM WITH OR BELOW ELEVATION OF CONCRETE.
 6. FOR INTEGRAL CURB SEE STANDARD DRAWING NO. 720-105-00.
 7. THE SLANTED SLOPE IN THE SIDEWALK ON EITHER SIDE OF THE DRIVEWAY SHALL BE 30:1 MAX. CROSS-SLOPE. THE SLOPE SHALL BE 30:1 MAX. CROSS-SLOPE. THE SLOPE SHALL BE 30:1 MAX. CROSS-SLOPE.
 8. ITEMS IN THIS DRAWING ARE TO BE CONSTRUCTED IN ACCORDANCE WITH THE STANDARD SPECIFICATIONS FOR CONCRETE CURB & GUTTER, SECTION 201-45 OF THE SCDOT STANDARD SPECIFICATIONS, CHAPTER 23, 1990.
 9. CONCRETE SIDEWALK SHALL BE 14" UNIFORM.
 10. CONCRETE SIDEWALK SHALL BE 14" UNIFORM.

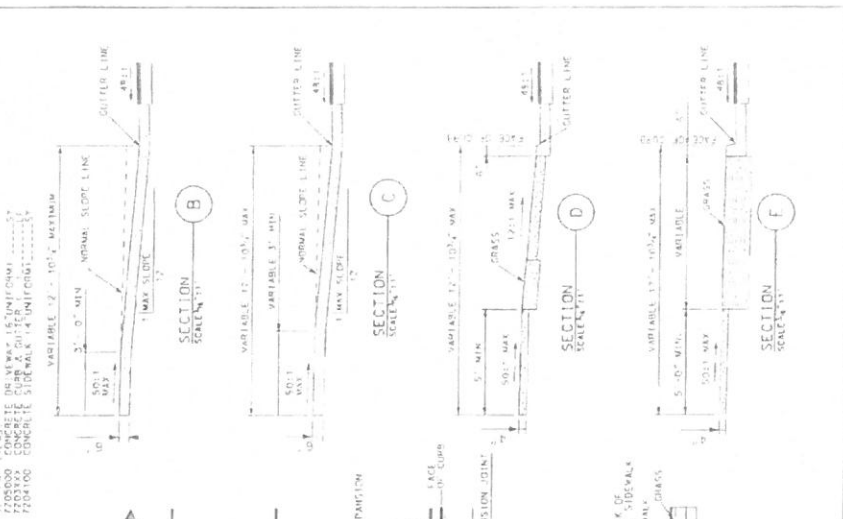

REFERENCES

NATIONAL STANDARD SPECIFICATIONS FOR HIGHWAY BRIDGES AND STRUCTURES (REVISED 2002) - SUPPLEMENT FOR ACCESSIBLE PUBLIC RIGHTS-OF-WAY (NOVEMBER 21, 2005)

SCDOT STANDARDS

SCDOT DRAWINGS

SCDOT DRAWINGS & REVIEWS

720-415-00

PRECONSTRUCTION SUPPORT ENGINEER

SOUTH CAROLINA REGISTERED PROFESSIONAL ENGINEER NO. 8958

DATE: 08/19/2008

SCDOT DESIGN STANDARDS OFFICE 955 PARK STREET ROOM 405 COLUMBIA, SC 29201

STANDARD DRAWING DRIVEWAY SEPARATED SIDEWALK BEYOND 7'-4 3/4" FROM CURB

720-415-00 EFFECTIVE DATE: 08/19/2008

- NOTES: PROVIDE ADDITIONAL CONSTRUCTION JOINTS WITH DRIVEWAY WIDTH AS SPECIFIED IN SCDOT STANDARD SPECIFICATIONS SECTION 720-415-00.
2. DRIVEWAYS TO BE CONSTRUCTED WHERE DESIGNATED BY THE RESIDENT CONSTRUCTION ENGINEER.
3. CONCRETE CURB (10" HIGH DRIVEWAY TO BE MEASURED AND PAID FOR AS CURB & GUTTER) SHALL BE CONSTRUCTED ON A 50:1 MAX. CROSS-SLOPE. THE SLOPE SHALL BE 1:1 TO 1.5:1 TO BEHIND 12" (4" MAX) LOCATION WHERE PEDESTRIAN TRAFFIC CROSSES THE DRIVEWAY.
4. SIDEWALK SHALL BE BUILT IN ACCORDANCE WITH THE REVISED "DM" CHECKLISTS FOR ACCESSIBLE PUBLIC RIGHTS-OF-WAY (NOVEMBER 23, 2005).
5. FOR INTEGRAL CURB SEE STANDARD DRAWING 720-405-00.
6. THE DRIVEWAY, IF PRESENT, MAY BE REQUIRED TO HAVE 6" CONCRETE SIDEWALK BEHIND THE CURB AND THE DRIVEWAY DUE TO ELEVATION DIFFERENCES BETWEEN THE CURB AND THE DRIVEWAY. SUCH SLOPE SHALL BE NO STEEPER THAN 2:1.
7. METAL KEYWAY SILENT JOINTS MAY BE INSTALLED BETWEEN DRIVEWAY APPROACH WITH 2" MINIMUM ELEVATION DIFFERENCE.
8. THE PAVEMENT SHALL BE: 7203000 CONCRETE CURB WITH 1/2" (1/2") 7204100 CONCRETE SIDEWALK (1" MINIMUM)

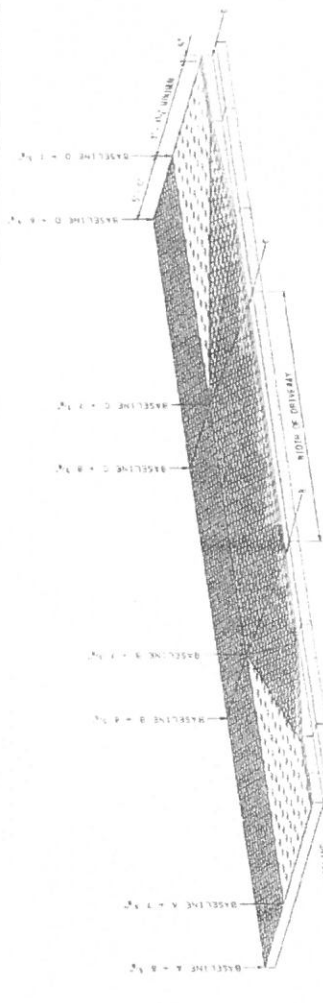

DETAIL 1
DROP CURB DRIVEWAY WITH CONCRETE CURB AND GUTTER
12' x 6' MINIMUM
1" x 6" SIDEWALK



SECTION B
SCALE: 1/4\"/>

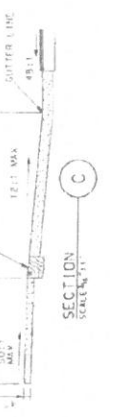

SECTION C
SCALE: 1/4\"/>



SECTION D
SCALE: 1/4\"/>

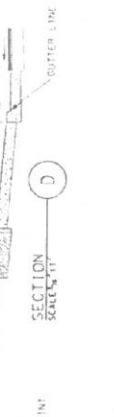

SECTION E
SCALE: 1/4\"/>

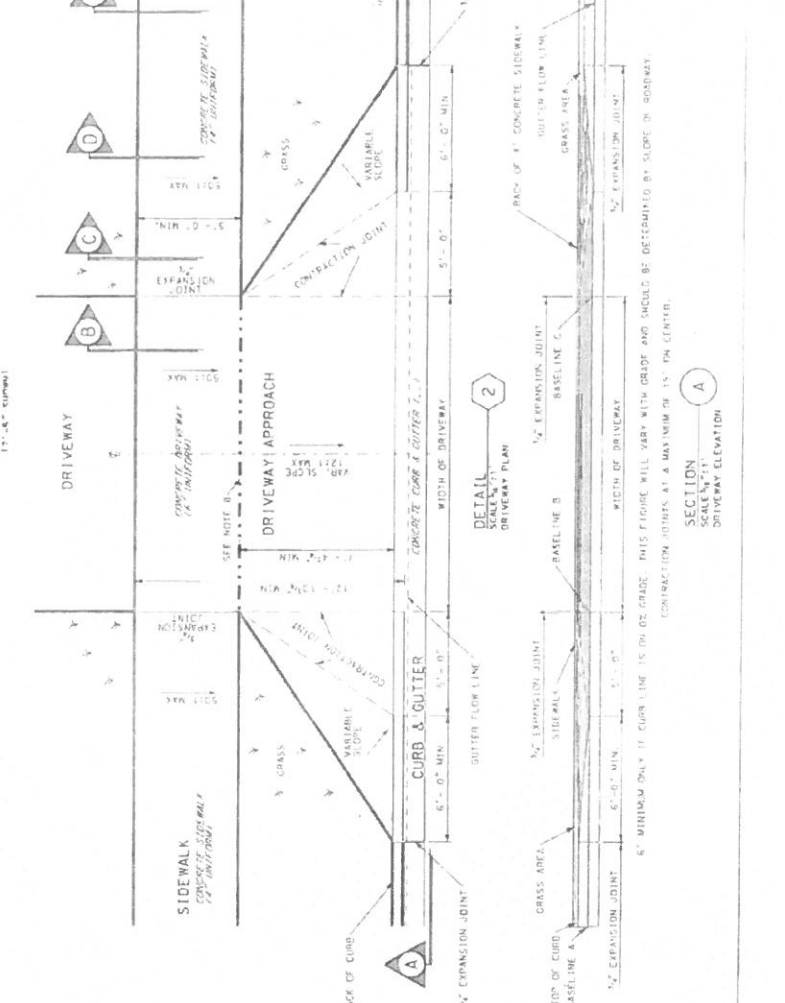

DETAIL 2
DRIVEWAY PLAN

SECTION A
SCALE: 1/4\"/>

MINIMUM ONLY IF CURB LINE IS 15" OR GREATER. THIS FIGURE WILL VARY WITH GRADE AND SHOULD BE DETERMINED BY SLOPE OR ROADWAY. CONSTRUCTION JOINTS AT A MAXIMUM OF 15' ON CENTER.